

CLAY MADDEN
MAYOR

City of Mandeville
"THE HEART OF THE OZONE BELT"



CITY COUNCIL

JASON ZUCKERMAN
COUNCIL CHAIRMAN
RICK S. DANIELSON
AT LARGE
REBECCA GOFORTH BUSH
DISTRICT I
DR. J. SKELLY KRELLER
DISTRICT II
JILL MCGUIRE
DISTRICT III

INVITATION TO BID

FENCE REPLACEMENT

Sealed Bids will be accepted until WEDNESDAY, AUGUST 3, 2022, at 11:00 A.M., CST in the office of the Purchasing Agent, City Hall, Mandeville, Louisiana, 3101 East Causeway Approach, Mandeville, LA, 70448 from dealers or firms qualified to provide FENCE REPLACEMENT resulting from damage caused by Hurricane Ida to the City of Mandeville. Bids will be opened and publicly read aloud after 11:00 A.M. in the City Council Chambers, City Hall, Mandeville, Louisiana. Any bids received after 11:00 A.M. will be returned unopened.

Interested parties may obtain the solicitation package or submit written inquiries by contacting the Purchasing Agent, 985-626-3144 ext. 202, or by emailing purchasing@cityofmandeville.com. Written inquiries must be submitted no later than Tuesday, July 26, 2022, at 2:00 P.M., CST.

There will be a non-mandatory pre-bid conference on Thursday, July 21, 2022, at 9:30 A.M. at the Mandeville Department of Public Works Building, 1100 Mandeville High Blvd, Mandeville, LA 70471. For contractors wishing to attend remotely, a meeting link will be provided via email no later than 24 hours prior to the conference.

Contractors may also view the documents and submit electronic responses at www.centralauctionhouse.com. For questions relating to the electronic submission process, please call Central Auction House at 833.412.5717 or email info@centralbidding.com.

The outside envelope in which the bid is placed must be clearly marked as follows:

Sealed Bid: FENCE REPLACEMENT

Bid Due Date and Time: Wednesday, August 3, 2022, at 11:00 A.M., CST

INCLUDE: CONTRACTOR'S NAME, ADDRESS

It is requested, but not mandatory, that the entire bid package be submitted in duplicate. Duplicate copy can be a photocopy.

All applicable laws, ordinances, and the rules and regulations of all authorities having jurisdiction over this purchase shall apply to the Contract throughout.

Clay Madden, Mayor

St Tammany Farmer: July 6, 13, 20



INVITATION TO BID

FENCE REPLACEMENT

TABLE OF CONTENTS

I. INTRODUCTION.....	5
II. BID SUBMISSION REQUIREMENTS	5
III. GENERAL CONDITIONS FOR BIDDERS	6
IV. SCOPE OF WORK: CHAIN LINK FENCING.....	9
V. SCOPE OF WORK: WOODEN FENCING	13

ATTACHMENT A: BID FORM

ATTACHMENT B: NON-COLLUSION AFFIDAVIT

ATTACHMENT C: AFFIDAVIT OF PAST CRIMINAL CONVICTIONS

ATTACHMENT D: CODE OF CONDUCT AND AFFIDAVIT

ATTACHMENT E: E-VERIFY AFFIDAVIT

ATTACHMENT F: BYRD ANTI-LOBBYING CERTIFICATION (31 U.S.C.1352)

ATTACHMENT G: SUSPENSION AND DEBARMENT CERTIFICATION BY CONTRACTOR

ATTACHMENT H: CITY OF MANDEVILLE INSURANCE REQUIREMENTS



INVITATION TO BID

FENCE REPLACEMENT

I. INTRODUCTION

The City is located on the north shore of Lake Pontchartrain. While any disaster or emergency may affect the City and its citizens, the greatest threat to the City is a hurricane. Successful response to and recovery from a hurricane involves manpower, material and various skill sets. The City is soliciting responses to this RFP from qualified firms that can meet the Scope of Work (SOW) outlined herein.

As a result of Hurricane Ida's strong winds, the City suffered damages to its infrastructure. Those damages included damages to City owned fences, chain link, wooden, and ornamental. Attachment A of this RFP outlines that statement of work required by the City to prepare all of the fences damaged by Hurricane Ida. The repair of the fences qualifies as permanent work under the FEMA Public Assistance program and as such, contractor will be required to comply with FEMA required contract clauses.¹

II. BID SUBMISSION REQUIREMENTS

The following documentation shall be completed and included in the sealed bid:

1. Bid Form (Attachment A)
2. Certification of Signing Authority: A Corporate Resolution or other written of the authority of person signing the bid is required at time of submission of bid.
3. IRS Form W-9
4. Completed and Signed City of Mandeville Affidavits (Attachments B through G)

¹ *Equal Employment Opportunity, Contract Work Hours and Safety Standards, Clean Air Act, Federal Water Pollution Control Act, Suspension and Debarment, Byrd Anti-Lobbying Act, Procurement of Recovered Materials, Prohibition on Contracting for Covered Telecommunications Equipment or Services, Domestic Preferences for Procurements, Access to Records, DHS Seal, Logo, and Flags, Compliance with Federal Executive Orders, No Obligation by the Federal Government, Program Fraud and False or Fraudulent Statements or Related Acts, Contracting with Small and Minority Businesses, Women's Business Enterprises, and Labor Surplus Area Firms, Copyright and Data Rights*



INVITATION TO BID

FENCE REPLACEMENT

5. Proof of Relevant Insurance as provided in The City of Mandeville Insurance Requirements (Attachment H)

Do not break these documents into parts or sub-parts. Each contracting entity shall be responsible for all the work related to their trades wherever it may be shown within the contract documents package.

Bid prices shall include all vendor fees and charges including delivery charges to the City of Mandeville. Bidding contractors are to provide Lump Sum pricing based on given quantities and contractor provided unit costs. Final project costs will be based on actual quantities installed on the project. Contractors need to make sure they provide all unit costs outlined on the unit cost bid form. Materials shall be quoted in the unit of measure specified. The City of Mandeville is exempt from all state and local sales taxes.

III. GENERAL CONDITIONS FOR BIDDERS

1. City of Mandeville reserves the right to revise any part of the solicitation by issuing an addendum to the ITB specification.
2. Bid Rejection – The City of Mandeville reserves the right to reject for cause any and all bids or parts of bids or accept bids most beneficial to the City.
3. Withdrawal of Bid - A bid may be withdrawn by the bidder if done by affidavit within 48 hours of bid opening, but only for patently obvious, unintentional, and substantial mechanical, clerical or mathematical errors. (LA R.S.38:2212(J)).
4. Ownership of Bid - All materials submitted in response to this request become the property of the City of Mandeville. Selection or rejection of a Bid does not affect this right.
5. Proprietary Information - Only information which is legitimate trade secrets or non-published financial data may be deemed proprietary or confidential. Any material within a Bid identified as such must be clearly marked in the Bid and shall be handled in accordance with the Louisiana Public Record Act, R.S. 44: 1-44 and applicable rules and regulations. Any Bid marked as confidential or proprietary in its entirety may be rejected without further consideration or recourse.
6. Cost of Preparing Bids - City of Mandeville is not liable for any costs incurred by vendor prior to issuance of a purchase order or entering into a contract. Costs associated with developing the Bid, preparing for oral presentations, and any other expenses incurred by the proposer are entirely the



INVITATION TO BID

FENCE REPLACEMENT

responsibility of the proposer/respondent, and shall not be reimbursed in any manner by City of Mandeville.

7. Errors and Omissions in Bid - City of Mandeville shall not be liable for any errors in Bids. City of Mandeville reserves the right to make corrections or amendments to the Solicitation due to errors identified in Bids by City of Mandeville or the proposer/respondent. City of Mandeville, at its option, has the right to request clarification or additional information from the proposer/respondents; if requested, such information shall be provided within ten (10) days of request.
8. Contract Award and Execution - Contract will be awarded to lowest responsive, responsible bidder. City of Mandeville reserves the right to enter a contract without further discussion of the Bid submitted based on the initial offer received. The specifications of solicitation and bid of the low bidder shall become part of any purchase order initiated by City of Mandeville.
9. Cancellation of contract/purchase order with cause - The City of Mandeville reserves the right to cancel any contract, in accordance with Purchasing Policy, rules and regulation, for cause, including, but not limited to the following:
 - a. Failure to deliver within the time specified on the bid form;
 - b. Failure of the product or service to meet specifications, conform to sample quality or to be delivered in good condition;
 - c. Misrepresentation by the vendor or contractor.
 - d. Fraud, collusion, conspiracy, or other unlawful means of obtaining any contract with the City of Mandeville; e) Conflict of contract provisions with constitutional or statutory provisions of State or Federal law; f) Any other breach of contract.
10. Payment terms - Payment will be made with 30 days after receipt of properly executed invoice for receipt of materials.
11. All portions of the Bid package specifications shall become part of the contract.
12. Materials shall conform in quality to the accepted standard of industry and as listed in the Technical Specifications. The materials provided shall meet or exceed all federal and state standard requirements of quality.
13. Bidders are not to exclude from participation in, deny the benefits of, or subject to discrimination under any program or activity, any person in the United States on the grounds of race, color, national origin, or sex; nor discriminate on the basis of age under the Age Discrimination Act of 1975, or with respect to an otherwise qualified handicapped individual as provided in Section 504



INVITATION TO BID

FENCE REPLACEMENT

of the Rehabilitation Act of 1973, or on the basis of religion, except that any exemption from such prohibition against discrimination on the basis of religion as provided in the Civil Rights Act of 1964, or Title Vi and VII of the Act of April 11, 1968, shall also apply. This assurance includes compliance with the administrative requirements of the Revenue Sharing final handicapped discrimination provisions contained in Section 51.55 (c), (d), (e), and (k)(5) of the Regulations. New construction or renovation projects must comply with Section 504 of the 1973 Rehabilitation Act, as amended, in accordance with the American National Standard Institute's specifications (ANSI A17.1-1961).

14. Pursuant to LA R.S. 38:2212.1.C (1) (2). Any manufacturer's preference in this bid is descriptive, but non-restrictive, and is used only to indicate minimum requirement for type, grade and quality unless otherwise specified. Bids for products considered functionally equivalent will be considered provided brand names and stock numbers are specified. Complete product data may be required prior to award. Upon review of bids, proposed equipment may be accepted if it is determined to be equal to or exceeding minimum stated specifications.
15. Pursuant to LA R.S. 38:2212 B (1), the provisions and requirement of this bid shall not be considered as informalities and shall not be waived by the City of Mandeville. Therefore, conditions and specifications of the bid shall be strictly enforced and any and all alterations, deviations, and non-compliance to said conditions and specifications, either on the bid form or by separate attachment, shall be grounds for immediate disqualification.
16. In case of mathematical discrepancy between unit price and extensions, the unit price shall prevail.
17. All erasures or corrections on the bid form must be initialed and the City of Mandeville may rely on the apparent authority represented by the initials.
18. Quantities listed are for bidding purposes only. Actual requirements may be more or less than quantities listed.
19. Bidder(s) awarded item(s) by the City of Mandeville shall be responsible for supplying all products at the awarded price(s). Failure may result in the City's cancellation of the remaining items awarded.

-END: GENERAL CONDITIONS FOR BIDDERS-



INVITATION TO BID

FENCE REPLACEMENT

IV. SCOPE OF WORK: CHAIN LINK FENCING

1. GENERAL SPECIFICATIONS: CHAIN LINK FENCING

The intent of this Scope of Work is to provide construction services for the removal and replacement of the existing fencing located at various sites in the City of Mandeville. This will summarize the fence framework, fabric, accessories, excavation for post bases, concrete foundation for posts, center drop for gates, manual gates, and related hardware. Construct fences and gates in accordance with these specifications and in conformity with lines and grades shown on the scope of work or established by the engineer.

The scope of the work for contractors, subcontractors, material suppliers, etc., cannot be determined by examining partial sets of documents. The entire set of drawings and specifications must be reviewed to ascertain the scope of work for each project element.

1.01 REFERENCES

- A. ASTM A123 - Zinc (Hot Dip Galvanized) Coatings on Iron and Steel Products.
- B. ASTM A153 - Zinc Coating (Hot-Dip) on Iron and Steel Hardware.
- C. ASTM A392 - Zinc-Coated Steel Chain-Link Fence Fabric.
- D. ASTM A824 - Metallic Coated Steel Marcellled Tension Wire for Use with Chain Link Fence.
- E. ASTM C94 - Ready-mixed Concrete.
- F. ASTM F567 - Practice for Installation of Chain-Link Fence.
- G. ASTM F900 - Industrial and Commercial Swing Gates.
- H. ASTM F1083 - Pipe, Steel, Hot-Dipped Zinc-Coated (Galvanized) Welded, for Fence Structures.
- I. ASTM A121 – Steel Barbed Wire
- J. ASTM A116 – Woven Wire
- K. CLFMI (Chain Link Fence Manufacturers Institute) - Product Manual.
- L. ASTM F1184 – Slide Gates
- M. ASTM F900 – Swing Gates
- N. ASTM F626 – Fence Fittings

1.02 GENERAL CONSTRUCTION REQUIRMENTS

Conform to Section 201 of the Louisiana Standard Specification for Roads and Bridges, 2016 Edition or latest edition when clearing and grubbing for fence installation. Demolish and remove existing damaged fencing only to extent required, and as indicated in contract documents. Confine operations to the area adjacent to the right-of-way lines and within the right-of-way. When posts, braces, or anchors are to be embedded in concrete, install temporary bracing as required to hold posts in proper position until concrete has set



INVITATION TO BID

FENCE REPLACEMENT

sufficiently to hold post. Do not install fencing material on posts or place strain on bracing set within concrete for 72 hours after concrete has been placed. Set tops of posts to required grade and alignment.

1.03 SYSTEM DESCRIPTION

- A. The contractor shall supply a total galvanized chain link fence system of the design, style and strength defined herein. The system shall include all components (i.e., framework, chain link fabric, gates, and fittings) required.
- B. Fence Height: to match existing as noted on scope of work.
- C. Line Post Spacing: At intervals not exceeding 10 feet.
- D. Fence Post and Rail Strength: Conform to ASTM F1043 Heavy Industrial Fence quality.

1.04 SUBMITTALS

- A. Shop Drawings: Indicate plan layout, spacing of components, post foundation dimensions, hardware anchorage, gates, and schedule of components.
- B. Product Data: Submit data on fabric, posts, accessories, fittings, and hardware.
- C. The manufacturer's literature shall be submitted and reviewed prior to installation.

1.05 QUALITY ASSURANCE

- A. The contractor shall provide laborers and supervisors who are thoroughly familiar with the type of construction involved and materials and techniques specified.
- B. Supply material in accordance with CLFMI - Product Manual.
- C. Perform installation in accordance with ASTM F567.

1.06 QUALIFICATIONS

Manufacturer: Company specializing in manufacturing Products specified in this section with minimum three years' experience.

1.07 DELIVERY, STORAGE AND HANDLING

Upon receipt at the job site, all materials shall be checked to ensure that no damages occurred during shipping or handling. Materials shall be stored in such a manner to ensure proper ventilation and drainage and to protect against damage, weather, vandalism, and theft.

2. MATERIALS: CHAIN LINK FENCING

2.01 STEEL FRAMEWORK



INVITATION TO BID

FENCE REPLACEMENT

ASTM F1083 Schedule 40 galvanized steel pipe, welded construction, minimum yield strength of 25 ksi; coating conforming to ASTM F1043 Type A on pipe exterior and interior.

2.02 FENCE FABRIC

- A.** Fabric shall be hot dipped galvanized with a minimum zinc coating weight per ASTM A392 and specified as the following: Class II - The weight of the zinc coating shall not be less than 2.0 oz./ft² [610 g/m²] of uncoated wire surface on fabric coated after weaving, the weight of zinc coating shall not be less than 2.0 oz./ft² [610 g/m²] of uncoated wire surface as determined from the average of two or more specimens, and not less than 1.8 oz./ft² [500g/m²] of uncoated wire surface for any individual specimen.
- B. WIRE SIZE:** The finished wire size shall be **9** gauge.
- C. HEIGHT AND MESH SIZE:** The fabric height shall be height as noted in scope of work per location with a mesh size matching existing per location.
- D. SELVAGE:** Top edge shall match existing per location and bottom edge shall match existing per location.

2.03 FENCE FITTINGS

The material for fence fittings shall be manufactured to meet the requirements of ASTM F626 and ASTM A153.

2.04 CONCRETE

ASTM C94; Normal Portland Cement, 3,000psi strength at 28 days, 3-inch slump; nominal sized coarse aggregate.

2.05 BARBED WIRE

Galvanized steel 12 ½ gage or match existing per location.

2.06 GATES

Swing gates shall be manufactured and coated to meet the requirements of ASTM F900. Slide gates shall be manufactured to meet the requirements of ASTM F1184.

1. General

- A.** Gate Types, Opening Widths and Directions of Operation: As indicated on scope of work.
- B.** Factory assembled gates.



INVITATION TO BID

FENCE REPLACEMENT

- C. Design gates for operation by one person.
- D. Gates shall be of ridged construction, and after erection, gates shall not show any sag or warp.
- E. Provide Heavy Industrial Fence quality hardware for proper operation per location.

2. *Swing Gates*

- A. Fabricate gates to permit 180-degree swing.
- B. Gates Construction: ASTM F900 with welded corners. Use of corner fittings is not permitted.

3. EXECUTION: CHAIN LINK FENCING

3.01 INSTALLATION

Install chain link fence in accordance with ASTM F567. Fence posts shall be set at spacings of a maximum of 10' o.c. Gate posts shall be spaced according to the gate openings specified in the construction plans. Install fabric on security side and attach with wire ties or clip to line posts at 15 inches o.c. and to rails, braces, and tension wire at 24 inches o.c. For concrete footings, extend tops of footings slightly above ground and steel trowel to a smooth finish sloped to drain away from posts. Center posts, braces, and other units in footings.

3.02 ERECTING TOLERANCES

- 1. Maximum Variation from Plumb: 1/4 inch.
- 2. Maximum Offset from Indicated Position: 1 inch.
- 3. Minimum distance from property line: 6 inches.

3.03 CLEANING

The contractor shall clean the jobsite of excess materials. Post hole excavations shall be scattered uniformly away from posts.

4. MEASUREMENT: CHAIN LINK FENCING

4.01 NEW FENCE

New Fence will be measure by the linear foot between outside of end posts for each continuous run of fence, exclusive of gates. *Gates* for new fences will be measured per each for single swinging gates and per double gate for double swinging gates.

4.02 REPAIRED



INVITATION TO BID

FENCE REPLACEMENT

Repaired fences will be measured by the linear foot between outside of end posts for each continuous run of fences, including gates.

4.03 SECTIONS

Sections of new fences required for connections of existing intersecting fences to new or rebuilt fences will be included in the measurement of the new or rebuilt fences.

5. PAYMENTS: CHAIN LINK FENCING

5.01 FENCING PAYMENT

Payment for fences and gates will be made at the contract unit prices, which will include all labor, materials, tools, equipment, and incidentals, including hardware necessary to complete the work. In addition, the contractor is responsible for providing Invoices unitized according to FEMA eligibility categories.

5.02 PAY ITEM

Type A-1 : Replace 6 ft. height Chain Link fencing with 3 stranded barbed wire	Linear Foot
Type A-2 : Repair 6 ft. height Chain Link fencing with 3 stranded barbed wire	Linear Foot
Type A-3 : Replace 6 ft. height Chain Link fencing	Linear Foot
Type A-4 : Replace 5 ft. height Chain Link fencing	Linear Foot
Type A-5 : Repair 5 ft. height Chain Link fencing	Linear Foot
Type A-7 : Replace Barbed Wire Fence	Linear Foot
Type A-8 : Replace 25 ft. height Chain Link fencing	Linear Foot
Type A-9 : Repair 10 ft. height Chain Link Fencing	Linear Foot
Type A-10: Replace 6 ft. height Chain Link Fence with Privacy Slats	Linear Foot
Type B-1 : Repair 6 ft. height 8 ft wide pair of chain link swing gates	Each Gate Pair
Type B-2 : Replace 4 ft height 5 ft wide Chain Link Single swing gate	Single Gate
Type B-3 : Replace 4 ft height 6 ft wide pair of Chain link swing gates	Each Gate Pair

V. SCOPE OF WORK: WOODEN FENCING

1. GENERAL SPECIFICATIONS: WOODEN FENCING

The intent of this Scope of Work is to provide construction services for the demolition, removal, and replacement of the existing fencing located at various sites in the City of Mandeville. This will summarize the fence framework, fabric, accessories, excavation for post bases, concrete foundation for posts, center drop for gates, manual gates, and related hardware. Construct fences



INVITATION TO BID

FENCE REPLACEMENT

and gates in accordance with these specifications and in conformity with lines and grades shown on the scope of work or established by the engineer.

The scope of the work for contractors, subcontractors, material suppliers, etc., cannot be determined by examining partial sets of documents. The entire set of drawings and specifications must be reviewed to ascertain the scope of work for each project element.

1.01 REFERENCES.

- A.** DOTD 1010.04 – Staples and Nails
- B.** DOTD 1014.03 – Timber Preservatives
- C.** DOTD 1010.03 – Post and Braces for Fencing
- D.** DOTD 1010.05 – Metals fasteners for steel posts
- E.** DOTD 1014.01 – Structural Timber and Lumber
- F.** ASTM A123 - Zinc (Hot Dip Galvanized) Coatings on Iron and Steel Products.
- G.** ASTM A153 - Zinc Coating (Hot-Dip) on Iron and Steel Hardware.
- H.** ASTM C94 - Ready-mixed Concrete.
- I.** ASTM F1083 - Pipe, Steel, Hot-Dipped Zinc-Coated (Galvanized) Welded, for Fence Structures.

1.02 GENERAL CONSTRUCTION REQUIREMENTS.

Conform to Section 201 of the Louisiana Standard Specification for Roads and Bridges, 2016 or latest edition when clearing and grubbing for fence installation. Demolish and remove existing damaged fencing only to extent required, and as indicated in contract documents. Confine operations to the area adjacent to the right-of-way lines and within the right-of-way. When posts, braces, or anchors are to be embedded in concrete, install temporary bracing as required to hold posts in proper position until concrete has set sufficiently to hold post. Do not install fencing material on posts or place strain on bracing set within concrete for 72 hours after concrete has been placed. Set tops of posts to required grade and alignment.

1.04 SYSTEM DESCRIPTION



INVITATION TO BID

FENCE REPLACEMENT

- A.** The contractor shall supply a total wooden fence system of the design, style and strength matching existing per location. The system shall include all components (i.e., framework, Dog ear Pickets, gates, and fittings) required.
- B.** Fence Height: Matching existing as noted on scope of work.
- C.** Line Post Spacing: At intervals not exceeding 10 feet.
- D.** Fence Post and Rail Strength: Conform to Section 1014 of the Louisiana Standard Specification for Roads and Bridges, 2016 or latest edition section 1014.

1.05 SUBMITTALS

- A.** Shop Drawings: Indicate plan layout, spacing of components, post foundation dimensions, hardware anchorage, gates, and schedule of components.
- B.** Product Data: Submit data on Lumber, posts, accessories, fittings, and hardware.
- C.** The manufacturer's literature shall be submitted and reviewed prior to installation.

1.06 QUALITY ASSURANCE

- A.** The contractor shall provide laborers and supervisors who are thoroughly familiar with the type of construction involved and materials and techniques specified.
- B.** Perform installation in accordance with DOTD 705.
- C.** Inspection Shall be in accordance with AWAPA M2. Quality control shall be in accordance with AWAPA M3. Care of treated wood products shall be in accordance with AWAPA M4. Treated timber and piles to be supplied from a DOTD certified plant and inspected and stamped by DOTD Construction prior to shipment. Notify DOTD Construction prior to treatment.

1.07 QUALIFICATIONS

Manufacturer: Company specializing in manufacturing Products specified in this section with minimum three years' experience.

1.08 DELIVERY, STORAGE AND HANDLING.

Upon receipt at the job site, all materials shall be checked to ensure that no damages occurred during shipping or handling. Materials shall be stored in such a manner to ensure proper ventilation and drainage and to protect against damage, weather, vandalism, and theft.



INVITATION TO BID

FENCE REPLACEMENT

2. MATERIALS: WOODEN FENCING

2.01 FRAMING LUMBER.

The fencing board type shall be cedar.

Conform to Section 1014.0 of the Louisiana Standard Specification for Roads and Bridges, 2016 or latest edition - Structural timber and lumber shall be qualified products as determined by the Construction Fabrication Unit. For species and grade of structural timber and lumber comply with AASHTO M 168.

2.02 CONCRETE.

ASTM C94; Normal Portland Cement, 3,000 psi strength at 28 days, 3-inch slump; nominal sized coarse aggregate.

2.03 TIMBER CONNECTORS.

Connectors for treated timber structures, except those of malleable iron, shall be galvanized in accordance with ASTM A123.

2.04 STAPLES AND NAILS.

Nails shall be made of galvanized steel wire.

2.05 GATES

Gates shall be manufactured and coated to meet the requirements of the Louisiana Standard Specification for Roads and Bridges, 2016 or latest edition Section 705.05.

1. General

- A. Gate Types, Opening Widths and Directions of Operation: As indicated on scope of work.
- B. Factory assembled gates.
- C. Design gates for operation by one person.
- D. Gates shall be of ridged construction, and after erection, gates shall not show any sag or warp.

2. Swing Gates



INVITATION TO BID

FENCE REPLACEMENT

- A. Fabricate gates to permit 180-degree swing.
- B. Gates Construction: ASTM F900 with welded corners. Use of corner fittings is not permitted.

2.06 COMPONENTS

All lumber shall meet the requirements of the Louisiana Standard Specification for Roads and Bridges, 2016 or latest edition Section 1010.03 Treated Timber Post and Braces.

- A. Line Posts: 4"x4"x required height match existing
- B. Corner and Terminal Posts: 4"x4"x required height to match existing
- C. Stringers: 2"x4"x length required to match existing
- D. Dog ear Pickett: 1"x6"x height required to match existing and pressured treated when being replaced.
- E. Gate Posts: Galvanized steel matching existing.
- F. Gate Top and Brace Rail: diameter matching existing, plain end, sleeve coupled; galvanized steel.
- G. Gate Frame: diameter matching existing for welded fittings and truss rod fabrication; galvanized steel.

2.07 ACCESSORIES

- A. Caps: Malleable iron galvanized sized to post diameter, set screw retainer.
- B. Fittings: Sleeves, bands, clips, rail ends, tension bars, fasteners, and fittings; galvanized steel.
- C. Gate Hardware: Single and double gate latches w/ hardware for padlock; two 180-degree gate hinges for each leaf and center drop. Provide Heavy Industrial Fence quality hardware for proper operation per location.

3. EXECUTION: WOODEN FENCING

3.01 INSTALLATION



INVITATION TO BID

FENCE REPLACEMENT

Install wooden fence in accordance Louisiana Standard Specification for Roads and Bridges, 2016 or latest edition section 705. Fence posts shall be set at spacings of a maximum of 10' o.c. Gate posts shall be spaced according to the gate openings specified in the construction plans. For concrete footings, Extend tops of footings slightly above ground and steel trowel to a smooth finish sloped to drain away from posts. Center posts, braces, and other units in footings.

3.02 ERECTING TOLERANCES

- A.** Maximum Variation from Plumb: 1/4 inch.
- B.** Maximum Offset from Indicated Position: 1 inch.
- C.** Minimum distance from property line: 6 inches.

3.03 CLEANING

The contractor shall clean the jobsite of excess materials. Post hole excavations shall be scattered uniformly away from posts.

4. MEASUREMENT: WOODEN FENCING

4.01 NEW FENCE

New Fence will be measure by the linear foot between outside of end posts for each continuous run of fence, exclusive of gates. *Gates* for new fences will be measured per each for single swinging gates and per double gate for double swinging gates.

4.02 REPAIRED.

Repaired fences will be measured by the linear foot between outside of end posts for each continuous run of fences, including gates.

4.03 SECTIONS.

Sections of new fences required for connections of existing intersecting fences to new or rebuilt fences will be included in the measurement of the new or rebuilt fences.

5. PAYMENTS: WOODEN FENCING

5.01 FENCING PAYMENT



INVITATION TO BID

FENCE REPLACEMENT

Payment for fences and gates will be made at the contract unit prices, which will include all labor, materials, tools, equipment, and incidentals, including hardware necessary to complete the work. In addition, the contractor is responsible for providing Invoices unitized according to FEMA eligibility categories.

5.02 PAY ITEM.

Type C-1 : Replace 6 ft. height Wooden Fencing	Linear Foot
Type C-2 : Repair 6 ft. height Wooden Fencing	Linear Foot
Type C-4 : Replace 8 ft. height Wooden Fencing	Linear Foot
Type D-1 : Replace Farm Style Fencing	Linear Foot
Type D-2 : Repair Farm Style Fencing	Linear Foot
Type E-1 : Replace 6 ft. height 8 ft wide Pair of swing gates with Galvanized steel framing and Privacy Mesh	Each Gate Pair
Type E-2 : Repair 6 ft. height 8 ft wide Pair of Wooden Swing Gates with Galvanized steel framing	Each Gate Pair
Type E-4 : Repair 8 ft. height 8 ft wide Pair of Wooden Swing Gates with Galvanized steel framing	Each Gate Pair
Type G-1 : Replace 4 ft. height 6 ft. wide Pair of Farm Style Swing Gates	Each Gate Pair

Item	Location	FEMA Category	Chain Link Fence (LF)	Chain Link Gate (Single or Double)	Barbed Wire (LF)	Wooden Fence (LF)	Wooden Gate (Single or Double)	Ornamental Fence	Ornamental Gate (Single or Double)
Ravine Au Coquille	30.360516, -90.074308 Lafayette St. between Monroe & Jefferson	D	Type A-4 : 160 LF	X	X	X	X	X	X
Paul Spitzfaden Community Center	30.371628,-90.078026 3090 E. Causeway Approach	E	X	X	X	Type C-2 : 190 LF	Type E-1: (1)	X	X
Old Mandeville Jail, Lean- to Garage	30.356369, -90.065211 1927-1928 Madison St.	E	Type A-5 : 280 LF	X	X	Type C-4 : 150 LF	X	X	X
Public Works Building	30.376924,-90.099723 1100 Mandeville High Blvd.	E	Type A-1 : 20 LF	X	Type A-7 : 200 LF	X	X	X	X
Public Works Maintenance Garage	30.376924,-90.099723 1100 Mandeville High Blvd.	E	Type A-3 : 160 LF	X	X	X	X	X	X
Lift Station 4	30.35206,-90.06263 218 Foy St.	F	X	X	X	Type C-4 : 75 LF	Type E-4 : (1)	X	X
Lift Station 44	30.38013,-90.10952 23 Pintail Trace	F	X	X	X	Type C-1 : 75 LF	Type E-2 : (1)	X	X
Lift Station 37	30.38866,-90.11242 #11 Cardinal Ln. (Sanctuary) End of the	F	X	X	X	Type C-4 : 90 LF	Type E-4 : (1)	X	X
WW 2	30.368663,-90.086884 3350 Monroe St.	F	X	Type B-1 : (1)	Type A-7 : 400 LF	X	X	X	X
WW - St. Ann	30.389084,-90.088045 Tower and Pump Station @1461 N. Causeway & St.	F	Type A-1 : 170 LF Type A-2 : 140 LF	Type B-1 : (1)	Type A-7 : 30 LF	X	X	X	X
Paul D. Cordes Park	30.37621,-90.078473 3101 E. Causeway Approach	G	Type A-9 : 75 LF	X	X	Type C-1 : 80 LF	X	X	X
Mandeville Lakefront Splash Park	30.349054,-90.060665 1517-1547 Lakeshore Dr.	G	X	X	X	X	X	Type F-2 : 700 LF Type F-2A: 700LF	X
Sunset Point	30.361131,-90.085617 Massena St. @ Lake Pontchartrain.	G	X	X	X	Type D-1 : 320 LF Type D-2 : 30 LF	Type G-1 : (2)	X	Type F-1 : (1) Type F-1A: (1)
Mandeville Cemetary	30.358296,-90.05687 Montgomery St. near Foy St.	G	Type A-4 : 500 LF	Type B-1 : (1)	X	X	X	X	X
Harbor Field	30.350154,-90.059618 Jackson Ave @ Claiborne St.	G	Type A-4 : 100 LF Type A-3 : 50 LF Type A-8 : 60 LF	Type B-3 : (1) Type B-2 : (1)	X	X	X	X	X

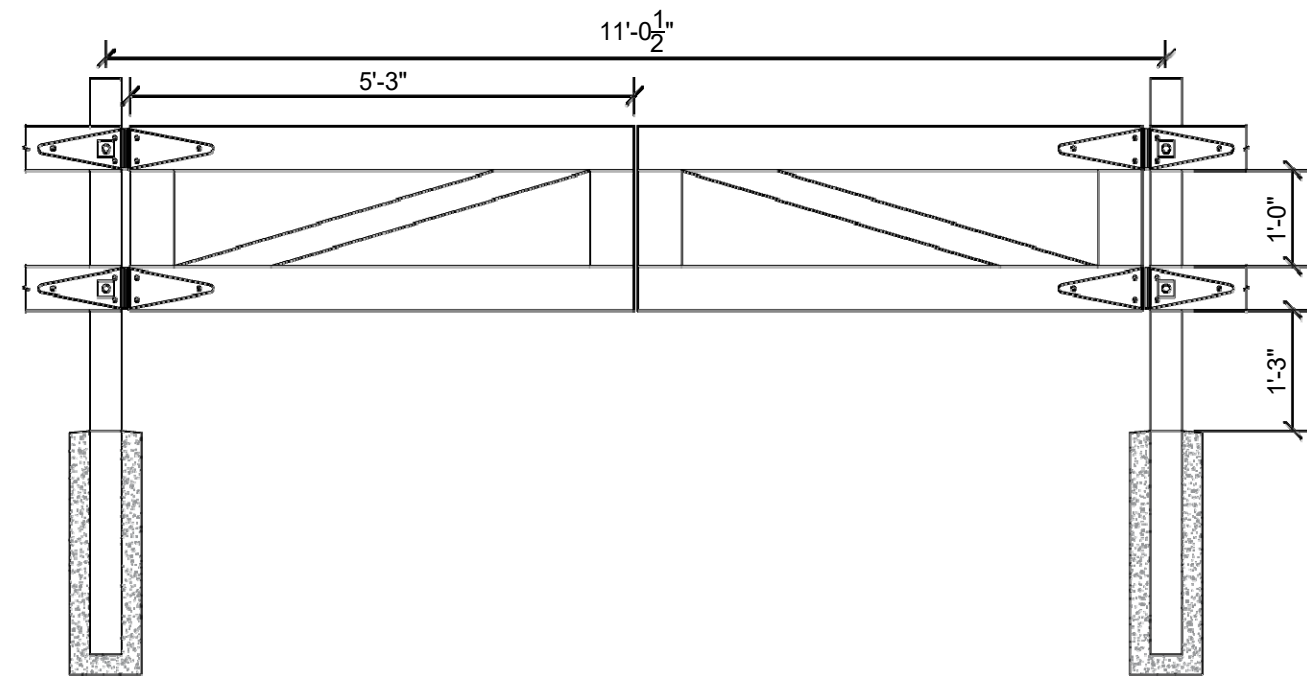
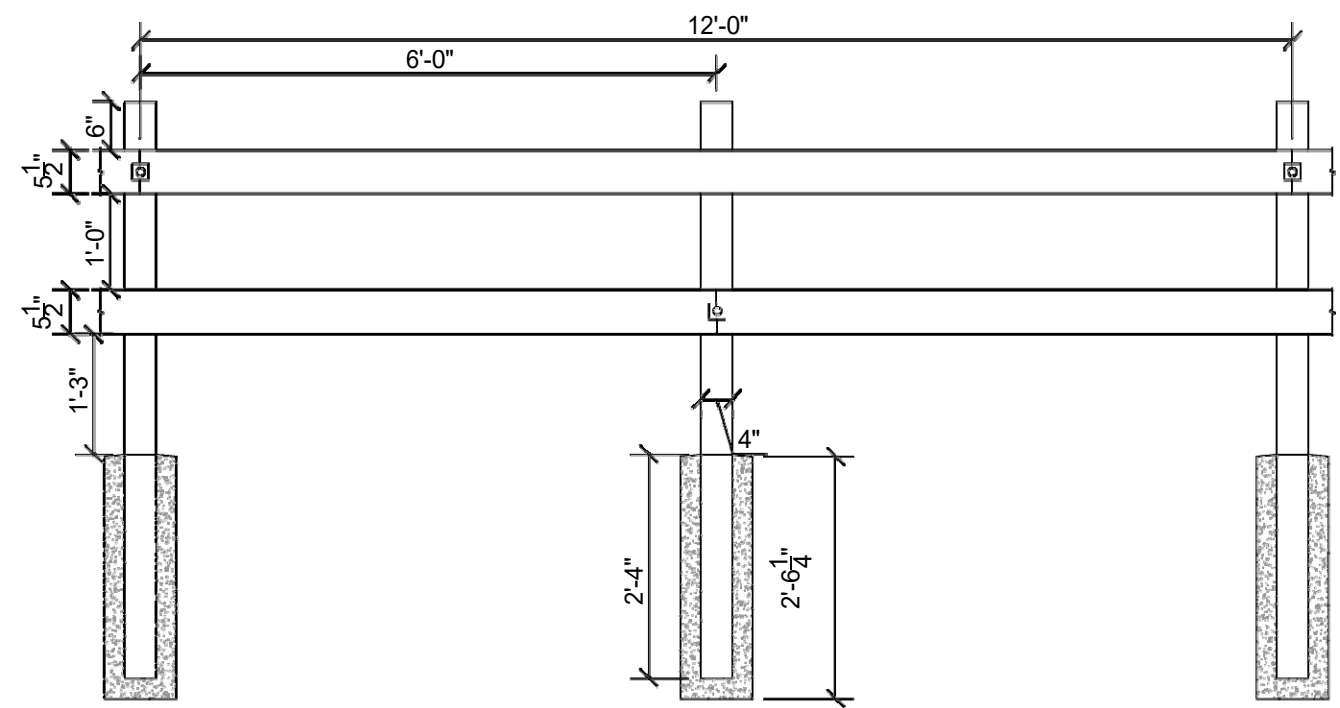

1 Farm Style Fence Panel

A1.02 1/2"=1'-0"
Farm style Fencing and Gate shall be constructed to match existing. All materials shall match existing.

2 Farm Style Double Swing Gate

A1.02 1/2"=1'-0"

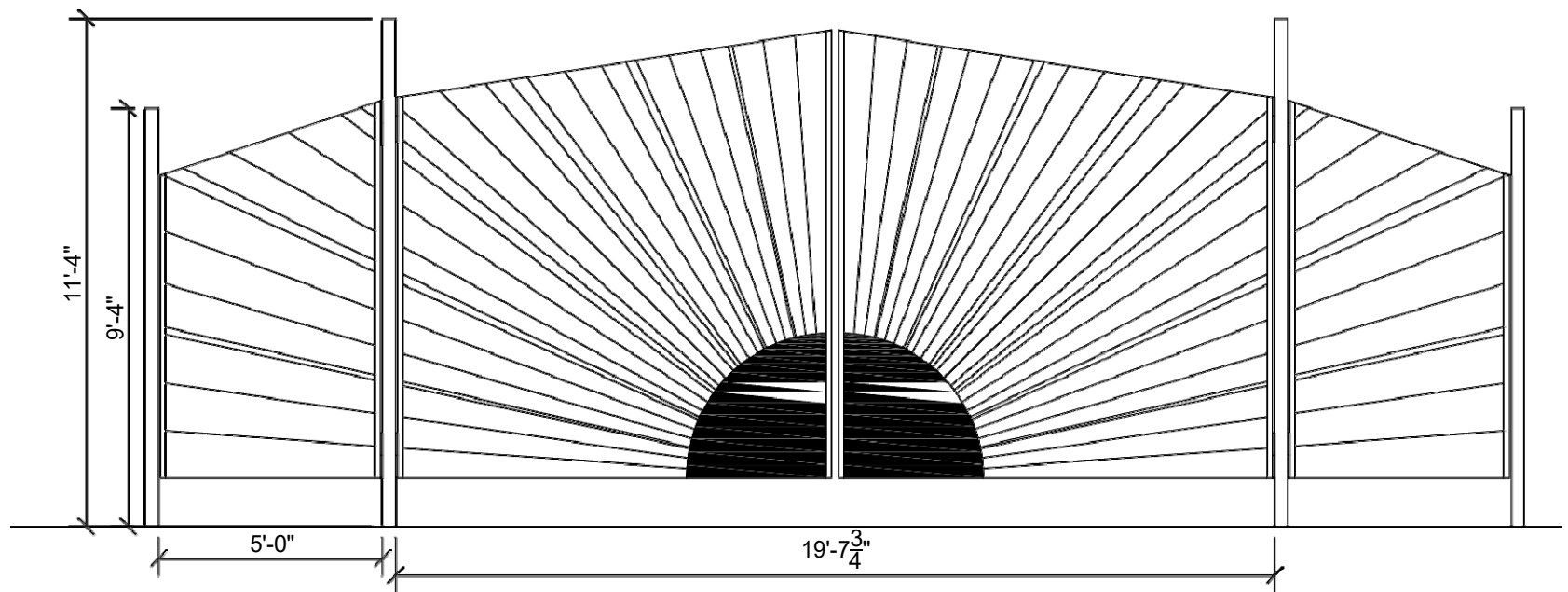

3 Ornamental Double Swing Gate

A1.02 1/4"=1'-0"
Ornamental Gate shall be constructed to match existing. All materials shall match existing.

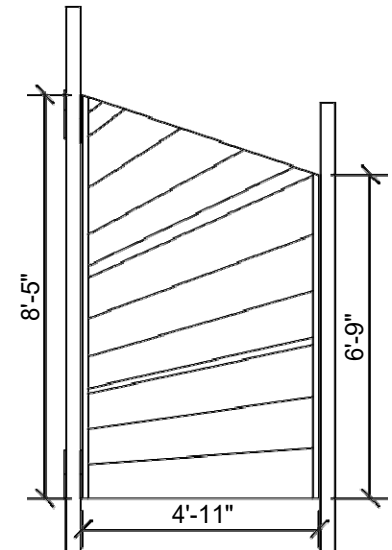

4 Ornamental Single Swing Gate

A1.02 1/4"=1'-0"

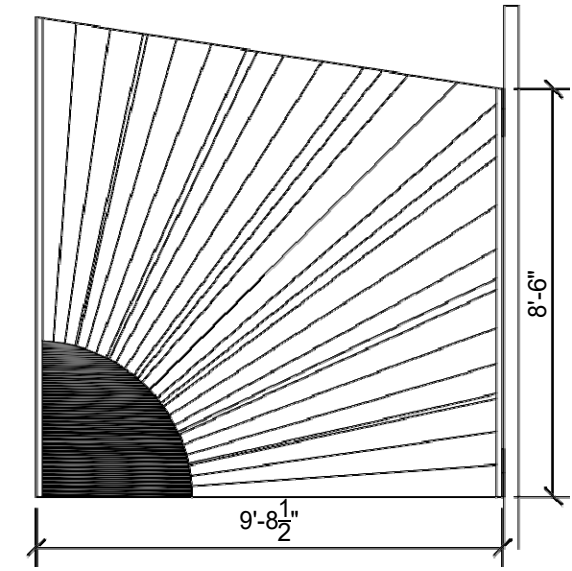

5 Ornamental Single Swing Gate

A1.02 1/4"=1'-0"

DESIGNED	CHECKED	DATE	BY
DFD	DFD	07/17/2018	
CHECKED	DFD		
DATE			
BY			

MANDENVILLE HURRICANE IDA DAMAGES
FENCING REPLACEMENT TYPES & DETAILS
MANDENVILLE EMERGENCY MANAGEMENT

Project Number:
RCLC No: 721-09

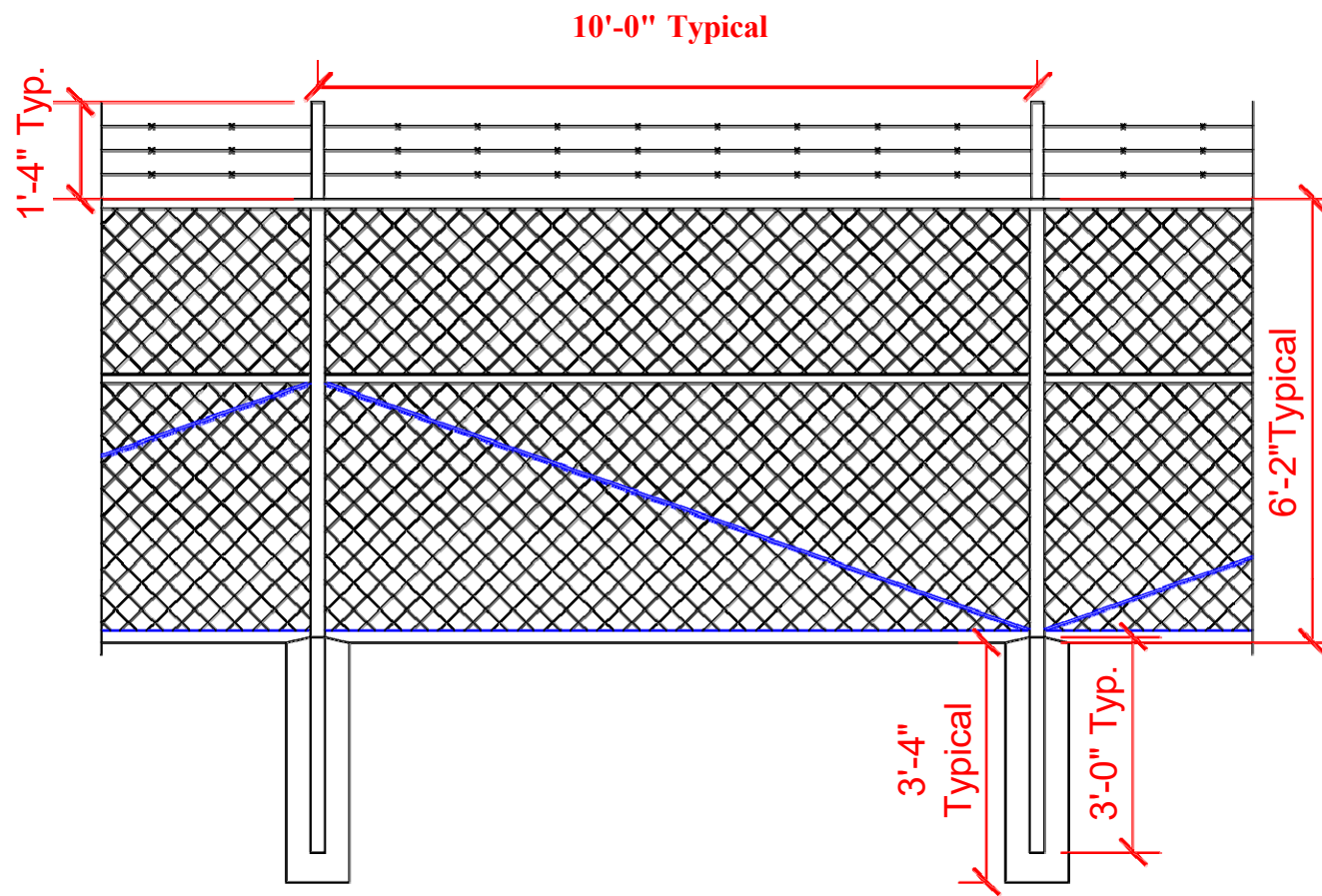

1 Chain Link - Barbed Wire Fence
A1.04 3/4"=1'-0"

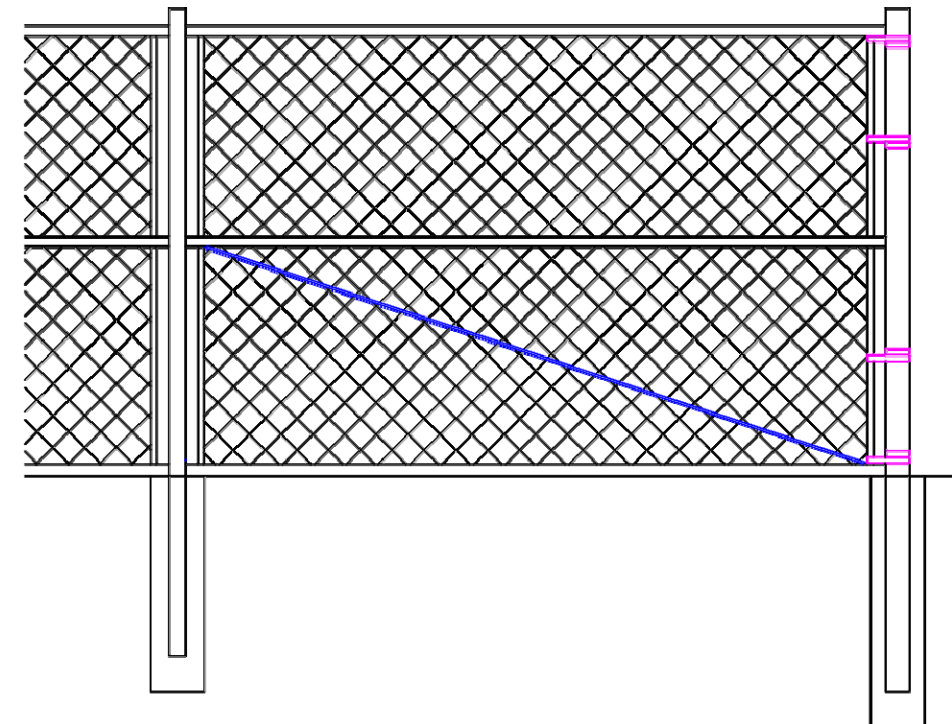

2 Chain Link Fence Panel
A1.04 3/4"=1'-0"

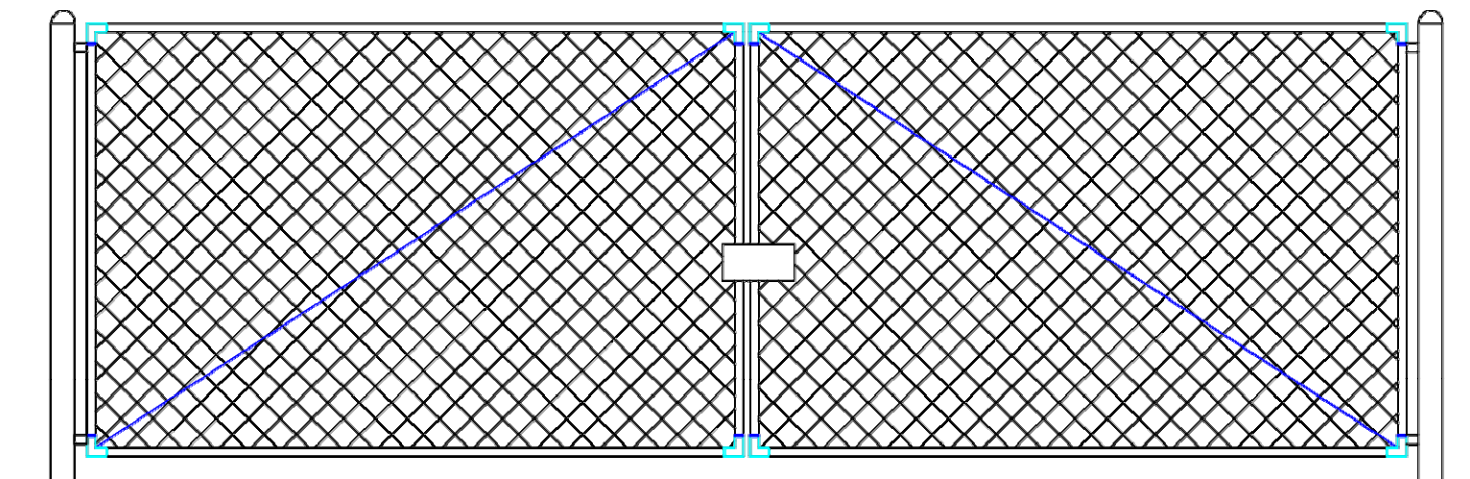

3 Double Swinging Chain Link Gate
A1.04 3/4"=1'-0"

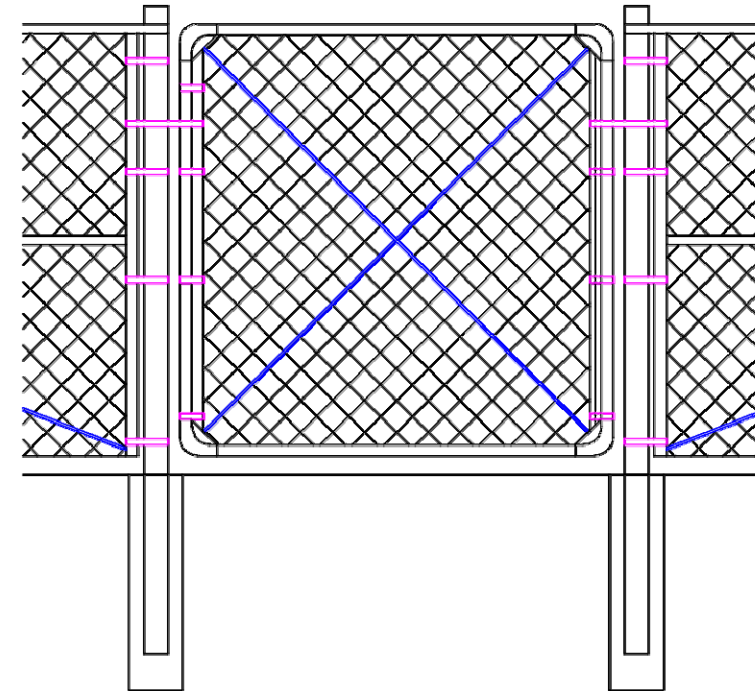

4 Single Swinging Chain Link Gate
A1.04 3/4"=1'-0"

The contractor shall supply a total galvanized chain link fence system of the design, style and strength to match existing according to location. The system shall include all components (i.e., framework, chain link fabric, gates, and fittings) required.

Fence Height to match existing as noted on scope of work.

Line Post Spacing at intervals not exceeding 10 feet.

wire size shall match existing gauge per location.

Fabric height shall match height as noted in scope of work per location with a mesh size matching existing per location.

Top and bottom edge selvage shall match existing per location.

Barbed wire shall match existing per location.

Concrete footings shall be sloped to drain water away from footing.



RICHARD C. LAMBERT
CONSULTANTS, L.L.C.
Planning
Architecture
Engineering
Construction
Management
900 W. Causeway Approach
Mandeville, LA 70471
985-727-4440
Fax: 985-727-4447

DESIGNED	CHECKED	DATE	BY
DFD	DFD	09/17/2018	
CHECKED	DFD		
DATE	CHECKED		
REVISION DESCRIPTION			

MANDEVILLE HURRICANE IDA DAMAGES
FENCING REPLACEMENT TYPES & DETAILS
MANDEVILLE EMERGENCY MANAGEMENT

Project Number:
RCLC No: 721-09

Sheet Number:
A1.04

Item	Location	FEMA Category	Fence Type
Ravine Au Coquille	30.360516, -90.074308 Lafayette St.	D	Type A-4 : 160 LF

Damage Assessment	Scope of Work
-------------------	---------------

Chain-link fence Damaged beyond repair.

Clearing & Grubbing right-of-way. Remove existing damaged fencing. Set new posts to specified elevation. Install galvanized framing and chain-link fencing.



Photo Depicts chain-link fence damaged from storm debris.



Photo Depicts sunken fence posts.



Photo Depicts grubbing and clearing may be necessary to access Fence line.



Photo Depicts fence crossing canal.

Item	Location	FEMA Category	Fence Type
Paul Spitzfaden Community Center	30.371628,-90.078026 3090 E. Causeway Approach	E	Type C-2 : 190 LF Type E-1 : (1)

Damage Assessment	Scope of Work
Dumpster enclosure damaged beyond repair. Wooden fence leaning due to down powerpole.	Demolish and remove existing fence. Install new wooden fence posts, framing and fence boards. Install Gate posts and Fabricated gate with Lock.



Photo Depicts wooden Dumpster enclosure with Galvanized posts. In addition, Galvanized fabricated gate.



Photo Depicts damaged and leaning wooden fence.

Item	Location	FEMA Category	Fence Type
Old Mandeville Jail, Lean-to	30.356369, -90.065211	E	Type A-5 : 280 LF
Garage	1927-1928 Madison St.		Type C-4 : 150 LF
Damage Assessment		Scope of Work	

Wooden gate damage beyond repair. Chain-link gate damaged and sagging due to storm debris.

Clear and grubbing for fence installation in area where necessary. Demolish and remove existing fence. Install new wooden fence posts, framing and fence boards. Repair or Replace sagging Chain-link Gate w Barbed wire.



Photo Depicts wooden fence leaning and damaged.



Photo Depicts wooden gate leaning and damaged



Photo depicts sagging/damaged chainlink fence.



Photo Depicts grubbing and clearing may be necessary to access Fence line.

Item	Location	FEMA Category	Fence Type
Mandeville Department of Public Works	30.376924,-90.099723 1100 Mandeville High Blvd.	E	Type A-1 : 20 LF Type A-7 : 200 LF
Damage Assessment		Scope of Work	

Chain-link fence damaged in sections.

Demolish and remove existing damage fencing to extent required. Install New posts, framing, and fencing where necessary.



Photo Depicts chain-link fence damaged from storm debris.



Photo Depicts chain-link fence damaged from storm debris.

Item	Location	FEMA Category	Fence Type
Mandeville DPW Maintenance Garage	30.376924,-90.099723 1100 Mandeville High Blvd.	E	Type A-3 : 160 LF

Damage Assessment	Scope of Work
-------------------	---------------

Chain-link fence damaged in sections.

Demolish and remove existing damage fencing to extent required. Install New posts, framing, and fencing where necessary.



Photo Depicts chain-link fence damaged from storm debris.



Photo Depicts chain-link fence damaged from storm debris.

Item	Location	FEMA Category	Fence Type
Lift Station 4	30.35206,-90.06263 218 Foy St.	F	Type C-4 : 75 LF Type E-4 : (1)
Damage Assessment		Scope of Work	

Wooden fence damaged and missing fence boards. Repair where necessary. Gate sagging need to be replaced.

Clear and grubbing where necessary. Demolish and remove existing fence to extent required. Install new fence posts, framing and fence boards. Repair or replace damaged gate w lock.



Photo Depicts gate sagging due to leaning posts.



Photo Depicts wooden fence leaning and damaged.



Photo Depicts grubbing and clearing may be necessary to access Fence line.



Photo Depicts another view of fence line.

Item	Location	FEMA Category	Fence Type
Lift Station 44	30.38013,-90.10952 23 Pintail Trace	F	Type C-1 : 75 LF Type E-2 : (1)

Damage Assessment	Scope of Work
-------------------	---------------

Wooden fence is damaged and posts leaning. Gate missing fence boards.

Demolish and remove damaged fencing on to extent required. Install new posts, framing and fence boards.



Photo Depicts wooden fence missing sections and damaged.



Photo Depicts gate missing fence boards.



Photo Depicts Fence missing boards and leaning.



Photo Depicts saggin fence framing and leaning posts.

Item	Location	FEMA Category	Fence Type
Lift Station 37	30.38866,-90.11242 #11 Cardinal Ln. (Sanctuary) End of the homeowners driveway.	F	Type C-4 : 90 LF Type E-4 : (1)

Damage Assessment	Scope of Work
Wooden fence and gate damaged beyond repair.	Install fence posts, framing and fence boards. Install steel gate posts and wooden gate with locking Mechanism.



Photo Depicts wooden gate with steel posts.



Photo Depicts damaged wooden fence.



Photo Depicts another view of damaged wooden fence.



Photo Depicts another view of damage.

Item	Location	FEMA Category	Fence Type
WW 2	30.368663,-90.086884 3350 Monroe St.	F	Type B-1 : (1) Type A-7 : 400 LF
Damage Assessment		Scope of Work	
Fence in repairable condition. Barbed wire damaged along fence. Gate damaged and sagging.		Demolish and remove existing fence as indicated in contract. Install new posts, framing, and chainlink fencing where necessary. Repair Barbed wire. Repair Chainlink Gate.	



Photo Depicts chain-link fence damaged from storm debris.



Photo Depicts another view of fence.



Photo Depicts damaged Barbed wire.



Photo Depicts fence and gate damaged from debris.

Item	Location	FEMA Category	Fence Type
WW St. Ann	30.389084,-90.088045 Tower and Pump Station @1461 N. Causeway & St. Ann	F	Type A-1 : 170 LF Type A-2 : 140 LF Type B-1 : (1) Type A-7 : 30 LF

Damage Assessment	Scope of Work
Chain-link fence and posts damaged. Barbed wire damaged. Wooden fence leaning and missing boards.	Clear and grub areas where necessary. Demolish and remove existing damage fencing to extent required. Install New posts, framing, and fencing where necessary.



Photo Depicts chain-link fence damaged from storm debris.



Photo Depicts Wooden Fence damaged and leaning.



Photo Depicts barbed wire damaged.



Photo Depicts another view of chainlink fence.



Photo Depicts another view of chainlink fence.

Item	Location	FEMA Category	Fence Type
Paul D. Cordes Park	30.37621,-90.078473 3101 E. Causeway Approach	G	Type C-1 : 80 LF Type A-9 : 75 LF
Damage Assessment		Scope of Work	

Wooden Fence damaged beyond repair.

Demolish and remove existing damage fencing to extent required. Install New posts, framing, and fencing boards. Repair Tennis Court Fence Fabric.



Photo Depicts wooden fence damaged from storm debris.



Photo Depicts wooden fence damaged from storm debris.



Photo Depicts wooden fence damaged from storm debris.



Phot depicts Tennis court fence fabric damage.

Item	Location	FEMA Category	Fence Type
Mandeville Lakefront Splash Park	30.349054,-90.060665 1517-1547 Lakeshore Dr.	G	Type F-2 : 700 LF Type F-2A : 700 LF
Damage Assessment		Scope of Work	

Ornamental Fence damaged beyond repair.

Demolish and remove existing damage fencing to extent required. Install New posts, framing, and fencing.



Photo Depicts Aluminum Ornamental fence damaged from storm debris.



Photo Depicts another view of Aluminum Ornamental fence damaged from storm debris.



Photo Depicts another view of Aluminum Ornamental fence damaged from storm debris.



Photo Depicts Ornamental Design of Fence.

Item	Location	FEMA Category	Fence Type
Sunset Point	30.361131,-90.085617 Massena St. @ Lake Pontchartrain.	G	Type D-1 : 320 LF Type D-2 : 30 LF Type G-1 : (2) Type F-1 : (1) Type F-1A : (1)

Damage Assessment	Scope of Work
Ornamental Gate damaged beyond repair. Wooden Fence damaged in sections but can be repaired.	Demolish and remove existing damage fencing to extent required. Install New posts, framing, and fencing boards. Fabricate New Ornamental Gate.



Photo Depicts Ornamental Gate damage.



Photo Depicts another view of Ornamental gate.



Photo Depicts wooden fence damage.



Photo Depicts wooden fence damage.

Item	Location	FEMA Category	Fence Type
Mandeville Cemetary	30.358296,-90.05687 Montgomery St. near Foy St.	G	Type A-4 : 500 LF Type B-1 : (1)

Damage Assessment	Scope of Work
Chain-link fence damaged beyond repair.	Clear and grub areas where necessary. Demolish and remove existing damage fencing to extent required. Install New posts, framing, and fencing where necessary.



Photo Depicts chain-link fence damaged from storm debris.



Photo Depicts chain-link fence damaged from storm debris.



Photo Depicts chain-link fence damaged from storm debris.



Photo Depicts chain-link fence damaged from storm debris.

Item	Location	FEMA Category	Fence Type
Harbor Field	30.350154,-90.059618 Jackson Ave @ Claiborne St.	G	Type A-4 : 100 LF Type A-3 : 50 LF Type A-8 : 60 LF Type B-3 : (1) Type B-2 : (1)

Damage Assessment	Scope of Work
Chain-link fence damaged in sections.	Clear and grub areas where necessary. Demolish and remove existing damage fencing to extent required. Install New posts, framing, and fencing where necessary.



Photo Depicts chain-link fence damaged from storm debris.



Photo Depicts chain-link fence damaged from storm debris.



Photo Depicts grubbing and clearing may be necessary to access Fence line.



Photo Depicts chain-link fence damaged from storm debris.

LOUISIANA UNIFORM PUBLIC WORK BID FORM

TO: City of Mandeville
Department of Public Works
1100 Mandeville High Blvd., Mandeville, LA
70471
(Owner to provide name and address of owner)

BID FOR: Mandeville IDA – Fencing

(Owner to provide name of project and other identifying information)

The undersigned bidder hereby declares and represents that she/he: a) has carefully examined and understands the Bidding Documents, b) has not received, relied on, or based his bid on any verbal instructions contrary to the Bidding Documents or any addenda, c) has personally inspected and is familiar with the project site, and hereby proposes to provide all labor, materials, tools, appliances and facilities as required to perform, in a workmanlike manner, all work and services for the construction and completion of the referenced project, all in strict accordance with the Bidding Documents prepared by: _____ and dated: _____
(Owner to provide name of entity preparing bidding documents.)

Bidders must acknowledge all addenda. The Bidder acknowledges receipt of the following **ADDENDA:** (Enter the number the Designer has assigned to each of the addenda that the Bidder is acknowledging) _____.

TOTAL BASE BID: For all work required by the Bidding Documents (including any and all unit prices designated “Base Bid” * but not alternates) the sum of:
_____ Dollars (\$ _____)

ALTERNATES: For any and all work required by the Bidding Documents for Alternates including any and all unit prices designated as alternates in the unit price description.

Add - Alternate No. 1 *(Owner to provide description of alternate and state whether add or deduct)* for the lump sum of:
Substitute Type F-2 Ornamental Steel Fence with Type F-2A Ornamental Powder Coated Aluminum Fence
_____ Dollars (\$ _____)

Add - Alternate No. 2 *(Owner to provide description of alternate and state whether add or deduct)* for the lump sum of:
Substitute Type F-1 Double Swinging Ornamental Steel Gate with Type F-1A Double Swinging Ornamental Powder Coated Aluminum Gate
_____ Dollars (\$ _____)

Alternate No. 3 *(Owner to provide description of alternate and state whether add or deduct)* for the lump sum of:
_____ Dollars (\$ _____)

NAME OF BIDDER: _____

ADDRESS OF BIDDER: _____

LOUISIANA CONTRACTOR’S LICENSE NUMBER: _____

NAME OF AUTHORIZED SIGNATORY OF BIDDER: _____

TITLE OF AUTHORIZED SIGNATORY OF BIDDER: _____

SIGNATURE OF AUTHORIZED SIGNATORY OF BIDDER **: _____

DATE: _____

THE FOLLOWING ITEMS ARE TO BE INCLUDED WITH THE SUBMISSION OF THIS LOUISIANA UNIFORM PUBLIC WORK BID FORM:

* The Unit Price Form shall be used if the contract includes unit prices. Otherwise it is not required and need not be included with the form. The number of unit prices that may be included is not limited and additional sheets may be included if needed.

** **A CORPORATE RESOLUTION OR WRITTEN EVIDENCE** of the authority of the person signing the bid for the public work as prescribed by LA R.S. 38:2212(B)(5).

BID SECURITY in the form of a bid bond, certified check or cashier’s check as prescribed by LA R.S. 38:2218(A) attached to and made a part of this bid.

LOUISIANA UNIFORM PUBLIC WORK BID FORM

UNIT PRICE FORM

TO: City of Mandeville
Department of Public Works
1100 Mandeville High Blvd, Mandeville, LA 70471

BID FOR: Mandeville IDA - Fencing

(Owner to provide name and address of owner)

(Owner to provide name of project and other identifying information)

UNIT PRICES: This form shall be used for any and all work required by the Bidding Documents and described as unit prices. Amounts shall be stated in figures and only in figures.

DESCRIPTION:	x Base Bid or <input type="checkbox"/> Alt.# ___ Replace 6 ft. high chain link perimeter fencing - Unit Price to include fence, (3) strand barbed wire, materials, and installation.			
REF. NO.	QUANTITY:	UNIT OF MEASURE:	UNIT PRICE	UNIT PRICE EXTENSION (<i>Quantity times Unit Price</i>)
Type A-1	190	Linear Feet		

DESCRIPTION:	x Base Bid or <input type="checkbox"/> Alt.# ___ Repair 6 ft. high chain link perimeter fencing - Unit Price to include fence, (3) strand barbed wire, materials, and installation.			
REF. NO.	QUANTITY:	UNIT OF MEASURE:	UNIT PRICE	UNIT PRICE EXTENSION (<i>Quantity times Unit Price</i>)
Type A-2	140	Linear Feet		

DESCRIPTION:	x Base Bid or <input type="checkbox"/> Alt.# ___ Replace 6 ft. high chain link perimeter fencing - Unit Price to include fence, materials, and installation.			
REF. NO.	QUANTITY:	UNIT OF MEASURE:	UNIT PRICE	UNIT PRICE EXTENSION (<i>Quantity times Unit Price</i>)
Type A-3	50	Linear Feet		

DESCRIPTION:	x Base Bid or <input type="checkbox"/> Alt.# ___ Replace 5 ft. high chain link perimeter fencing - Unit Price to include fence, materials, and installation.			
REF. NO.	QUANTITY:	UNIT OF MEASURE:	UNIT PRICE	UNIT PRICE EXTENSION (<i>Quantity times Unit Price</i>)
Type A-4	760	Linear Feet		

DESCRIPTION:	x Base Bid or <input type="checkbox"/> Alt.# ___ Repair 5 ft. high chain link perimeter fencing - Unit Price to include fence, materials, and installation.			
REF. NO.	QUANTITY:	UNIT OF MEASURE:	UNIT PRICE	UNIT PRICE EXTENSION (<i>Quantity times Unit Price</i>)
Type A-5	280	Linear Feet		

DESCRIPTION:	x Base Bid or <input type="checkbox"/> Alt.# ___ Replace 3 Strand Barbed Wire. - Unit Price to include fence, materials, and installation.			
REF. NO.	QUANTITY:	UNIT OF MEASURE:	UNIT PRICE	UNIT PRICE EXTENSION (<i>Quantity times Unit Price</i>)
Type A-7	630	Linear Feet		

DESCRIPTION:	x Base Bid or <input type="checkbox"/> Alt.# ___ Repair 6 ft. height 8 ft wide Pair of Chain Link Swing Gates. Unit Price to include gate, materials, and installation.			
REF. NO.	QUANTITY:	UNIT OF MEASURE:	UNIT PRICE	UNIT PRICE EXTENSION (<i>Quantity times Unit Price</i>)
Type B-1	3	Each Gate Pair		

DESCRIPTION:	x Base Bid or <input type="checkbox"/> Alt.# ___ Replace 4 ft height 5 ft wide Chain Link Single Swing Gate. Unit Price to include gate, materials, and installation.			
REF. NO.	QUANTITY:	UNIT OF MEASURE:	UNIT PRICE	UNIT PRICE EXTENSION (<i>Quantity times Unit Price</i>)
Type B-2	1	Each Gate		

DESCRIPTION:	x Base Bid or <input type="checkbox"/> Alt.# ___ Replace 4 ft height 6 ft wide Pair of Chain link Swing Gates. Unit Price to include gate, materials, and installation.			
REF. NO.	QUANTITY:	UNIT OF MEASURE:	UNIT PRICE	UNIT PRICE EXTENSION (<i>Quantity times Unit Price</i>)
Type B-3	1	Each Gate Pair		

DESCRIPTION:	x Base Bid or <input type="checkbox"/> Alt.# ___ Replace 6 ft height Wooden Fence - Unit Price to include fence, materials, and installation.			
REF. NO.	QUANTITY:	UNIT OF MEASURE:	UNIT PRICE	UNIT PRICE EXTENSION (<i>Quantity times Unit Price</i>)
Type C-1	155	Linear Feet		

DESCRIPTION:	x Base Bid or <input type="checkbox"/> Alt.# ___ Repair 6 ft height Wooden Fence - Unit Price to include fence, materials, and installation.			
REF. NO.	QUANTITY:	UNIT OF MEASURE:	UNIT PRICE	UNIT PRICE EXTENSION (<i>Quantity times Unit Price</i>)
Type C-2	190	Linear Feet		

DESCRIPTION:	x Base Bid or <input type="checkbox"/> Alt.# ___ Replace 8 ft height Wooden Fence - Unit Price to include fence, materials, and installation.			
REF. NO.	QUANTITY:	UNIT OF MEASURE:	UNIT PRICE	UNIT PRICE EXTENSION (<i>Quantity times Unit Price</i>)
Type C-4	315	Linear Feet		

DESCRIPTION:	x Base Bid or <input type="checkbox"/> Alt.# ___ Replace Farm Fencing - Unit Price to include fence, materials, and installation.			
REF. NO.	QUANTITY:	UNIT OF MEASURE:	UNIT PRICE	UNIT PRICE EXTENSION (<i>Quantity times Unit Price</i>)
Type D-1	320	Linear Feet		

DESCRIPTION:	x Base Bid or <input type="checkbox"/> Alt.# ___ Repair Farm Fencing - Unit Price to include fence, materials, and installation.			
REF. NO.	QUANTITY:	UNIT OF MEASURE:	UNIT PRICE	UNIT PRICE EXTENSION (<i>Quantity times Unit Price</i>)
Type D-2	30	Linear Feet		

DESCRIPTION:	x Base Bid or <input type="checkbox"/> Alt.# ___ Replace 6 ft. height 8 ft wide Pair of Swing Gates with Galvanized steel framing and Privacy Mesh. Unit Price to include Gate, materials, and installation.			
REF. NO.	QUANTITY:	UNIT OF MEASURE:	UNIT PRICE	UNIT PRICE EXTENSION (<i>Quantity times Unit Price</i>)
Type E-1	1	Each Gate Pair		

DESCRIPTION:	x Base Bid or <input type="checkbox"/> Alt.# ___ Repair 6 ft. height 8 ft wide Pair of Wooden Swing Gates with Galvanized steel framing. Unit Price to include Gate, materials, and installation.			
REF. NO.	QUANTITY:	UNIT OF MEASURE:	UNIT PRICE	UNIT PRICE EXTENSION (<i>Quantity times Unit Price</i>)
Type E-2	1	Each Gate Pair		

DESCRIPTION:	x Base Bid or <input type="checkbox"/> Alt.# ___ Repair 8 ft. height 8 ft wide Pair of Wooden Swing Gates with Galvanized steel framing. Unit Price to include Gate, materials, and installation			
REF. NO.	QUANTITY:	UNIT OF MEASURE:	UNIT PRICE	UNIT PRICE EXTENSION (<i>Quantity times Unit Price</i>)
Type E-4	2	Each Gate Pair		

DESCRIPTION:	x Base Bid or <input type="checkbox"/> Alt.# ___ Replace Double Swinging Ornamental Steel Gate. Unit Price to include Gates, materials, and installation			
REF. NO.	QUANTITY:	UNIT OF MEASURE:	UNIT PRICE	UNIT PRICE EXTENSION (<i>Quantity times Unit Price</i>)
Type F-1	1	Each Gate		

DESCRIPTION:	<input type="checkbox"/> Base Bid or x Alt.# ___ Replace Double Swinging Ornamental Powder Coated Aluminum Gate. Unit Price to include Gates, materials, and			
REF. NO.	QUANTITY:	UNIT OF MEASURE:	UNIT PRICE	UNIT PRICE EXTENSION (<i>Quantity times Unit Price</i>)
Type F-1A	1	Each Gate		

DESCRIPTION:	x Base Bid or <input type="checkbox"/> Alt.# ___ Replace Ornamental Steel Fence. Unit Price to include fence, materials, and installation			
REF. NO.	QUANTITY:	UNIT OF MEASURE:	UNIT PRICE	UNIT PRICE EXTENSION (<i>Quantity times Unit Price</i>)
Type F-2	700	Linear Feet		

DESCRIPTION:	<input type="checkbox"/> Base Bid or x Alt.# ___ Replace Ornamental Powder Coated Aluminum Fence. Unit Price to include fence, materials, and installation			
REF. NO.	QUANTITY:	UNIT OF MEASURE:	UNIT PRICE	UNIT PRICE EXTENSION (<i>Quantity times Unit Price</i>)
Type F-2A	700	Linear Feet		

DESCRIPTION:	x Base Bid or <input type="checkbox"/> Alt.# ___ Replace 4 ft. height 6 ft. wide Pair of Farm Style Swing Gates. Unit Price to include Gate, materials, and installation			
REF. NO.	QUANTITY:	UNIT OF MEASURE:	UNIT PRICE	UNIT PRICE EXTENSION (<i>Quantity times Unit Price</i>)
Type G-1	2	Each Gate Pair		

DESCRIPTION:	x Base Bid or <input type="checkbox"/> Alt.# ___ Replace 25 ft height Chain Link Backstop. Unit Price to include fence, materials, and installation			
REF. NO.	QUANTITY:	UNIT OF MEASURE:	UNIT PRICE	UNIT PRICE EXTENSION (<i>Quantity times Unit Price</i>)
Type A-8	60	Linear Feet		

DESCRIPTION:	x Base Bid or <input type="checkbox"/> Alt.# ___ Repair 10 ft height Chain Link fence. Unit Price to include fence, materials, and installation			
REF. NO.	QUANTITY:	UNIT OF MEASURE:	UNIT PRICE	UNIT PRICE EXTENSION (<i>Quantity times Unit Price</i>)
Type A-9	75	Linear feet		

DESCRIPTION:	x Base Bid or <input type="checkbox"/> Alt.# ___ Replace 6 ft height Chain Link fence with Privacy Slates. Unit Price to include fence, materials, and installation			
REF. NO.	QUANTITY:	UNIT OF MEASURE:	UNIT PRICE	UNIT PRICE EXTENSION (<i>Quantity times Unit Price</i>)
Type A-10	160	Linear feet		

Wording for "DESCRIPTION" is to be provided by the Owner.

All quantities are estimated. The contractor will be paid based upon actual quantities as verified by the Owner.

ATTACHMENT B: NON-COLLUSION AFFIDAVIT



FENCE REPLACEMENT

STATE OF LOUISIANA

PARISH OF _____

BEFORE ME, THE UNDERSIGNED AUTHORITY, PERSONALLY CAME AND APPEARED _____, WHO AFTER BEING BY ME DULY SWORN, DEPOSED AND SAID THAT HE/SHE IS THE FULLY AUTHORIZED _____ OF _____ (HEREIN AFTER REFERRED TO AS VENDOR) THE PARTY WHO SUBMITTED A PROPOSAL FOR _____ WHICH _____ WAS RECEIVED BY CITY OF MANDEVILLE ON _____ AND SAID AFFIANT FURTHER SAID:

1. That vendor employed no person, corporation, firm, association, or other organization, either directly or indirectly, to secure the public contract under which he received payment, other than persons regularly employed by the vendor whose services in connection with the public contract were in the regular course of their duties for vendor; and
2. That no part of the contract price received by vendor was paid or will be paid to any person, corporation, firm, association, or other organization for soliciting the contract, other than the payment of their normal compensation to persons regularly employed by the vendor whose services in connection with the project were in the regular course of their duties for vendor.
3. Said proposal is genuine and the vendor has not colluded, conspired or agreed directly or indirectly with any other vendor to offer a sham or collusive proposal.
4. Said vendor has not in any manner, directly or indirectly, agreed with any other person to fix the proposal price of affiant or any other vendor, or to fix any overhead, profit or cost element of said price, or that of any other vendor, to induce any other person to refrain from providing a proposal.
5. Said vendor is not intended to secure an unfair advantage of benefit from The City of Mandeville or in favor of any person interested in the proposed contract.

AUTHORIZED SIGNATURE

SWORN TO AND SUBSCRIBED BEFORE ME THIS _____ DAY OF _____, 20

My commission expires _____



ATTACHMENT C: AFFIDAVIT OF PAST CRIMINAL CONVICTIONS

FENCE REPLACEMENT

STATE OF LOUISIANA
PARISH OF _____

BEFORE ME, THE UNDERSIGNED AUTHORITY, PERSONALLY CAME AND APPEARED _____, WHO AFTER BEING BY ME DULY SWORN, DEPOSED AND SAID THAT HE/SHE IS THE FULLY AUTHORIZED _____ OF _____ (HEREIN AFTER REFERRED TO AS VENDOR) THE PARTY WHO SUBMITTED A PROPOSAL FOR _____ WHICH WAS RECEIVED BY CITY OF MANDEVILLE ON _____ AND SAID AFFIANT FURTHER SAID:

He/she personally has not been convicted of, nor has he/she entered a plea of guilty or nolo contendere to any of the crimes or equivalent federal crimes listed below. NO individual partner, incorporator, director, manager, officer, organizer, or member, who has a minimum of a ten percent (10%) ownership in the bidding entity named below has been convicted of, or has entered a plea of guilty or nolo contendere to any of the following state crimes or equivalent federal crimes:

- (a) Public bribery (R.S. 14:118)
(b) Corrupt influencing (R.S. 14:120)
(c) Extortion (R.S. 14:66)
(d) Money laundering (R.S. 14:23)

A conviction of or plea of guilty or nolo contendere to the following state crimes or equivalent federal crimes shall bar any person or the bidding entity from bidding on public projects for a period of five years from the date of conviction or from the date of the entrance of the plea of guilty or nolo contendere:

- (a) Theft (R.S. 14:67)
(b) Identity Theft (R.S. 14:67.16)
(c) Theft of a business record (R.S.14:67.20)
(d) False accounting (R.S. 14:71)
(e) Issuing worthless checks (R.S. 14:71)
(f) Bank fraud (R.S. 14:71.1)
(g) Forgery (R.S. 14:72)
(h) Contractors; misapplication of payments (R.S. 14:202)
(i) Malfeasance in office (R.S. 14:134)

The five-year prohibition provided for in this section shall apply only if the crime was committed during the solicitation or execution of a contract or bid awarded pursuant to these provisions. If evidence is submitted substantiating that a false attestation has been made and the project must be re-advertised or the contract cancelled, the awarded entity making the false attestation shall be responsible to the public entity for the costs of rebidding, additional costs due to increased costs of bids and any and all delay costs due to the rebid or cancellation of this project.

SWORN TO AND SUBSCRIBED BEFORE ME THIS _____ DAY OF _____, 20_____

NOTARY PUBLIC



ATTACHMENT D: CODE OF CONDUCT AND AFFIDAVIT

FENCE REPLACEMENT

CITY OF MANDEVILLE'S CODE OF CONDUCT

A. POLICY STATEMENT

The citizens of The City of Mandeville rightfully expect city elected officials, unclassified employees, and appointed personnel to adhere to the highest standards of professional and ethical conduct in the performance of their duties and responsibilities. The City of Mandeville Personnel Policies and Police Standard Operating Procedures Manual specifies the conduct of the classified civil service employee so that this code does not apply to this class of city employees. This code applies to the following persons:

- i) Elected municipal officials,
- ii) Unclassified employees of The City of Mandeville
- iii) Persons appointed to the various boards and commissions of The City of Mandeville.
- iv) Contractors as described in Section D of this code. Contractors are not obligated to participate in the training requirements of this code but will be required to demonstrate that they are familiar with this code and the Louisiana State Code of Ethics.

While this document in and of itself is not punitive in nature, it complements the existing laws incorporated in the Louisiana State Code of Ethics and other existing policies that cover persons employed by The City of Mandeville. All elected officials, unclassified public employees and appointed personnel of The City in whatever capacity should know that infractions of this Code of Conduct may also be violations prohibited by state ethical rules and regulations which do carry punitive provisions.

Every person covered by this Code has a unique position of trust in the community and, therefore, assumes a special responsibility to act with the highest standards of honesty, fidelity and fairness. Mandeville public servants should conduct themselves in a manner that merits public trust and confidence.

B. PURPOSE OF THIS POLICY

Section 7-02 of The City Charter for The City of Mandeville provides that "All officers and employees of The City government shall comply with the provisions of the Louisiana State Code of Ethics pertaining to local government." The purpose of the Code of Conduct is to complement the Code of Ethics with a code that requires conduct over and above the strict adherence to the letter of the general law and the Louisiana State Ethics Code. To establish a set of guidelines for the behavior of The City of Mandeville elected officials, unclassified public employees and appointed personnel which will enhance the effectiveness of city government while maintaining the high standards of quality and professionalism necessary for The City to successfully project the best image possible.

C. CITY OF MANDEVILLE CODE OF CONDUCT FOR ELECTED, UNCLASSIFIED CITY EMPLOYEES AND APPOINTED PERSONNEL.

All persons in each category as defined by the above title shall sign a copy of this Code of Conduct thereby acknowledging that they have received a copy and understand that it is therefore their responsibility to comply with this Code of Conduct and any revisions to it as follows:

1. Adhere to the principle that all activities undertaken by persons covered by this code shall be in the best interests of the citizens of The City and with the goal of perfection of city government. That no personal gain or benefit, except for compensation and benefits accompanying applicable personnel, should be



ATTACHMENT D: CODE OF CONDUCT AND AFFIDAVIT

FENCE REPLACEMENT

accepted.

2. Accept the responsibility that improper conduct can reflect negatively on the public image of The City and bring embarrassment and discontent to the citizens of The City. It is the intent of this Code of Conduct to make the persons covered by this code aware, through training, of the existing laws and city rules and regulations of employment that are designed to respond to any improper conduct in whatever context.
3. Participate in a comprehensive training program regarding the Louisiana State Code of Ethics and this Code of Conduct for all levels of personnel defined by this Code of Conduct. This training shall include, but not be limited to, ongoing small and large group training sessions highlighting general rules of conduct and specific rules of conduct pertaining to elected officials, unclassified employees or appointed personnel. This training shall amplify what personnel can or cannot do in complying with the Louisiana State Code of Ethics and this Code of Conduct. It shall also identify and help personnel recognize potential conflicts of interest and provide mechanisms for alerting the proper officials of such potential conflicts. Each person covered by this code shall be required to participate in at least two hours of training per calendar year. These hours shall be certified to the Personnel Director and be a part of the person's record.
4. Always be in full compliance with all applicable federal, state and local laws and regulations.
5. Direct all requests for documents under the Public Records law to The City Attorney for response. All requests for documents under the Public Records law shall be in writing.
6. Respect the confidentiality of information concerning The City, City personnel or proceedings of The City.

D. CONTRACTORS

Any individual or business entity that enters into a contract with The City of Mandeville shall be subject to this code and be referred to herein as a "Contractor". Every Contractor shall be mindful of the principles of law relating to the Code of Governmental Ethics of the State of Louisiana. The Contractor shall not make or authorize any payment or give anything of value directly or indirectly to an official of this government for the purpose of influencing an act or decision of official capacity or for assisting in obtaining or retaining business for or with, or for direction of business to any person. Likewise, the Contractor will not make or authorize any entity or person to use any influence with this government to assist anyone in obtaining or retaining business for or with, or directing business to, any person. Any breach or violation of this clause by the Contractor shall be considered a substantial and material breach of its contract with The City of Mandeville.

That all Contractors shall sign an affidavit in the form attached hereto as Attachment A as a condition of their contract with The City of Mandeville.

E. COMPLAINTS.

All complaints shall be in writing and signed by the person making the complaint. There shall be no "anonymous complaints". Any person wishing to file a complaint regarding any person covered by this code shall send the complaint to The City Attorney's Office where a log will be kept of such complaints. A copy of any complaint regarding any person covered by this code shall be sent to the person complained of within three days of the receipt of the



ATTACHMENT D: CODE OF CONDUCT AND AFFIDAVIT

FENCE REPLACEMENT

complaint. The person complained of shall have five days to respond in writing to the complaint and his or her response shall be part of the complaint record. All complaints will be reviewed by The City Attorney to determine if any ethical violations had been alleged by the person making the complaint. If such allegations have been made, then The City Attorney shall forward a copy of the complaint to the Louisiana Board of Ethics for further action.

Any person who wishes to make a complaint to the Louisiana Board of Ethics may do so by sending the complaint to: Louisiana Ethics Administration Program, P.O. Box 4368, Baton Rouge, LA, 70821 or call the Board office at (225) 219-5600.

CODE OF CONDUCT AFFIDAVIT

STATE OF LOUISIANA
PARISH OF

BEFORE ME, the undersigned Notary Public personally came and appeared:

_____ ; if a corporation, LLC, or partnership, then the affidavit may be signed by corporate officer, member or partner stating that the subject organization is aware of the Code of Governmental Ethics.

Who, after first being duly sworn did depose and say he/she is the president, corporate officer, or designee of _____ and that he/she is familiar with the Code of Governmental Ethics contained in Louisiana Revised Statutes at Title 42, Chapter 15 and is familiar with and has a copy of the Code of Conduct for The City of Mandeville; and

That, _____ will conform to the provisions in the Code of Governmental Ethics and the Code of Conduct as a condition of any contract between the company and The City of Mandeville, Louisiana; and

That, the provisions of the Code of Governmental Ethics and the Code of Conduct shall apply to any subcontract that the Contractor has with any other entity in the performance of its contract with The City of Mandeville, Louisiana and there shall be a statement in every subcontract to that effect.

CONTRACTOR: _____

By: _____

SWORN TO AND SUBSCRIBED BEFORE ME THIS _____ DAY OF _____, 20

NOTARY PUBLIC

ATTACHMENT E: E-VERIFY AFFIDAVIT



FENCE REPLACEMENT

STATE OF LOUISIANA

PARISH OF _____

BEFORE ME, THE UNDERSIGNED AUTHORITY, PERSONALLY CAME AND APPEARED _____, WHO AFTER BEING BY ME DULY SWORN, DEPOSED AND SAID THAT HE/SHE IS THE FULLY AUTHORIZED _____ OF _____ (HEREIN AFTER REFERRED TO AS VENDOR) THE PARTY WHO SUBMITTED A QUOTE/PROPOSAL/CONTRACT/BID/RFP/SOQ TITLED _____ FOR CITY OF MANDEVILLE PROJECT: _____

Pursuant to LA.R.S. 38:2212.10C, a private employer shall not bid on or otherwise contract with a public Entity for the physical performance of services within the State of Louisiana unless the private employer verifies in a sworn affidavit that the private employer is registered with, participates in, and utilized the status verification system required by LA. R.S. 38:2212.10B(2), known as "E-Verify" program, in accordance with federal rules and regulations pertaining to E-Verify.

Affiant further said:

- (1) Entity is registered and participates in a status verification system to verify that all employees in the State of Louisiana are legal citizens of the United States or are legal aliens.
- (2) Entity shall continue, during the term of the contract, to utilize a status verification system to verify the legal status of all new employees in the State of Louisiana.
- (3) Entity shall require all subcontractors to submit to the Entity an affidavit verifying compliance with statements (1) and (2).

Affiant further said that neither Entity nor subcontractors of Entity have any employees in the State of Louisiana.

SIGNATURE OF AFFIANT

SWORN TO AND SUBSCRIBED BEFORE ME THIS _____ DAY OF _____, 20____

NOTARY PUBLIC

ATTACHMENT F: BYRD ANTI-LOBBYING CERTIFICATION



FENCE REPLACEMENT

For contracts of \$100,000 or more, including amendments, the undersigned Prime Contractor's authorized official or principal certifies, to the best of his or her knowledge and belief, that:

- (1) No Federal appropriated funds have been paid or will be paid, by or on behalf of the undersigned, to any person for influencing or attempting to influence an officer or employee of an agency, a Member of Congress, an officer or employee of Congress, or an employee of a Member of Congress in connection with the awarding of any Federal contract, the making of any federally funded grant, the making of any Federal loan, the entering into of any cooperative agreement, and the extension, continuation, renewal, amendment, or modification of any Federal contract, grant, loan, or cooperative agreement.
- (2) If any funds other than Federal appropriated funds have been paid or will be paid to any person for making lobbying contacts to an officer or employee of any agency, a Member of Congress, an officer or employee of Congress, or an employee of a Member of Congress in connection with this Federal contract, grant, loan, or cooperative agreement, the undersigned shall complete and submit Standard Form LLL, "Disclosure Form to Report Lobbying," in accordance with its instructions [as amended by "Government wide Guidance for New Restrictions on Lobbying," 61 Fed. Reg. 1413 (1/19/96). Note: Language in paragraph (2) herein has been modified in accordance with Section 10 of the Lobbying Disclosure Act of 1995 (P.L. 104-65, to be codified at 2 U.S.C. 1601, et seq.)] A copy of Standard Form LLL is available from City of Mandeville.
- (3) The undersigned shall require that the language of this certification be included in the award documents for all sub awards at all tiers (including subcontracts, sub grants, and contracts under grants, loans, and cooperative agreements) and that all sub recipients shall certify and disclose accordingly. This certification is a material representation of fact upon which reliance was placed when this transaction was made or entered into. Submission of this certification is a prerequisite for making or entering into this transaction imposed by 31, U.S.C. § 1352 (as amended by the Lobbying Disclosure Act of 1995). Pursuant to 31 U.S.C. § 1352(c)(1)-(2)(A), any person who makes a prohibited expenditure or fails to file or amend a required certification or disclosure form shall be subject to a civil penalty of not less than \$10,000 and not more than \$100,000 for each such expenditure or failure.

The undersigned prime Contractor's authorized official or principal also agrees that the requirements of the Byrd Anti-Lobbying Act and associated regulations, applies to all tiers of subcontractors performing work under the Contract.

The undersigned prime Contractor's authorized official or principal, _____, certifies or affirms the truthfulness and accuracy of each statement of its certification and disclosure, if any. In addition, the Contractor understands and agrees that the provisions of 31 U.S.C. A 3801, et seq., apply to this certification, Contract and disclosure, if any.

Signature of Contractor's Authorized Official _____

Name and Title of Contractor's Authorized Official _____

Organization's name _____

Date _____

ATTACHMENT G: SUSPENSION AND DEBARMENT CERTIFICATION



FENCE REPLACEMENT

- (1) This contract is a covered transaction for purposes of 2 C.F.R. pt. 180 and 2 C.F.R. pt. 3000. As such, the Contractor is required to verify that none of the Contractor's principals (defined At 2 C.F.R., 180.995) or its affiliates (defined at 2 C.F.R. 180.905) are excluded (defined at 2 C.F.R. 180.94).
- (2) The Contractor must comply with 2 C.F.R. pt. 180, subpart C and 2 C.F.R. pt. 3000, subpart C, and must include a requirement to comply with these regulations in any lower tier covered transaction it enters into.
- (3) This certification is a material representation of fact relied upon by The City of Mandeville. If it is determined that the Contractor did not comply with 2 C.F.R. pt. 180, subpart C and 2 C.F.R. pt. 3000, subpart C, in addition to remedies available to The City of Mandeville, the Federal government may pursue available remedies, including but not limited to suspension and/or debarment.
- (4) The bidder or contractor agrees to comply with the requirements of 2 C.R.R. pt. 180, Subpart C and 2 C.F.R. pt. 3000, subpart C while this offer is valid and throughout the period of any contract that may arise from this offer. The bidder or contractor further agrees to include a provision requiring such compliance in its lower tier covered transactions (sub-contracts).

Contractor's authorized Official or Principal's Signature _____

Printed name and title _____

Firm's name _____

Date _____



FENCE REPLACEMENT

Notice: Insurance requirements only apply as they are relevant to the services being provided.

The Contractor shall secure and maintain at its expense such insurance that will protect it and City from claims under the Workers' Compensation Acts and from claims for bodily injury, death or property damage which may arise from the performance of services under this agreement. All certificates of insurance shall be furnished to the City and shall provide that insurance shall not be canceled or substantively changed without thirty (30) days prior notice of cancellation given to the City, in writing, on all of the required coverage provided to the City. All policies and notices should name the Contractor and the City. The Contractor shall make its policies available for review and examination by the City as may be reasonably requested.

A. All policies must provide for, and certificates of insurance must contain the following:

- (11) Waiver of Subrogation: The Contractor's insurers will have no right of recovery or subrogation against the City, it being the intention of the parties that all insurance policy(ies) so affected shall protect both parties and be the primary coverage for any and all losses covered by the below described insurance. Policy endorsements required for all coverages.
- (12) Additional Insured: The City, its Officers, Agents, Employees and Volunteers shall be named as additional named insured with respect to general liability, automobile liability, excess liability, pollution/environmental liability coverage, and marine liability. Policy endorsements required.
- (13) Hold Harmless: Contractor's liability insurers shall evidence their cognizance of the Hold Harmless and Indemnification being granted in favor of the City by referencing same on the face of the Certificate(s) of Insurance issued.
- (14) Payment of Premiums: The insurance companies issuing the policy or policies shall have no recourse against the City for payment of any premiums or for assessments under any form of policy.

Deductibles: Any and all deductibles in the described insurance policies shall be assumed by and be at the sole risk of the Contractor and shall be indicated on the Certificate of Insurance. Deductibles and/or self-insured retentions exceeding \$100,000 must be approved by the City's Finance Director. The City may require Contractor to produce evidence of verifiable financial ability to satisfy its deductibles and/or self-insured retentions; however, the City assumes no liability or obligation as a result of its examination, acceptance, or rejection of said information presented. The City shall have the sole discretion to accept or reject deductibles and/or self-insured retentions exceeding \$100,000 as it deems appropriate.

- (1) Project reference: The project(s) and location(s) shall be referenced in the comment or description of operations section of the Certificate of Insurance.
- B. The Contractor shall provide at its own expense, proof of the following insurance coverage required by the Contract to the City by insurance companies authorized to do business in the State of Louisiana. Insurance is to be placed with insurers with an A.M. Best rating of no less than A-, Category VII.
- (1) Commercial General Liability insurance with a Combined Single Limit for bodily injury and property damage of at least \$1,000,000 per Occurrence with a General Aggregate limit of at least \$2,000,000 per project. The insurance shall provide for, and the certificate(s) of insurance shall indicate the following coverages:



FENCE REPLACEMENT

- (2) Premises - operations;
 - (3) Broad form contractual liability;
 - (4) Products and completed operations;
 - (5) Personal Injury;
 - (6) Broad form property damage;
 - (7) Explosion, collapse, and underground coverage.
- C. Pollution and Environmental Liability insurance in the minimum amount of \$1,000,000 per occurrence, \$2,000,000 including full contractual liability and third-party claims for bodily injury and/or property damage, for all such hazardous waste, pollutants and/or environmental exposures that may be affected by this project stemming from pollution/environmental incidents as a result of Contractor's operations.

If coverage is provided on a claims-made basis, coverage will at least be retroactive to the earlier of the date of this Contract or the commencement of Contractor services in relation to the work. And the policy will offer an extended discovery clause of at least three years. If written either on an occurrence or claims made basis, this coverage will be maintained through the renewal of this insurance to cover a loss arising out of the completed operations of the insured for a period of at least 2 years after work is accepted as complete by the property owner of this contract is terminated. Evidence of this coverage will not be required unless both of the following are met:

- (1) Contractor receives Notice to Proceed to perform services under this contract; and
 - (2) it has been identified that services performed under this contract will include such exposures.
- D. Business Automobile Liability insurance with a minimum Combined Single Limit of \$1,000,000 per Occurrence for bodily injury and property damage. This insurance shall provide coverage for the following:
- (1) Any automobiles; or
 - (2) Owned automobiles; and
 - (3) Hired automobiles;
 - (4) Non-owned automobiles;
 - (5) Uninsured motorist.
 - (6) MCS-90 and CA9948 Endorsements Required
- E. Marine Liability/Protection and Indemnity insurance is required for any and all vessel and/or marine operations in the minimum limits of \$1,000,000 per occurrence/\$2,000,000 per project general aggregate. The coverage shall include, but is not limited to, the basic coverages found in the Commercial General Liability insurance and coverage for third party liability.



FENCE REPLACEMENT

- F. Workers' Compensation/Employers Liability Insurance: workers compensation as statutorily required; employers liability coverage shall be a minimum of \$1,000,000 each accident, \$1,000,000 each disease, \$1,000,000 disease policy aggregate and when water activities are expected to be performed in connection with this project, coverage shall include USL&H, Jones Act, and/or Maritime Employers Liability. Coverage for owners, officers and/or partners in any way engaged in the project shall be included in the policy and a statement of such shall be made by the insuring producer on the face of the certificate.
- G. Owners Protective Liability (OPL) (formerly Owners and Contractors Protective Liability (OCP) Insurance) shall be furnished by the Contractor naming City as the Named Insured and shall provide coverage in the minimum amount of \$1,000,000 combined single limit (CSL) each occurrence \$2,000,000 aggregate for projects less than \$5,000,000; limits for any project valued over \$5,000,000 shall be set by the Finance Dept. The policy limit is subject to be increased when the total value of the contract increases. The policy and all endorsements shall be addressed to City of Mandeville, 3101 E. Causeway Approach, Mandeville, LA 70448.
- H. Excess/Umbrella Liability shall be furnished by Contractor with limits of at least equal to \$3,000,000 per occurrence on a follow form basis, for all liability coverages set forth above except for the OPL/OCP. (For example: if the General Liability is \$1,000,000 per occurrence, then the excess policy should be at least \$2,000,000 per occurrence thereby providing a combined per occurrence limit of \$3,000,000.)
- I. All policies of insurance shall meet the requirements of the City prior to the commencing of any work. City has the right, but not the duty, to approve all insurance policies prior to commencing of any work. If at any time, it becomes known that any of the said policies shall be or becomes unsatisfactory to City as to form or substance or if a company issuing any such policy shall be or become unsatisfactory to City, the Contractor shall promptly obtain a new policy, timely submit same to the City for approval and submit a certificate thereof as provided above. The City agrees to not unreasonably withhold approval of any insurance carrier selected by Contractor. In the event that the City cannot agree or otherwise authorize said carrier, Contractor shall have the option of selecting and submitting new insurance carrier within thirty (30) days of said notice by the City. In the event that the second submission is insufficient or is not approved, then the City shall have the unilateral opportunity to thereafter select a responsive and responsible insurance carrier all at the cost of Contractor and thereafter deduct from Contractor's fee the cost of such insurance.
- J. Upon failure of Contractor to furnish, deliver and/or maintain such insurance as above provided, the contract, at the election of the City, may be forthwith declared suspended, discontinued or terminated. Failure of the Contractor to maintain insurance shall not relieve the Contractor from any liability under the contract, nor shall the insurance requirements be construed to conflict with the obligation of the Contractor concerning indemnification.
- K. Contractor shall maintain a current copy of all annual insurance policies and provide same to City on an annual basis or as may be reasonably requested. Provider further shall ensure that all insurance policies are maintained in full force and effect throughout the duration of the Project and shall provide the City with annual renewal certificates of insurance evidencing continued coverage, without any prompting from the City.



FENCE REPLACEMENT

- L. It shall be the responsibility of Contractor to require that these insurance requirements are met by all sub-Contractors performing work for and on behalf of the Contractor. Contractor shall further ensure City is named as additional insured on all insurance policies provided by said Contractor and/or sub-Contractor throughout the duration of the project.

- M. Certificates of Insurance (form ACORD 25 (2014/1) or newer) shall be issued as follows:

CERTIFICATE HOLDER:

City of Mandeville, Its Officers, Agents, Employees and Volunteers
3101 E. Causeway Approach
Mandeville, LA 70448
Project/Contract Name and/or Number

Certificates may be sent via email to: PURCHASING@cityofmandeville.com

*NOTICE: City reserves the right to remove, replace, make additions to and/or modify any and all of the insurance requirements at any time.