

Jambalaya Cookoff



INTEROFFICE MEMO

TO: Alicia Watts
Elizabeth Sconzert

FROM: Alia Casborné

DATE: October 11, 2024

SUBJECT: Special Events Application Recommendations

Please find below the Special Events Applications received and recommended for Council approval by the Mayor.

Mary Queen of Peace – Jambalaya Cookoff

Applicant: Sandy Luparello

Date/Time: Saturday, November 11, 2024 – 11:00 a.m. – 3:00 p.m.

Rain Date: N/A

Location: Mary Queen of Peace (Private Property)

Approval Requests:

- City Permit to apply for ATC Alcohol Permit

Contingencies:

- ATC Alcohol Permit

City of Mandeville
675 Lafitte Street Mandeville,
LA 70448



www.cityofmandeville.com
Telephone: (985) 624-3127 or 624-3147
Fax: (985) 624-3128

Mayor Clay Madden

SPECIAL EVENT PERMIT APPLICATION

Name of Organization or Group MQP CO OP
 Name of Authorized Representative Sandy Luparello Non-Profit/Tax-Exempt # _____
 Mailing Address 1515 W Causeway Approach
 City Mandeville State LA Zip 70471
 Applicant Phone # 504-416-5072 Alt. Phone # _____
 E-Mail sandylupe@gmail.com Application Fee Paid? ___ YES ___ NO

Name of Event: MQP Jambalaya Cook Off
 Date(s) of Event: Day Saturday Date 11/2/2024 Time 11-3 Rain Dates(s) _____
 Event Location: Mary Queen of Peace School

Type of Event: New Recurring
 Fundraiser Concert Race/Run/Walk Parade Wedding
 Festival, Carnival or Market Other: _____
 Description/Purpose of Event Jambalaya Fundraiser Estimated Attendance 500

EVENT DETAILS - Check all that apply:

1	Are patron admission, entry or participant fees charged?	<input checked="" type="checkbox"/> Yes	<input type="checkbox"/> No
2	Is the event open to the public?	<input checked="" type="checkbox"/> Yes	<input type="checkbox"/> No
3	Are Street Closures Requested? If yes, please contact Mandeville Police Dept.	<input type="checkbox"/> Yes	<input checked="" type="checkbox"/> No
4	Will you require barricades for the event?	<input type="checkbox"/> Yes	<input checked="" type="checkbox"/> No
5	Are you requesting that Police be present during the event?	<input checked="" type="checkbox"/> Yes	<input type="checkbox"/> No
6	If you answered YES, to number 5, how many officers are you requesting	<u>2</u>	
7	If you are requesting Police, will they need to direct traffic?	<input checked="" type="checkbox"/> Yes	<input type="checkbox"/> No
8	Will alcohol be consumed, distributed, or sold at this event?	<input checked="" type="checkbox"/> Yes	<input type="checkbox"/> No
9	Will food be distributed, prepared or sold at this event?	<input checked="" type="checkbox"/> Yes	<input type="checkbox"/> No
10	Will there be canopies or tents?	<input checked="" type="checkbox"/> Yes	<input type="checkbox"/> No
11	Will there be vendor booths? Merchandise or product sales?	<input checked="" type="checkbox"/> Yes	<input type="checkbox"/> No
12	Are you planning to have inflatable attractions, games or rides?	<input checked="" type="checkbox"/> Yes	<input type="checkbox"/> No
13	Will there be bleachers, stages, fencing or other structures?	<input type="checkbox"/> Yes	<input checked="" type="checkbox"/> No



14	Do you plan to provide portable toilets? * See Guidelines*	<input checked="" type="checkbox"/> Yes	<input type="checkbox"/> No
15	Will there be security staff?	<input checked="" type="checkbox"/> Yes	<input type="checkbox"/> No
16	Are you planning to have amplified sound?	<input checked="" type="checkbox"/> Yes	<input type="checkbox"/> No
17	Will you need access to power or water? (please circle)	<input checked="" type="checkbox"/> Yes	<input type="checkbox"/> No
18	Will there be any signs, banners, decorations, or special lighting?	<input checked="" type="checkbox"/> Yes	<input type="checkbox"/> No

1. If "Yes" is checked for any of the Event Detail questions, please refer to the Special Events Guidelines for instructions.
2. If police presence is required, contact Mandeville Police Department at (985) 626-9711 to reserve a Police Detail.
3. If alcohol is being served, please complete the City Liquor License Application and Appendix A to include with the application. The City permit is required to apply for the State permit.
4. A Site Plan MUST be included with the application illustrating a detailed layout of the event, showing the precise location of stages, tents, power, food vendors, alcohol sales, portable toilets, etc. Run/Walk events also require a detailed map indicating the route to be taken, where safety personnel will be stationed, and the location of temporary traffic control personnel (if applicable).

INSURANCE/INDEMNITY

The City of Mandeville requires a minimum \$1,000,000 liability insurance certificate with an insurer that is acceptable to the City of Mandeville, with an AA-@ or better rating, authorized to do business in the State of Louisiana, and naming the City of Mandeville as an additional insured. A copy of the Insurance Certificate is to be included as an attachment to this application. The Insurance Certificate must be submitted to the City Clerk no later than 30-days prior to the event in order for the Special Events Permit to be issued.

The Mayor of Mandeville has the right to revoke any permit application or permit. The applicant shall comply with all permit directions and conditions, and with applicable laws and ordinances. The event organizer or other authorized representative heading such activity shall carry the permit upon his person during the conduction of the event.

The undersigned applicant, by signature below, shall hold harmless the City of Mandeville, its officers, agents, and employees and shall indemnify and, if requested, defend the City, its officers, agents, and employees for any claim or injury to property or persons that may arise as a result of any activity which may arise from operations under or in connection with the permit.

The undersigned has read and submitted the completed application, including all required attachments and documentation. The applicant or applicant's representative has read the Special Events Guidelines and agrees to comply with the terms and conditions as defined therein. Failure to comply with these terms and conditions is subject to fines and penalties as set forth by City Ordinance.

Signed By: Sandy Luparello

Printed Name: Sandy Luparello

Organization Represented: MQP Co Op

Office Held Co Op President Date 10/10/24

Please email completed application to acasborne@cityofmandeville.com.

Thoroughly read the information outlined in the Special Events Guidelines and throughout this Application.



- DO NOT ENTER*
- CARLINE DROPOFF
- DO NOT ENTER
- *Aftercare pickup entry only
- NO PARKING
- DROPOFF/PICKUP ENTRY

City of Mandeville
3101 East Causeway Approach
Mandeville, Louisiana 70448
985-624-3147 985-624-3149 Fax

****SPECIAL EVENTS (3-DAY)****
LIQUOR LICENSE APPLICATION

1. Liquor license to be issued to: Mary Queen of Peace Catholic School
2. Legal name(s): Individual, Partners, or Corporation Mary Queen of Peace Catholic School
3. Apply for: Class "A" Class "B" / High Content Low Content / Restaurant
4. Business location address 1515 W. Causeway Approach, Mandeville
 Telephone (504) 416-5072 LA, 70471
5. Mailing address SAME
6. Contact Person SANDY LUPARELLO
 Phone Number (504) 416-5072 E-Mail Address: SANDYLUPE@Gmail.com
 Fax Number () _____ Web Address _____
7. Type of organization:
 Individual Partnership Corporation Non-Profit LLP LLC Other
(If individual complete line A only)
8. If a Corporation, LLC, LLP, or Partnership, supply name, title, social security #, home address and telephone # of all officers, members, managers, partners, agents or other representative.
 The list of names below should each furnish a notarized Schedule "A".

A	Name	Title	SSN	% Owned
	Resident Address	City State Zip	Home Phone Number	
	B. Name	Title	SSN	% Owned
	Resident Address	City State Zip	Home Phone Number	
	C. Name	Title	SSN	% Owned
	Resident Address	City State Zip	Home Phone Number	

9. Is this application by a new owner to take over an existing business that has been selling liquor regularly and continuously to the present time? NO If yes, list.

- | Trade name | Owner's name | address | License # |
|------------|--------------|---------|-----------|
| | | | |
10. Does applicant hold State or City of Mandeville liquor license for current year at any other location?
NO If yes: Name _____ Location: _____
 11. Has applicant applied for state liquor license? YES, for the day
 12. Has the applicant ever been denied a state or local liquor license? NO
 12. Is premise located in an area where the sale of liquor is prohibited by local or state laws? NO
 13. Is applicant the owner of the premises to be occupied? NO If no, does applicant hold a bona fide written lease? YES (Supply copy of lease with application.)
 14. If premises leased, give name and address of lesser. Donation from school
 15. Describe the part of the building to be occupied by business: outside field behind Church
 16. Open date for this location Nov 2, 2024
 17. Describe in detail your business. i.e.: Type of sales, activity, or service you perform:
Selling beer @ jambalaya cook off

An original approved Sales Tax Clearance Certificate must be attached to the application, requested from the St. Tammany Parish Sales Tax Department (form attached).

I affirm that the information given on this application is true and correct.

Signature of Applicant Sandy Suparello Title: 10/10/24
 Signature of Preparer Sandy Suparello Date: 10/10/24

Ord 24-36

THE FOLLOWING ORDINANCE WAS MOVED FOR INTRODUCTION BY COUNCIL MEMBER DISCON; SECONDED FOR INTRODUCTION BY COUNCIL MEMBER _____;

ORDINANCE NO. 24-36

AN ORDINANCE OF THE CITY COUNCIL OF THE CITY OF MANDEVILLE AMENDING THE JOB DESCRIPTION OF CULTURAL DEVELOPMENT CLERK II WITHIN THE CULTURAL DEVELOPMENT DEPARTMENT AND PROVIDING FOR OTHER MATTERS IN CONNECTION THEREWITH.

WHEREAS, Section 4-04 of the Mandeville City Charter mandates that the City Council introduce an ordinance upon receipt of the Mayor's proposed plan to create, change, alter, consolidate or abolish City departments, offices and agencies and/or the reallocation of the functions, powers, duties and responsibilities of such departments, offices or agencies.

WHEREAS, the Administration recommends to the City Council that it reallocate duties and responsibilities of the Cultural Development Clerk II position to reflect a change in the Cultural Development Department that has had a permanent and substantial effect on the assignment and scope of duties and responsibilities therein; and,

WHEREAS, the Municipal Employees' Civil Service Board recommends to the City Council that it reallocate duties and responsibilities of the Cultural Development Clerk II position to reflect a change in the Cultural Development Department that has had a permanent and substantial effect on the assignment and scope of duties and responsibilities therein.

NOW, THEREFORE, BE IT ORDAINED that the City Council of the City of Mandeville hereby amends the job description for the position of Cultural Development Clerk II within the Cultural Development Department as set forth in Exhibit "A" and made a part of this ordinance; and,

NOW THEREFORE, BE IT FURTHER ORDAINED that this ordinance shall be effective following the Mayor's signature; and,

NOW THEREFORE, BE IT FURTHER ORDAINED that the Clerk of this Council be and she is hereby authorized and empowered to take any and all actions which she, in the exercise of her discretion, deems necessary to promulgate the provisions of this ordinance.

The ordinance being submitted to a vote, the vote thereon was as follows:

AYES:

NAY:

ABSTENTIONS:

ABSENT:

and the ordinance was declared adopted this ____ Day of _____, 2024

Alicia Watts
Clerk of Council

Scott Discon
Council Chairman

SUBMITTAL TO MAYOR

The foregoing Ordinance was **SUBMITTED** by me to the Mayor of the City of Mandeville this ____ day of _____, 2024 at ____ o'clock __.m.

CLERK OF COUNCIL

APPROVAL OF ORDINANCE

The foregoing Ordinance is by me hereby **APPROVED**, this ____ day of _____, 2024 at ____ o'clock __.m.

L. Clay Madden, MAYOR

VETO OF ORDINANCE

The foregoing Ordinance is by me hereby **VETOED**, this ____ day of _____, 2024, at ____ o'clock __.m.

L. Clay Madden, MAYOR

RECEIPT FROM MAYOR

The foregoing Ordinance was **RECEIVED** by me from the Mayor of the City of Mandeville

this ____ day of _____, 2024 at ____ o'clock ____ .m.

CLERK OF COUNCIL

CERTIFICATE

I, THE UNDERSIGNED Clerk of the City Council of the City of Mandeville do hereby certify that the foregoing is a true and correct copy of an ordinance adopted by the City Council of the City of Mandeville at a duly noticed, called and convened meeting of said City Council held on the ____ day of _____, 2024 at which a quorum was present and voting. I do further certify that said Ordinance has not thereafter been altered, amended, rescinded, or repealed.

WITNESS MY HAND and the seal of the City of Mandeville this ____ day of _____, 20 ____.

CLERK OF COUNCIL

Exhibit A for Ord 24-XX
POSITION DESCRIPTION



CLASS TITLE:	Clerk II	DATE COMPLETED:	PENDING
FUNCTIONAL TITLE:	Cultural Development Clerk	FLSA STATUS:	NE
DEPARTMENT:	Cultural Development	CLASS NUMBER:	5
IMMEDIATE SUPERVISOR:	Cultural Development Director	JOB CODE:	0136

JOB FUNCTION:

The Cultural Development Clerk will perform routine clerical and administrative work in providing administrative support to the Cultural Development Director for the department’s day-to day operations and programs including typing, answering phones, filing, greeting Depot Museum guests and assisting with **City parks and** Trailhead events. These tasks are performed under the general supervision of the Cultural Development Director. Unusual situations or assignments may require detailed instructions and supervisory follow-up.

ESSENTIAL JOB FUNCTIONS:

- Performs routine clerical and administrative work in answering phones, receiving the public and providing customer assistance.
- Assists with Trailhead department events and communicates with other departments, when necessary, to fulfill requirements of cooperative endeavor agreements (i.e. Pelican Park, St. Tammany Art Association, etc.)
- **Maintains the schedule and assists with support at City recreational facilities.**
- Communicates with artists, collaborators, and other partners regarding department programs and initiatives.
- Composes, types, and edits a variety of correspondence, reports, databases, inventories, memoranda and press releases requiring judgment as to content, accuracy, and completeness.
- Assists with maintaining Mandeville Trailhead website, City’s Trailhead webpage and social media pages including email blasts and maintaining the email database.
- Maintains newspaper and magazine clippings, write-ups, pictures, etc.
- Receives, reviews, tracks and files special event applications.
- Responsible for the Trailhead meeting and field trip calendar.
- Performs other related duties as assigned.

MINIMUM REQUIRED KNOWLEDGE, SKILLS & ABILITIES:

- Skill in the operation of standard office machines, including personal computers, Microsoft Word, Excel and PowerPoint, calculator, telephone, copy and fax machine.
- Excellent writing, editing and communication skills.
- Ability to problem-solve, meet deadlines, manage multiple tasks simultaneously & prioritize.
- Extensive knowledge of office practices and procedures.
- Ability to maintain effective working relations with employees, other departments, officials and the public
- Ability to maintain accurate records
- Ability to type and enter data accurately.
- Ability to handle stressful situations in an appropriate and professional manner.
- **Ability to work flexible hours, including mornings, evenings, nights, and weekends.**

MINIMUM REQUIRED EDUCATION & EXPERIENCE:

- Graduation from high school or GED equivalent; bachelor's degree in business management, marketing or closely related field preferred, and
- Two (2) years of related experience; or
- Any equivalent combination of education and progressively responsible experience.

ESSENTIAL MENTAL & PHYSICAL REQUIREMENTS:

The physical demands described here are representative of those that must be met by an employee to successfully perform the essential functions of this job. Reasonable accommodation may be made to enable qualified individuals with disabilities to perform the essential functions.

- Ability to operate a keyboard if required to perform the essential job functions.
- Ability to read and interpret a document.
- Ability to sit and talk and hear.
- Ability to use hands to finger, handle or operate objects, tools, or controls.
- Ability to reach with hands and arms.
- Ability to view objects at close vision and to adjust focus.
- Ability to lift/move/carry approximately 20 pounds if required to perform the essential job functions. If the employee is unable to lift/move/carry this weight and can be accommodated without causing the department/division an "undue hardship" then the employee must be accommodated; hence omitting lifting/moving/carrying as a physical requirement.

WORK ENVIRONMENT:

While the work environment described here are representative of those an employee encounters while performing the essential job functions of this job, reasonable accommodations may be made to enable individuals with disabilities to perform the essential functions.

- While performing the duties of this job, the employee often works in outside weather conditions
- The noise level in the work environment is light to moderate in the office and moderate to loud in the field.

The duties listed above are intended only as illustrations of the various types of work that may be performed. The omission of specific statements of duties does not exclude them from the position if the work is similar, related or a logical assignment to the position.

The job description does not constitute an employment agreement between the employer and employee and is subject to change by the employer as the needs of the employer and requirements of the job change.

Ord 24-37

THE FOLLOWING RESOLUTION WAS INTRODUCED BY COUNCIL MEMBER ZUCKERMAN AND SECONDED FOR INTRODUCTION BY COUNCIL MEMBER

_____.

ORDINANCE NO. 24-37

AN ORDINANCE OF THE CITY COUNCIL OF THE CITY OF MANDEVILLE TO AMEND ORDINANCE NO. 24-23, THE CAPITAL BUDGET OF THE CITY OF MANDEVILLE AND FOR OTHER MATTERS IN CONNECTION THEREWITH.

WHEREAS, Article V, Section D Financial Procedures of the Home Rule Charter provides that amendments to the adopted budget may be made by ordinance; and,

WHEREAS, an amendment to the Capital Budget adopted for fiscal year 2024-2025, Ordinance Number 24-23, is required due to expenditures that will exceed the current authorized appropriated funds budgeted for 2024-2023 City of Mandeville Capital Budget; and

NOW, THEREFORE, BE IT ORDAINED by the City Council of the City of Mandeville that the Capital Budget ordinance for fiscal year 2024-2025, Ordinance Number 24-23, is hereby amended to include the budget amendments as set forth on the attached Exhibit A – FY 2025 Budget Amendment #3, incorporated as a part hereof, and be adopted for the 2024-2025 Fiscal Year Capital Budget.

BE IT FURTHER ORDAINED, that in all other respects the 2024-2025 Capital Budget adopted shall remain in full force and effect.

With the above resolution having been properly introduced and duly seconded, the vote was as follows:

AYES:

NAYS:

ABSTENTIONS:

ABSENT:

and the resolution was declared adopted this _____ day of October, 2024.

Alicia Watts
Clerk of Council

Scott Discon
Council Chairman

FY 2025 Budget Amendment #2
Exhibit A

		Current Budget	Proposed Change	Revised Budget	Project Name	Project Number
<u>General Fund</u>						
<i>Expenditures</i>						
10100-88000	Capital Outlay	8,375,000	2,860,000	11,235,000	New Park Design	100.25.001

Ord 24-38

THE FOLLOWING RESOLUTION WAS INTRODUCED BY COUNCIL MEMBER ZUCKERMAN AND SECONDED FOR INTRODUCTION BY COUNCIL MEMBER

_____.

ORDINANCE NO. 24-38

AN ORDINANCE OF THE CITY COUNCIL OF THE CITY OF MANDEVILLE TO AMEND ORDINANCE NO. 24-22, THE OPERATING BUDGET OF THE CITY OF MANDEVILLE AND FOR OTHER MATTERS IN CONNECTION THEREWITH.

WHEREAS, Article V, Section D Financial Procedures of the Home Rule Charter provides that amendments to the adopted budget may be made by ordinance; and,

WHEREAS, an amendment to the Operating Budget adopted for fiscal year 2024-2025, Ordinance Number 24-22, is required due to expenditures that will exceed the current authorized appropriated funds budgeted for 2024-2023 City of Mandeville Capital Budget; and

NOW, THEREFORE, BE IT ORDAINED by the City Council of the City of Mandeville that the Operating Budget ordinance for fiscal year 2024-2025, Ordinance Number 24-22, is hereby amended to include the budget amendments as set forth on the attached Exhibit A – FY 2025 Budget Amendment #2, incorporated as a part hereof, and be adopted for the 2024-2025 Fiscal Year Operating Budget.

BE IT FURTHER ORDAINED, that in all other respects the 2024-2025 Operating Budget adopted shall remain in full force and effect.

With the above resolution having been properly introduced and duly seconded, the vote was as follows:

AYES:

NAYS:

ABSTENTIONS:

ABSENT:

and the resolution was declared adopted this _____ day of October, 2024.

Alicia Watts
Clerk of Council

Scott Discon
Council Chairman

FY 2025 Budget Amendment #3
Exhibit A

		Current Budget	Proposed Change	Revised Budget
<u>General Fund</u>				
<i>Revenues</i>				
10000-30000	Ad Valorem Taxes	(2,143,183)	146,713	(1,996,470)

Substantial Completion Roadway and Drainage



DIGITAL ENGINEERING & IMAGING, INC.

October 14, 2024

City of Mandeville
3101 East Causeway Approach
Mandeville, LA 70448
Attn: City Council Members

Re: 2022 Roadway & Drainage Maintenance Contract
City Project No. 700.22.003
Task Orders 6, 7 & 8 – Substantial Completion

Ladies and Gentlemen,

Digital Engineering has verified contract work has been completed and recommends substantial completion for Task Orders 6, 7 & 8 of the 2022 Roadway & Drainage Maintenance Contract. If you have any questions or concerns, please do not hesitate to call.

Sincerely,

DIGITAL ENGINEERING AND IMAGING, INC.

A handwritten signature in blue ink, appearing to read 'John P. Ritchie, Jr.', is positioned above the typed name.

John P. Ritchie, Jr.
Project Administrator

Enclosure: Creek Construction, LLC
Task Order 6, 7 & 8 Certificates of Substantial Completion

SECTION 00625
Certificate of Substantial Completion

Project: 2022 Roadway Maintenance Contract

Owner: City of Mandeville

Owner's Contract No.: 700.22.003

Contractor: Creek Construction, LLC

Engineer's Project No.: 576-2003.01

This definitive Certificate of Substantial Completion applies to:

- All Work under the Contract Documents: The following specified portions of the Work:

Task Order 6

May 13, 2024

Date of Substantial Completion

The Work to which this Certificate applies has been inspected by authorized representatives of Owner, Contractor, and Engineer, and found to be substantially complete. The Date of Substantial Completion of the Project or portion thereof designated above is hereby declared and is also the date of commencement of applicable warranties required by the Contract Documents, except as stated below.

A definitive list of items to be completed or corrected is attached hereto. This list may not be all-inclusive, and the failure to include any items on such list does not alter the responsibility of the Contractor to complete all Work in accordance with the Contract Documents.

The responsibilities between Owner and Contractor for security, operation, safety, maintenance, heat, utilities, insurance and warranties shall be as provided in the Contract Documents except as amended as follows:

- Amended Responsibilities Not Amended

Owner's Amended Responsibilities:

Contractor's Amended Responsibilities:

The following documents are attached to and made part of this Certificate:

Punch List

This Certificate does not constitute an acceptance of Work not in accordance with the Contract Documents nor is it a release of Contractor's obligation to complete the Work in accordance with the Contract Documents.

Executed by Engineer

Date

Accepted by Contractor

Date

Accepted by Owner

Date

Punch List:

All Punch List items pertaining to Task Order 6 have been completed throughout the task order. This includes Monroe St. sidewalk repairs, Albert and Montgomery drainage, asphalt patching in Old Mandeville, concrete panel replacement, and sodding of various areas.

SECTION 00625
Certificate of Substantial Completion

Project: 2022 Roadway Maintenance Contract

Owner: City of Mandeville

Owner's Contract No.: 700.22.003

Contractor: Creek Construction, LLC

Engineer's Project No.: 576-2003.01

This definitive Certificate of Substantial Completion applies to:

- All Work under the Contract Documents: The following specified portions of the Work:

Task Order 7

July 11, 2024

Date of Substantial Completion

The Work to which this Certificate applies has been inspected by authorized representatives of Owner, Contractor, and Engineer, and found to be substantially complete. The Date of Substantial Completion of the Project or portion thereof designated above is hereby declared and is also the date of commencement of applicable warranties required by the Contract Documents, except as stated below.

A definitive list of items to be completed or corrected is attached hereto. This list may not be all-inclusive, and the failure to include any items on such list does not alter the responsibility of the Contractor to complete all Work in accordance with the Contract Documents.

The responsibilities between Owner and Contractor for security, operation, safety, maintenance, heat, utilities, insurance and warranties shall be as provided in the Contract Documents except as amended as follows:

- Amended Responsibilities Not Amended

Owner's Amended Responsibilities:

Contractor's Amended Responsibilities:

The following documents are attached to and made part of this Certificate:

Punch List

This Certificate does not constitute an acceptance of Work not in accordance with the Contract Documents nor is it a release of Contractor's obligation to complete the Work in accordance with the Contract Documents.

Executed by Engineer

Date

Accepted by Contractor

Date

Accepted by Owner

Date

Punch List:

All Punch List items pertaining to Task Order 7 have been completed throughout the task order. This includes Old Mandeville sidewalk repairs, Fontainebleau subdivision collar and drain line repairs, miscellaneous asphalt patching, removal and replacement of drain lines and driveway apron repairs.

SECTION 00625
Certificate of Substantial Completion

Project: 2022 Roadway Maintenance Contract

Owner: City of Mandeville

Owner's Contract No.: 700.22.003

Contractor: Creek Construction, LLC

Engineer's Project No.: 576-2003.01

This definitive Certificate of Substantial Completion applies to:

- All Work under the Contract Documents: The following specified portions of the Work:

Task Order 8

August 13, 2024

Date of Substantial Completion

The Work to which this Certificate applies has been inspected by authorized representatives of Owner, Contractor, and Engineer, and found to be substantially complete. The Date of Substantial Completion of the Project or portion thereof designated above is hereby declared and is also the date of commencement of applicable warranties required by the Contract Documents, except as stated below.

A definitive list of items to be completed or corrected is attached hereto. This list may not be all-inclusive, and the failure to include any items on such list does not alter the responsibility of the Contractor to complete all Work in accordance with the Contract Documents.

The responsibilities between Owner and Contractor for security, operation, safety, maintenance, heat, utilities, insurance and warranties shall be as provided in the Contract Documents except as amended as follows:

- Amended Responsibilities Not Amended

Owner's Amended Responsibilities:

Contractor's Amended Responsibilities:

The following documents are attached to and made part of this Certificate:

Punch List

This Certificate does not constitute an acceptance of Work not in accordance with the Contract Documents nor is it a release of Contractor's obligation to complete the Work in accordance with the Contract Documents.

Executed by Engineer

Date

Accepted by Contractor

Date

Accepted by Owner

Date

Punch List:

All Punch List items pertaining to Task Order 8 have been completed throughout the task order. This includes pond embankment, aggregate path restoration, ditch clearing, drainage erosion control (rip rap), sodding, and other associated incidentals for the Fontainebleau Pond.

Change order #1

KVS architecture

235 Girod Street, Mandeville, Louisiana
985.674.3077 www.kvsarchitecture.com

October 10, 2024

David G. LeBreton, Jr., P.E., PTOE, PTP
Digital Engineering - City of Mandeville
dlebreton@deii.net
504-430-0658

Cara Bartholomew, AICP
Director, Dept. of Planning & Development
City of Mandeville
cbartholomew@cityofmandeville.com
985-624-3103

Harbor Field Upgrades – CHANGE ORDER #1

Dear David and Cara,

#1. Costs associated with Cleco removal of electrical service meter & pole, and for Cleco relocation of underground electrical service line. Time delay, General Conditions. ADD \$ 10,658.00 and ADD 87 (eighty-seven) calendar days.

#2. Costs associated with the installation of a new 2'x2'x2' catch basin including masonry work, installation of additional A-2000 drain line & additional building grouting. ADD \$ 4,958.00 and ADD 0 (zero) calendar days.

#3. Costs associated with the installation of a new ball field irrigation system. ADD \$ 16,271.00 and ADD 0 (zero) calendar days.

#4. Costs associated with the installation of a hard shell insulation box for the required backflow preventer. ADD \$ 880.00 and ADD 0 (zero) calendar days.

#5 Credit for tree trimming service by City. DEDUCT \$ 1,000.00 and DEDUCT 0 (zero) calendar days.

TOTAL CHANGES TO THE CONTRACT: ADD \$ 31,767.00 and ADD 87 (EIGHTY-SEVEN) CALENDAR DAYS.

The project is complete and no additional Change Requests have been submitted. Please let us know if you have any questions.

Sincerely,

A handwritten signature in black ink, appearing to be 'KVS', written in a cursive style.

K. Vaughan Sollberger, Jr., Architect
kvs@kvsarchitecture.com

**SECTION 00650
CHANGE ORDER**

No. One

Date of Issuance: October 10, 2024 Effective Date: August 22, 2024

Owner: City of Mandeville	Owner's Contract No.: 100.21.002
Contract: Harbor Field Upgrades	Date of Contract: August 12, 2023
Contractor: BSD Construction	Engineer's Project No.: 20040

The Contract Documents are modified as follows upon execution of this Change Order:

Description:

General: Add 87 calendar days for delays due to Cleco removal of electrical service meter & pole, and for Cleco relocation of electrical service line.

- #1 Additional General Conditions for delay days shut down due to Cleco power relocation. (\$10,658.00)
- #2 Installation of a new 2X2 catch basin including masonry work, installation of additional A-2000 drain line & additional building grouting. (\$4,958.00)
- #3 Installation of a new ball field irrigation system. (\$16,271.00)
- #4 Installation of a hard shell insulation box for backflow preventer. (\$880.00)
- #5 Credit for tree trimming service by City. (-\$1,000.00)

Attachments (list documents supporting change):

Change Order No. 1 Package & Architect cover letter.

CHANGE IN CONTRACT PRICE:

CHANGE IN CONTRACT TIMES:

<p>Original Contract Price:</p> <p style="margin-left: 20px;">\$ <u>1,375,000.00</u></p> <p>[Increase] [Decrease] from previously approved Change Orders No. _____ to No. _____:</p> <p style="margin-left: 20px;">\$ <u>n/a</u></p> <p>Contract Price prior to this Change Order:</p> <p style="margin-left: 20px;">\$ <u>1,375,000.00</u></p> <p>[Increase] [Decrease] of this Change Order:</p> <p style="margin-left: 20px;">\$ <u>31,767.00.00</u></p> <p>Contract Price incorporating this Change Order:</p> <p style="margin-left: 20px;">\$ <u>1,406,767.00</u></p>	<p>Original Contract Times: <input type="checkbox"/> Working days <input checked="" type="checkbox"/> Calendar days</p> <p>Substantial completion (days or date): <u>240 days</u></p> <p>Ready for final payment (days or date): _____</p> <p>[Increase] [Decrease] from previously approved Change Orders No. _____ to No. _____:</p> <p>Substantial completion (days): <u>n/a</u></p> <p>Ready for final payment (days): _____</p> <p>Contract Times prior to this Change Order:</p> <p>Substantial completion (days or date): <u>240 days</u></p> <p>Ready for final payment (days or date): _____</p> <p>[Increase] [Decrease] of this Change Order:</p> <p>Substantial completion (days or date): <u>87 days</u></p> <p>Ready for final payment (days or date): _____</p> <p>Contract Times with all approved Change Orders:</p> <p>Substantial completion (days or date): <u>327 days</u></p> <p>Ready for final payment (days or date): _____</p>
--	---

RECOMMENDED:

By: _____
Architect (Authorized Signature)

Date: October 10, 2024

Approved by Funding Agency (if applicable):

ACCEPTED:

By: _____
Owner (Authorized Signature)

Date: _____

ACCEPTED:

By: _____
Contractor (Authorized Signature)

Date: 10-10-24

Date: _____

Harbor Fields

Work Sheet #1

CONSTRUCTION CONTRACT CHANGE ORDER SUMMARY

Description General Conditions for 36 days of shut down due to Cleco electrical service relocation

OF WORK 36 Days @ 293.50 = \$10566.00

Per original SOV's General Conditions Line item No.3 - \$70,441.63 divided by contract schedule of 240 days + 293.50 per day.

General Conditions consist of the following:

Electricity (Temp Pole), Construction Fencing, Storage Container, Dumpster Container, Restroom

Container, Construction Site Checks (Foreman jobsite visits while job is on standby)

See below for detailed breakdown of costs

A. DIRECT COST OF WORK:

1. GENERAL CONDITIONS

<u>GENERAL CONDITIONS</u>		TOTAL COST
	ADD GENERAL CONDITIONS	\$10,566
	TOTAL	\$10,566

2. LABOR

ASSIGNED PERSONNEL OF WORK CR	HOURLY WAGE RATE PAID	HOURS WORKED	TOTAL COST
Working Foreman (3 hours per day for 36 days)	38.37	108	\$4,144
Clerical	25.00	18	\$450
Project Manager	33.65	6	\$201
	ADD LABOR BURDEN @	26%	\$1,247
		LABOR TOTAL	\$6,042

3. MATERIAL

MATERIAL REQUIRED FOR CHANGE	UNIT PRICE	REQUIRED UNITS	TOTAL COST
			\$0
			\$0
		MATERIAL TOTAL	\$0

4. EQUIPMENT

EQUIPMENT REQUIRED FOR CHANGE	UNIT PRICE	REQUIRED UNITS	TOTAL COST
Electricity (Temp Pole)	2.60 per day @ 36 days	1	\$93
Construction Fencing Fee	75.00 per day @ 36 days	1	\$2,700
Storage Container Fee	23.83 per day @ 36 days	1	\$858
Dumpster Container Fee	13.16 per day @ 36 days	1	\$474
Restroom Container Fee	11.10 per day @ 36 days	1	\$400
		EQUIPMENT TOTAL	\$4,524

DIRECT COST (Sum A 1,2,3,4)	\$0
TOTAL	\$10,566

TOTAL	\$0
Subcontractors Overhead and Profit on Direct Cost (Sum B 1,2,3)	
Contractor's 8% Overhead and Profit on Direct Cost (Sum B 1,2,3 x 9%)	

C. BOND PREMIUMS (Total Contractor and Subcontractor Cost) 0.87 % **\$92**

TOTAL COST OF PROPOSED CHANGE ORDER ITEM **\$10,658**

TOTAL CONTRACT DAYS ADDED TO THE PROJECT SCHEDULE **0**

Harbor Fields

Work Sheet #2

CONSTRUCTION CONTRACT CHANGE ORDER SUMMARY

Description OF WORK The original catch basin utilized concrete pipes, which created a conflict with the newly designed tie-in for the drainage system. A new 2x2 catch basin was installed along with a 15" A-2000 PVC pipe, which was purchased, installed and grouted to complete the drainage system. The new PVC pipe replaces the existing concrete piping that caused a conflict with the new tie-in connection. The installation includes excavation, placement of the catch basin, and proper grouting to ensure a secure fit and water tight connection between new drainage components. It provides better compatibility and long term performance for the updated system. (Work performed by Delta Construction)

Additional brick was installed around catch basin to enhance structural integrity and aesthetics. In addition, grouting was applied around the building, including all capstone locations, to ensure proper sealing, durability and a uniform appearance. (Work performed by BSD Construction)

A. DIRECT COST OF WORK:

1. GENERAL CONDITIONS

		TOTAL COST
	ADD GENERAL CONDITIONS	
	TOTAL	\$0

2. LABOR

ASSIGNED PERSONNEL OF WORK CR	HOURLY WAGE RATE PAID	HOURS WORKED	TOTAL COST
Extra mason work			
2men 10hours each @ 30 per hour	30	20	\$600
Working Foreman	38.37	1.5	\$58
	ADD LABOR BURDEN @	26%	\$172
	LABOR TOTAL		\$830

3. MATERIAL

MATERIAL REQUIRED FOR CHANGE	UNIT PRICE	REQUIRED UNITS	TOTAL COST
			\$0
			\$0
			\$0
			\$0
		MATERIAL TOTAL	\$0

4. EQUIPMENT

EQUIPMENT REQUIRED FOR CHANGE	UNIT PRICE	REQUIRED UNITS	TOTAL COST
			\$0
			\$0
		EQUIPMENT TOTAL	\$0

DIRECT COST (Sum A 1,2,3,4) \$0
 TOTAL \$830

B. SUBCONTRACTOR'S DIRECT COST:

1. Direct Labor & Materials

Delta Construction including materials	\$3,750	
TOTAL	\$3,750	
Subcontractors Overhead and Profit on Direct Cost (Sum B 1,2,3)		\$3,750
Contractor's 9% Overhead and Profit on Direct Cost (Sum B 1,2,3 x 9%)		\$338

C. BOND PREMIUMS (Total Contractor and Subcontractor Cost)

0.0087 % \$40

TOTAL COST OF PROPOSED CHANGE ORDER ITEM \$4,958

TOTAL CONTRACT DAYS ADDED TO THE PROJECT SCHEDULE 0

**Delta Construction and Land
Development**
Larry Aleman

Invoice	338
Date	03 Sep 2024
Due Date	03 Sep 2024
Terms	

Bill To:

Ship To:

BSD

Harbor Field
Change Order

BSD

Description	Quantity	Price	Amount
2X2 Catch Basin Grate and Casting Purchased and Installed	1	USD 3,050.00	USD 3,050.00
15" A-2000 Purchased and Installed	20	USD 35.00	USD 700.00

Thank you for your business!

Subtotal	USD 3,750.00
Total	USD 3,750.00

Work Sheet #3

CONSTRUCTION CONTRACT CHANGE ORDER SUMMARY

Description Per owner's request, a new irrigation system was installed to provide coverage for all
 OF WORK newly planted grass in the infield, as well as the newly installed landscaping around
the ball field. The system included sprinkler heads, piping, valves and a controller to efficiently manage
water use, monimizing waste while wnsuring proper irrigations. (Work performed by Acadian Landscap
Acadian Landscape Invoice & As Built Plan of Irrigation System Attached

A. DIRECT COST OF WORK:

1. GENERAL CONDITIONS

		TOTAL COST
_____	ADD GENERAL CONDITIONS	
	TOTAL	\$0

2. LABOR

ASSIGNED PERSONNEL OF WORK CR	HOURLY WAGE RATE PAID	HOURS WORKED	TOTAL COST
_____	_____	_____	_____
_____	_____	_____	_____
_____	_____	_____	_____
	ADD LABOR BURDEN %		
	LABOR TOTAL		\$0

3. MATERIAL

MATERIAL REQUIRED FOR CHANGE	UNIT PRICE	REQUIRED UNITS	TOTAL COST
_____	_____	_____	_____
_____	_____	_____	_____
_____	_____	_____	_____
	MATERIAL TOTAL		\$0

4. EQUIPMENT

EQUIPMENT REQUIRED FOR CHANGI	UNIT PRICE	REQUIRED UNITS	TOTAL COST
_____	_____	_____	_____
	EQUIPMENT TOTAL		\$0

DIRECT COST (Sum A 1,2,3,4) **\$0**
 TOTAL **\$0**

B. SUBCONTRACTOR'S DIRECT COST:

1. Direct Labor + Materials

Acadian Landscape **\$14,799**

 TOTAL **\$14,799**

Subcontractors 9% Overhead and Profit on Direct Cost (Sum B 1,2,3) **\$14,799**
 Contractor's 9% Overhead and Profit on Direct Cost (Sum B 1,2,3 x 9%) **\$1,332**

C. BOND PREMIUMS (Total Contractor and Subcontractor Cost) **0.87** % **\$140**

TOTAL COST OF PROPOSED CHANGE ORDER ITEM **\$16,271**

TOTAL CONTRACT DAYS ADDED TO THE PROJECT SCHEDULE **0**



Acadian Landscape of Louisiana Inc

22155 Prats Road Abita Springs, LA. 70420

8/14/2024

Job: Harbor Field Upgrades
200 Jackson Ave, Mandeville 70448

INVOICE

1	Irrigation System (Design/Build)	LS	\$ 14,799.00	\$ 14,799.00
				<u>\$ 14,799.00</u>

1. The design of the Harbor Field Key Planting Plan is based on the following assumptions:
 2. The design is based on the current site conditions and the proposed improvements.
 3. The design is based on the current site conditions and the proposed improvements.
 4. The design is based on the current site conditions and the proposed improvements.
 5. The design is based on the current site conditions and the proposed improvements.

Zone 1
 Zone 2
 Zone 4
 Zone 6
 Zone 6
 Zone 6
 Zone 8
 Zone 8
 Zone 9
 Zone 10

- KEY
- LANDSCAPE BED
 - TURF GRASS
 - PAVEMENT

APPROXIMATE LANDSCAPE BED
 225 TOTAL SQUARE FEET TURF GRASS
 190 TOTAL SQUARE FEET PAVEMENT

1 HARBOR FIELD KEY PLANTING PLAN
 SCALE: 1/16"=1'

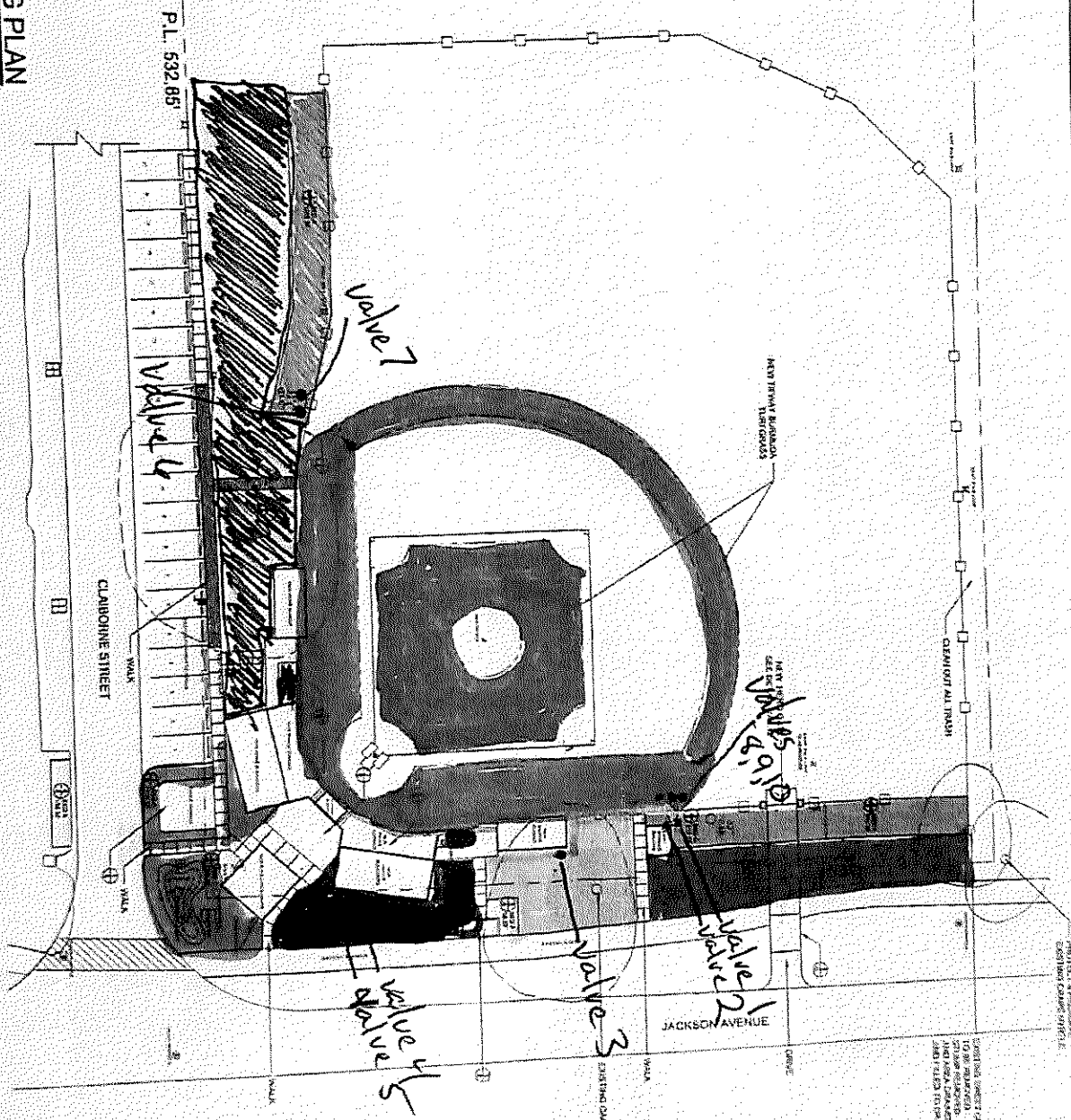

DATE	3.22.22
SHEET NO.	00040
PROJECT	LA-1

HARBOR FIELD UPGRADES
 200 JACKSON AVENUE, MANDEVILLE, LA 70448



KVS
 architecture
 215 Girod Street, Mandeville, Louisiana
 981.674.3077 www.kvsarchitecture.com

CONSTRUCTION CONTRACT CHANGE ORDER SUMMARY

Descriptor **Hard shell insulation box for backflow preventer. (Worked performed by Gulf Mechanical)**
OF WORK **Gulf Mechanical Quote Attached**

A. DIRECT COST OF WORK:

1. GENERAL CONDITIONS

GENERAL CONDITIONS

ADD GENERAL CONDITIONS

TOTAL

TOTAL COST

\$0

2. LABOR

ASSIGNED PERSONNEL OF WORK CREWS

HOURLY WAGE RATE PAID

HOURS WORKED

TOTAL COST

ADD LABOR BURDEN %

LABOR TOTAL

\$0

3. MATERIAL

MATERIAL REQUIRED FOR CHANGE

UNIT PRICE

REQUIRED UNITS

TOTAL COST

MATERIAL TOTAL

\$0

4. EQUIPMENT

EQUIPMENT REQUIRED FOR CHANGE

UNIT PRICE

REQUIRED UNITS

TOTAL COST

EQUIPMENT TOTAL

\$0

DIRECT COST (Sum A 1,2,3,4)

TOTAL

\$0

\$0

B. SUBCONTRACTOR'S DIRECT COST:

1. Direct Labor - Materials

Gulf Mechanical

\$800

TOTAL

\$800

Subcontractors 9% Overhead and Profit on Direct Cost

(Sum B 1,2,3 x 9%)

\$800

Contractor's 9% Overhead and Profit on Direct Cost

(Sum B 1,2,3 x 9%)

\$72

C. BOND PREMIUMS (Total Contractor and Subcontractor Cost)

0.87 %

\$8

TOTAL COST OF PROPOSED CHANGE ORDER ITEM

\$880

TOTAL CONTRACT DAYS ADDED TO THE PROJECT SCHEDULE

0



PROPOSAL

To: BSD

Date: October 4, 2024
Job: Harbor Field BEP
Mandeville, LA

We submit ESTIMATES for Backflow Preventor Insulation only per email dated 10/3/24.

INCLUDES:

Furnish and install gray PVC jacket insulation to existing backflow preventor.

EXCLUSIONS AND/OR CLARIFICATIONS:

We **EXCLUDE** all saw cut, break, removal, or patching of concrete/asphalt.

We **EXCLUDE** all cutting and patching.

We **EXCLUDE** all form and pour of concrete.

We **EXCLUDE** all demo.

We **EXCLUDE** all water meters, sewer connection fees, tap fees, impact fees, deposit, etc.

We **EXCLUDE** all sprinkler systems.

We **EXCLUDE** all fire caulking or fire stopping.

We **EXCLUDE** all electrical source and connection, including heat trace.

We **EXCLUDE** all painting or painting prep work.

We **EXCLUDE** excess liability coverage in excess of \$2,000,000.00.

We **EXCLUDE** performance bond.

We **EXCLUDE** all Engineering fees, plans or stamps.

BID: Eight hundred dollars

\$800.00

Prepared by: Trey Blackall/Carla Alexander carla@gulfmechanical.com

Due to the recent volatility in the piping markets, this price may only be good for 30 days.

Gulf Mechanical, Inc.
10000 W. BRADLEY BLVD.
SUITE 1000
DALLAS, TEXAS 75241
TEL: 972.412.1111

CONSTRUCTION CONTRACT CHANGE ORDER SUMMARY

Description **Credit for tree trimming**
OF WORK

A. DIRECT COST OF WORK:

1. GENERAL CONDITIONS

		TOTAL COST
	ADD GENERAL CONDITIONS	
	TOTAL	\$0

2. LABOR

ASSIGNED PERSONNEL OF WORK CR	HOURLY WAGE RATE PAID	HOURS WORKED	TOTAL COST
	ADD LABOR BURDEN @		
	LABOR TOTAL		\$0

3. MATERIAL

MATERIAL REQUIRED FOR CHANGE	UNIT PRICE	REQUIRED UNITS	TOTAL COST
		MATERIAL TOTAL	\$0

4. EQUIPMENT

EQUIPMENT REQUIRED FOR CHANGE	UNIT PRICE	REQUIRED UNITS	TOTAL COST
			\$0
		EQUIPMENT TOTAL	\$0

DIRECT COST (Sum A 1,2,3,4)	\$0
TOTAL	\$0

B. SUBCONTRACTOR'S DIRECT COST:

1. Direct Labor / Materials

Tree Trimming (Credit)	(\$1,000.00)
TOTAL	(\$1,000.00)

Subcontractors Overhead and Profit on Direct Cost (Sum B 1,2,3)	(\$1,000.00)
Contractor's 9% Overhead and Profit on Direct Cost (Sum B 1,2,3 x 9%)	N/A

C. BOND PREMIUMS (Total Contractor and Subcontractor Cost) _____ %

TOTAL COST OF PROPOSED CHANGE ORDER ITEM **(\$1,000.00)**

TOTAL CONTRACT DAYS ADDED TO THE PROJECT SCHEDULE **0**

Ord 24-39

THE FOLLOWING RESOLUTION WAS INTRODUCED BY COUNCIL MEMBER DISCON AND SECONDED FOR INTRODUCTION BY COUNCIL MEMBER _____.

ORDINANCE NO. 24- 39

AN ORDINANCE OF THE CITY COUNCIL OF THE CITY OF MANDEVILLE TO AMEND ORDINANCE NO. 24-23, THE CAPITAL BUDGET OF THE CITY OF MANDEVILLE AND FOR OTHER MATTERS IN CONNECTION THEREWITH.

WHEREAS, Article V, Section D Financial Procedures of the Home Rule Charter provides that amendments to the adopted budget may be made by ordinance; and,

WHEREAS, an amendment to the Capital Budget adopted for fiscal year 2024-2025, Ordinance Number 24-23, is required due to expenditures that will exceed the current authorized appropriated funds budgeted for 2024-2023 City of Mandeville Capital Budget; and

NOW, THEREFORE, BE IT ORDAINED by the City Council of the City of Mandeville that the Capital Budget ordinance for fiscal year 2024-2025, Ordinance Number 24-23, is hereby amended to include the budget amendments as set forth on the attached Exhibit A – FY 2025 Budget Amendment #4, incorporated as a part hereof, and be adopted for the 2024-2025 Fiscal Year Capital Budget.

BE IT FURTHER ORDAINED, that in all other respects the 2024-2025 Capital Budget adopted shall remain in full force and effect.

With the above resolution having been properly introduced and duly seconded, the vote was as follows:

AYES:

NAYS:

ABSTENTIONS:

ABSENT:

and the resolution was declared adopted this _____ day of October, 2024.

Alicia Watts
Clerk of Council

Scott Discon
Council Chairman

FY 2025 Budget Amendment #4 - Capital
Exhibit A

		Current Budget	Proposed Change	Revised Budget	Project Name	Project Number
<u>General Fund</u>						
10100-88000	Capital Outlay	8,375,000	100,000	8,475,000		
					Harbor Gazebo Improvements	100.23.002
10120-88000	Capital Outlay	455,000	-	455,000		
		125,000	(24,363)	100,637	75 JD Excavator	120.25.001
		100,000	(15,637)	84,363	Brush Chipper 1500 Vermeer	120.25.002
		90,000	(10,000)	80,000	Boom Mower John Deere 5105M	120.25.005
		50,000	50,000	100,000	Rotary Mower 60"	120.25.006

Resolution 24-62

THE FOLLOWING RESOLUTION WAS INTRODUCED BY COUNCIL MEMBER DISCON AND SECONDED FOR INTRODUCTION BY COUNCIL MEMBER _____

RESOLUTION NO. 24-62

A RESOLUTION OF THE CITY COUNCIL OF THE CITY OF MANDEVILLE ACCEPTING THE BIDS FOR THE SEWER AND WATER MAINTENANCE PROJECT AND AUTHORIZING THE MAYOR TO EXECUTE A CONTRACT WITH THE APPARENT LOW BIDDER, SUBTERRANEAN CONSTRUCTION, LLC. AND PROVIDING FOR OTHER MATTERS IN CONNECTION THEREWITH.

WHEREAS the City of Mandeville advertised for bids for the 2024 Sewer & Water Maintenance Project, City Project Nos. 211.21.003 and 212.21.003;

WHEREAS the City received two bids for the 2024 Sewer & Water Maintenance Project. The city operates under Louisiana Revised Statute 48:252, which states that the low base bid dictates the project award; and

WHEREAS Digital Engineering & Imaging, Inc., as the engineer professional, has reviewed the bids on the above referenced project. The lowest bidder was Subterranean Construction, LLC. Based upon the Revised Statutes under which the City operates, the engineer professional recommends awarding the contract to Subterranean Construction, LLC.; and

NOW, THEREFORE, BE IT RESOLVED, by the City Council of the City of Mandeville in regular session assembled on the ___ day of October 2024 acting pursuant to the recommendation of the Project's design professional, that the base bid in the amount of \$8,750,360.00 be accepted from Subterranean Construction, LLC.

BE IT FURTHER RESOLVED that the City Council of the City of Mandeville hereby authorizes the mayor to execute a contract between the City of Mandeville and Subterranean Construction, LLC, attached hereto and made a part of this resolution hereto. **With the above resolution having been properly introduced and duly seconded, the vote was as follows:**

AYES:

NAYS:

ABSENT:

ABSTENTIONS:

and the Resolution was declared adopted this ___ the day of October 2024.

Alicia Watts
Clerk of Council

Scott Discon
Council Chairman

SECTION 00520 – AGREEMENT

THIS AGREEMENT is by and between City of Mandeville (“Owner” or “City”)

AND

Subterranean Construction, LLC (“Contractor”).

Owner and Contractor hereby agree as follows:

ARTICLE 1 – WORK

- 1.01 Contractor shall complete all Work as specified or indicated in the Contract Documents. The Work is generally described as follows: Provide maintenance to the City of Mandeville sewer and water systems as directed. This may include, but is not limited to: repair and/or replacement of sewer water mains, service connections, manholes, and fire hydrants. The total value of this contract (combined value of task orders) will not exceed \$4,000,000. No minimum value is guaranteed.
- 1.02 The parties agree that Pursuant to 2 CFR 200.36 and 2 CFR Part 200 Appendix II, all contractors are required to comply with the Federally Required Provisions in the Contract Documents.

ARTICLE 2 – TASK ORDERS

- 2.01 The Project for which the Work is under the Contract Documents may be the whole or only a part of the quantities estimated on the Unit Prices Bid Table. The Work will be assigned to the Contractor on a Task Order basis. Each duly executed Task Order will include limits of work, a written scope of work, estimated material quantities and Task Order value, performance period, and any supplemental drawings or details required for completion of the work. Task Orders will be issued sequentially, without overlap of performance period, unless agreed otherwise by all parties. The Contractor may decline to perform a Task Order valued at under \$20,000 without prejudice.

ARTICLE 3 – ENGINEER

- 3.01 The Project has been designed by Digital Engineering & Imaging, Inc. (Engineer), which is to act as Owner’s representative, assume all duties and responsibilities, and have the rights and authority assigned to Engineer in the Contract Documents in connection with the completion of the Work in accordance with the Contract Documents.

ARTICLE 4 – CONTRACT TIMES

4.01 *Contract Duration*

- A. The initial Contract Duration shall be for a period of one (1) calendar year from the agreement’s effective date.

- B. The Contract Duration may be extended by Owner for a period of up to two (2) additional calendar years on annual basis by written notice to the Contractor for a maximum of duration of three (3) calendar years.
- C. The agreement will expire at the final payment for the last task order issued, or on the latest agreement's expiration date, whichever is later. No task order may be issued after the latest agreement's expiration date.

4.02 *Days to Achieve Substantial Completion and Final Payment*

- A. The Work will be substantially completed on or before the date specified in each task order, and completed and ready for final payment in accordance with Paragraph 14.07 of the General Conditions on or before the date specified in each task order.

4.03 *Liquidated Damages*

- A. Contractor and Owner recognize that time is of the essence as stated in Paragraph 4.01 above and that Owner will suffer financial loss if the Work is not completed within the times specified in Paragraph 4.02 above, plus any extensions thereof allowed in accordance with Article 12 of the General Conditions. The parties also recognize the delays, expense, and difficulties involved in proving in a legal or arbitration proceeding the actual loss suffered by Owner if the Work is not completed on time. Accordingly, instead of requiring any such proof, Owner and Contractor agree that as liquidated damages for delay (but not as a penalty), Contractor shall pay Owner \$500.00 for each day that expires after the time specified in Paragraph 4.02 above for Substantial Completion until the Work is substantially complete. After Substantial Completion, if Contractor shall neglect, refuse, or fail to complete the remaining Work within the Contract Time or any proper extension thereof granted by Owner, Contractor shall pay Owner \$500.00 for each day that expires after the time specified in Paragraph 4.02 above for completion and readiness for final payment until the Work is completed and ready for final payment.
- B. In addition to and not in lieu of the per diem liquidated damages, Owner shall also be entitled to recover from Contractor additional liquidated damages for extended Resident Inspection fees and extended Construction Administration fees. Resident Inspection fee shall not exceed \$600.00 for each day that expires after the time specified in Paragraph 4.02 above for Substantial Completion until the Work is substantially complete. Construction Administration fee shall not exceed \$400.00 for each day that expires after the time specified in Paragraph 4.02 above for Substantial Completion until the Work is substantially complete.

ARTICLE 5 – CONTRACT PRICE

- 5.01 Owner shall pay Contractor for completion of the Work in accordance with the Contract Documents an amount in current funds equal to the sum of the amounts determined pursuant to Paragraphs 5.01.A and 5.01.B below:
- A. For all Unit Price Work, an amount equal to the sum of the established unity price (adjusted as applicable) for each separately identified item of Unit Price Work times the actual quantity of that item performed under each task order.
 - B. The Bid Prices for Unit Price Work set forth as the Effective Date of the Agreement are based on estimated quantities. As provided in Paragraph 11.03 of the General Conditions, estimated quantities are not guaranteed, and determinations of actual quantities and classifications are to be made by Engineer as provided in Paragraph 9.07 of the General Conditions.

ARTICLE 6 – PAYMENT PROCEDURES

6.01 *Submittal and Processing of Payments*

- A. Contractor shall submit Applications for Payment in accordance with Article 14 of the General Conditions. Applications for Payment will be processed by Engineer as provided in the General Conditions.

6.02 *Progress Payments; Retainage*

- A. Owner shall make progress payments on account of the Contract Price on the basis of Contractor's Applications for Payment on or about the 1st day of each month during performance of the Work as provided in Paragraph 6.02.A.1 below. All such payments will be measured by the schedule of values established as provided in Paragraph 2.07.A of the General Conditions (and in the case of Unit Price Work based on the number of units completed) or, in the event there is no schedule of values, as provided in the General Requirements.
 - 1. Prior to Substantial Completion, progress payments will be made in an amount equal to the percentage indicated in Paragraphs 6.02.A.1.a. & 6.02.A.1.b. below but, in each case, less the aggregate of payments previously made and less such amounts as Engineer may determine or Owner may withhold, including but not limited to liquidated damages, in accordance with Paragraph 14.02 of the General Conditions.
 - a. 90 or 95 percent of Work completed (with the balance being retainage based on the percentage indicated Paragraph 6.02.A.1.c below).
 - b. 90 or 95 percent of cost of materials and equipment not incorporated in the Work (with the balance being retainage based on the percentage indicated Paragraph 6.02.A.1.c below).
 - c. Retainage: 10% Task Orders \$0 - \$499,999
5% Task Orders \$500,000 and over

- B. Upon Substantial Completion, Owner shall pay an amount sufficient to increase total payments to Contractor to 90 or 95 percent of the Work completed as applicable, less such amounts as Engineer shall determine in accordance with Paragraph 14.02.B.5 of the General Conditions and less 200 percent of Engineer's estimate of the value of Work to be completed or corrected as shown on the tentative list of items to be completed or corrected attached to the certificate of Substantial Completion.

6.03 *Final Payment*

- A. Upon final completion and acceptance of the Work in accordance with Paragraph 14.07 of the General Conditions, Owner shall pay the remainder of the Contract Price as recommended by Engineer as provided in said Paragraph 14.07.
- B. Following acceptance of the Work by the Owner, Contractor, at his expense, shall file the acceptance with the Clerk of Court and Ex-Officio Recorder of Mortgages.
- C. Release and payment of Retainage, or balance due, will become due and will be paid by Owner to Contractor thirty days after receipt of Application for Retainage Payment (which must include a clear lien and privilege certificate secured from the Clerk of Court and Ex-Officio Recorder of Mortgages dated no less than forty-five (45) days after the filing of the acceptance and other documentation as required by the Contract Documents), and recommendation of payment by the Engineer.

ARTICLE 7 – RESERVED.

ARTICLE 8 – CONTRACTOR'S REPRESENTATIONS

- 8.01 In order to induce Owner to enter into this Agreement, Contractor makes the following representations:
 - A. Contractor has examined and carefully studied the Contract Documents and the other related data identified in the Bidding Documents.
 - B. Contractor has visited the Site and become familiar with and is satisfied as to the general, local, and Site conditions that may affect cost, progress, and performance of the Work.
 - C. Contractor is familiar with and is satisfied as to all federal, state, and local Laws and Regulations that may affect cost, progress, and performance of the Work.
 - D. Contractor has considered the information known to Contractor; information commonly known to contractors doing business in the locality of the Site; information and observations obtained from visits to the Site; the Contract Documents; and the Site-related reports and drawings identified in the Contract Documents, with respect to the effect of such information, observations, and documents on (1) the cost, progress, and performance of the Work; (2) the means, methods, techniques, sequences, and procedures of construction to be employed by Contractor, including any specific means, methods, techniques, sequences, and procedures of construction expressly required by the Contract Documents; and (3) Contractor's safety precautions and programs.

- E. Based on the information and observations referred to in Paragraph 8.01.D above, Contractor does not consider that further examinations, investigations, explorations, tests, studies, or data are necessary for the performance of the Work at the Contract Price, within the Contract Times, and in accordance with the other terms and conditions of the Contract Documents.
- F. Contractor is aware of the general nature of work to be performed by Owner and others at the Site that relates to the Work as indicated in the Contract Documents.
- G. Contractor has given Engineer written notice of all conflicts, errors, ambiguities, or discrepancies that Contractor has discovered in the Contract Documents, and the written resolution thereof by Engineer is acceptable to Contractor.
- H. The Contract Documents are generally sufficient to indicate and convey understanding of all terms and conditions for performance and furnishing of the Work.

ARTICLE 9 – CONTRACT DOCUMENTS

9.01 *Contents*

- A. The Contract Documents consist of the following:
 - 1. This Agreement (pages 00520-1 to 00520-9, inclusive).
 - 2. Performance bond (pages 00610-1 to 00610-2, inclusive).
 - 3. Payment bond (pages 00610-3 to 00610-5, inclusive).
 - 4. General Conditions (pages 00700-1 to 00700-60, inclusive).
 - 5. Supplementary Conditions (pages 00800-1 to 00800-11, inclusive).
 - 6. Specifications as listed in the table of contents of the Project Manual.
 - 7. Typical detail drawings with each sheet bearing the following general title: 2024 Water & Sewer Maintenance Contract (pages COM-1 to COM-15).
 - 8. Addenda (No. 1 to 1, inclusive)
 - 9. Exhibits to this Agreement (enumerated as follows):
 - a. Contractor’s Bid.
 - b. Documentation submitted by Contractor prior to Notice of Award.
 - 10. The following which may be delivered or issued on or after the Effective Date of the Agreement and are not attached hereto:
 - a. Notice to Proceed.

- b. Work Change Directives.
- c. Change Orders.
- B. The documents listed in Paragraph 9.01.A are attached to this Agreement (except as expressly noted otherwise above).
- C. There are no Contract Documents other than those listed above in this Article 9.
- D. The Contract Documents may only be amended, modified, or supplemented as provided in Paragraph 3.04 of the General Conditions.

ARTICLE 10 – MISCELLANEOUS

10.01 Terms

- A. Terms used in this Agreement will have the meanings stated in the General Conditions and the Supplementary Conditions.

10.02 Assignment of Contract

- A. No assignment by a party hereto of any rights under or interests in the Contract will be binding on another party hereto without the written consent of the party sought to be bound; and, specifically but without limitation, moneys that may become due and moneys that are due may not be assigned without such consent (except to the extent that the effect of this restriction may be limited by law), and unless specifically stated to the contrary in any written consent to an assignment, no assignment will release or discharge the assignor from any duty or responsibility under the Contract Documents.

10.03 Successors and Assigns

- A. Owner and Contractor each binds itself, its partners, successors, assigns, and legal representatives to the other party hereto, its partners, successors, assigns, and legal representatives in respect to all covenants, agreements, and obligations contained in the Contract Documents.

10.04 Severability

- A. Any provision or part of the Contract Documents held to be void or unenforceable under any Law or Regulation shall be deemed stricken, and all remaining provisions shall continue to be valid and binding upon Owner and Contractor, who agree that the Contract Documents shall be reformed to replace such stricken provision or part thereof with a valid and enforceable provision that comes as close as possible to expressing the intention of the stricken provision.

10.06 *Contractor's Certifications*

- A. Contractor certifies that it has not engaged in corrupt, fraudulent, collusive, or coercive practices in competing for or in executing this Agreement. For the purposes of this Paragraph 10.05:
1. "corrupt practice" means the offering, giving, receiving, or soliciting of any thing of value likely to influence the action of a public official in the bidding process or in the Contract execution;
 2. "fraudulent practice" means an intentional misrepresentation of facts made (a) to influence the bidding process or the execution of the Contract to the detriment of Owner, (b) to establish Bid or Contract prices at artificial non-competitive levels, or (c) to deprive Owner of the benefits of free and open competition;
 3. "collusive practice" means a scheme or arrangement between two or more Bidders, with or without the knowledge of Owner, a purpose of which is to establish Bid prices at artificial, non-competitive levels; and
 4. "coercive practice" means harming or threatening to harm, directly or indirectly, persons or their property to influence their participation in the bidding process or affect the execution of the Contract.

10.07 *Termination*

- A. Either party may terminate this Agreement by according to the process established in the Federally Required Provisions that are part of the Contract Documents.

10.08 *Governing Law, Venue, and Attorney's Fees*

- A. This Contract shall be governed in all respects, including as to validity, interpretation and effect, by the internal laws of the State of Louisiana, without giving effect to the conflict of laws rules thereof. In the event of dispute hereunder, all matters shall be exclusively heard in the 22nd Judicial District Court, St. Tammany Parish, Louisiana with the prevailing party being entitled to the recovery of reasonable attorney's fees and costs from the non-prevailing party after final and non-appealable judgment.

10.09 *Fiscal Funding*

- A. The continuation of this Agreement is contingent upon the appropriation of funds to fulfill the requirements of the Agreement by the City of Mandeville. If the City fails to appropriate sufficient monies to provide for the continuation of this Agreement, or if such appropriation is reduced by any means provided in the appropriations act, or for any other lawful purpose, and the effect of such reduction is to provide insufficient monies for the continuation of the Agreement, this Agreement shall terminate on the date of the beginning of the first fiscal year for which funds are not appropriated.

10.10 *Indemnity – Hold Harmless*

- A. Contractor will indemnify, save harmless, and exempt the City, its officers, agents, servants and employees from and against any and all liability, suits, actions, legal proceedings, claims, demands, damages, costs, expenses, and attorneys' fees caused by a willful or negligent act or omission of Contractor, its officers, agents, servants and employees in the performance of this Contract; provided, however, that Contractor's indemnification obligation contained herein shall not apply to and Contractor shall not be liable for any suits, actions, legal proceedings, claims, demands, damages, costs, expenses and attorneys' fees caused by a willful or negligent act or omission of the City, its officers, agents, servants and employees.

10.11 *Taxes and Licenses*

- A. Contractor shall be responsible for all taxes arising out of or related to this Contract and obtain all licenses and permits necessary for the performance of this Contract

ARTICLE 11 – ENTIRE AGREEMENT

11.1 This Agreement constitutes the entire agreement between the Parties concerning the subject matter hereof, and shall supersede all prior negotiations, representations or understandings, whether written or oral.

ARTICLE 12 – INDEPENDENT CONTRACTOR

12.1 It is expressly agreed and understood between the parties entering into this Contract that the Contractor is acting as an independent agent. The Contractor nor anyone employed by or on behalf of the Contractor, shall receive any sick and annual leave benefits from the City.

ARTICLE 13– NON-WAIVER OF AGREEMENT RIGHTS

13.1 The failure of the City to insist upon strict performance of the terms and agreements herein shall not be construed as a waiver or relinquishment of the City's right to enforce any such term or condition, but the same shall continue in full force and effect. No action or omission of the City shall be considered a waiver of any of the terms or conditions of this Agreement, nor excuse any conduct contrary to the terms and conditions of this Agreement, nor be considered to create a pattern of conduct between the parties where one may attempt to rely upon the contrary terms and conditions of this Agreement.

IN WITNESS WHEREOF, Owner and Contractor have signed this Agreement. Counterparts have been delivered to Owner and Contractor. All portions of the Contract Documents have been signed or have been identified by Owner and Contractor or on their behalf.

This Agreement will be effective on _____ (which is the Effective Date of the Agreement).

OWNER:

City of Mandeville

By: _____

Title: Mayor

Attest: _____

Title: _____

Address for giving notices:

Digital Engineering & Imaging, Inc.

3500 U.S. 190, Suite 201

Mandeville, LA 70471

CONTRACTOR

Subterranean Construction, LLC

By: _____

Title: Member

(If Contractor is a corporation, a partnership, or a joint venture, attach evidence of authority to sign.)

Attest: _____

Title: _____

Address for giving notices:

P.O. Box 588

Mandeville, LA 70470

License No.: 34191



DIGITAL ENGINEERING & IMAGING, INC.

October 14, 2024

City of Mandeville
Department of Public Works
1100 Mandeville High Blvd.
Mandeville, LA 70471
Attn: Keith LaGrange, Director

Re: 2024 Sewer & Water Maintenance Contract
Recommendation of Award
City Project Nos.: 211.21.003 / 212.21.003

Dear Mr. Lagrange:

On Wednesday, October 9, 2024, bids for the above referenced project were received and read aloud in the Council Chambers. The following are the tabulated bids in an ascending order based on the total base bid price for two (2) bids received:

<u>Contractor</u>	<u>Total Base Bid</u>
Subterranean Construction, LLC	\$8,750,360.00
Fleming Construction Company, LLC	\$12,240,170.00 ⁽¹⁾

(1) Pages 00300-2 and 00300-3 containing bid items 1 through 24 were excluded from the Louisiana Uniform Public Work Bid Form in the bid submitted by Fleming Construction Company, LLC. Therefore, the total base bid in the amount of \$12,240,170.00 was unable to be verified, and the Fleming Construction Company, LLC bid deemed non-responsive.

Based upon the above list of represented bidders, the apparent lowest responsive and responsible bidder for this project was Subterranean Construction, LLC who is a qualified licensed contractor (LA License #34191) according to the Louisiana State Licensing Board. We have reviewed the bid documents for Subterranean Construction, LLC and found them to be complete. Therefore, Digital Engineering & Imaging, Inc. recommends the City accept the Subterranean Construction, LLC bid and award them the project in the amount of \$8,750,360.00, which is approximately 2% under the engineer's estimate.

The award of this contract does not obligate the City to the total bid amount. The amount bid is theoretical for the comparison of prices only, and therefore does not violate any budget limitations. The work will be issued to the contractor in future task orders.

If you have any questions or concerns, please do not hesitate to call.

Sincerely,
DIGITAL ENGINEERING & IMAGING INC.

Buster Lyons, P.E.,
Project Manager

Attachments: Bid Documents & Bid Tabulation

115	8" Gate Valve and Valve Box	Each	10	\$ 3,280.00	\$ 32,800.00	\$ 4,800.00	\$ 48,000.00	\$ 2,700.00	\$ 27,000.00
116	12" Gate Valve and Valve Box	Each	5	\$ 5,600.00	\$ 28,000.00	\$ 7,100.00	\$ 35,500.00	\$ 3,000.00	\$ 15,000.00
117	14" Gate Valve and Valve Box	Each	5	\$ 5,900.00	\$ 29,500.00	\$ 14,600.00	\$ 73,000.00	\$ 3,250.00	\$ 16,250.00
118	16" Gate Valve and Valve Box	Each	5	\$ 7,800.00	\$ 39,000.00	\$ 16,300.00	\$ 81,500.00	\$ 4,000.00	\$ 20,000.00
119	4" Insertion Valve	Each	5	\$ 9,000.00	\$ 45,000.00	\$ 13,200.00	\$ 66,000.00	\$ 8,000.00	\$ 40,000.00
120	6" Insertion Valve	Each	5	\$ 12,600.00	\$ 63,000.00	\$ 14,200.00	\$ 71,000.00	\$ 8,500.00	\$ 42,500.00
121	8" Insertion Valve	Each	5	\$ 14,000.00	\$ 70,000.00	\$ 15,300.00	\$ 76,500.00	\$ 9,500.00	\$ 47,500.00
122	12" Insertion Valve	Each	5	\$ 28,000.00	\$ 140,000.00	\$ 29,000.00	\$ 145,000.00	\$ 12,500.00	\$ 62,500.00
123	14" Insertion Valve	Each	5	\$ 48,000.00	\$ 240,000.00	\$ 70,500.00	\$ 352,500.00	\$ 15,000.00	\$ 75,000.00
124	16" Insertion Valve	Each	5	\$ 50,000.00	\$ 250,000.00	\$ 72,000.00	\$ 360,000.00	\$ 20,000.00	\$ 100,000.00
125	6" Tapping Sleeve & Valve Assembly	Each	5	\$ 5,900.00	\$ 29,500.00	\$ 2,550.00	\$ 12,750.00	\$ 4,500.00	\$ 22,500.00
126	8" Tapping Sleeve & Valve Assembly	Each	5	\$ 7,200.00	\$ 36,000.00	\$ 3,800.00	\$ 19,000.00	\$ 5,500.00	\$ 27,500.00
127	4" Mechanical Joint Restraints	Each	5	\$ 10.00	\$ 50.00	\$ 335.00	\$ 1,675.00	\$ 100.00	\$ 500.00
128	6" Mechanical Joint Restraints	Each	5	\$ 10.00	\$ 50.00	\$ 400.00	\$ 2,000.00	\$ 125.00	\$ 625.00
129	8" Mechanical Joint Restraints	Each	5	\$ 10.00	\$ 50.00	\$ 570.00	\$ 2,850.00	\$ 200.00	\$ 1,000.00
130	12" Mechanical Joint Restraints	Each	5	\$ 10.00	\$ 50.00	\$ 740.00	\$ 3,700.00	\$ 350.00	\$ 1,750.00
131	14" Mechanical Joint Restraints	Each	5	\$ 10.00	\$ 50.00	\$ 870.00	\$ 4,350.00	\$ 550.00	\$ 2,750.00
132	16" Mechanical Joint Restraints	Each	5	\$ 10.00	\$ 50.00	\$ 1,500.00	\$ 7,500.00	\$ 750.00	\$ 3,750.00
133	4" Bell Joint Restraints	Each	5	\$ 250.00	\$ 1,250.00	\$ 84.00	\$ 420.00	\$ 75.00	\$ 375.00
134	6" Bell Joint Restraints	Each	5	\$ 340.00	\$ 1,700.00	\$ 100.00	\$ 500.00	\$ 150.00	\$ 750.00
135	8" Bell Joint Restraints	Each	5	\$ 440.00	\$ 2,200.00	\$ 135.00	\$ 675.00	\$ 325.00	\$ 1,625.00
136	12" Bell Joint Restraints	Each	5	\$ 520.00	\$ 2,600.00	\$ 440.00	\$ 2,200.00	\$ 600.00	\$ 3,000.00
137	14" Bell Joint Restraints	Each	5	\$ 1,050.00	\$ 5,250.00	\$ 700.00	\$ 3,500.00	\$ 1,000.00	\$ 5,000.00
138	16" Bell Joint Restraints	Each	5	\$ 1,160.00	\$ 5,800.00	\$ 830.00	\$ 4,150.00	\$ 1,250.00	\$ 6,250.00
139	4" Transitional Couplings	Each	5	\$ 500.00	\$ 2,500.00	\$ 404.00	\$ 2,020.00	\$ 350.00	\$ 1,750.00
140	6" Transitional Couplings	Each	5	\$ 670.00	\$ 3,350.00	\$ 534.00	\$ 2,670.00	\$ 500.00	\$ 2,500.00
141	8" Transitional Couplings	Each	5	\$ 800.00	\$ 4,000.00	\$ 600.00	\$ 3,000.00	\$ 700.00	\$ 3,500.00
142	Fire Hydrant	Each	25	\$ 6,900.00	\$ 172,500.00	\$ 5,800.00	\$ 145,000.00	\$ 7,000.00	\$ 175,000.00
143	Fire Hydrant Extension	Vertical Foot	20	\$ 500.00	\$ 10,000.00	\$ 450.00	\$ 9,000.00	\$ 1,000.00	\$ 20,000.00
144	Water Service Line (Open Cut) (1")	Linear Foot	500	\$ 14.00	\$ 7,000.00	\$ 30.00	\$ 15,000.00	\$ 8.00	\$ 4,000.00
145	Water Service Line (Open Cut) (2")	Linear Foot	150	\$ 19.00	\$ 2,850.00	\$ 32.00	\$ 4,800.00	\$ 10.00	\$ 1,500.00
146	Water Service Line (Directional Drill) (1")	Linear Foot	2000	\$ 18.00	\$ 36,000.00	\$ 20.00	\$ 40,000.00	\$ 15.00	\$ 30,000.00
147	Water Service Line (Directional Drill) (2")	Linear Foot	500	\$ 22.00	\$ 11,000.00	\$ 24.00	\$ 12,000.00	\$ 17.50	\$ 8,750.00
148	1" Water Service Connection	Each	50	\$ 800.00	\$ 40,000.00	\$ 2,800.00	\$ 140,000.00	\$ 750.00	\$ 37,500.00
149	2" Water Service Connection	Each	15	\$ 1,200.00	\$ 18,000.00	\$ 19.00	\$ 285.00	\$ 1,000.00	\$ 15,000.00
150	Abandon Existing Pipelines	Each	5	\$ 900.00	\$ 4,500.00	\$ 9,780.00	\$ 48,900.00	\$ 500.00	\$ 2,500.00
151	4" and Smaller Waterline Point Repair	Each	5	\$ 3,400.00	\$ 17,000.00	\$ 5,000.00	\$ 25,000.00	\$ 4,000.00	\$ 20,000.00
152	6" Waterline Point Repair	Each	10	\$ 3,900.00	\$ 39,000.00	\$ 8,500.00	\$ 85,000.00	\$ 4,500.00	\$ 45,000.00
153	8" Waterline Point Repair	Each	15	\$ 4,200.00	\$ 63,000.00	\$ 9,000.00	\$ 135,000.00	\$ 6,250.00	\$ 93,750.00
154	12" Waterline Point Repair	Each	5	\$ 6,200.00	\$ 31,000.00	\$ 12,000.00	\$ 60,000.00	\$ 6,500.00	\$ 32,500.00
155	16" Waterline Point Repair	Each	5	\$ 11,800.00	\$ 59,000.00	\$ 15,000.00	\$ 75,000.00	\$ 7,500.00	\$ 37,500.00
156	Waterline Disinfection	Each	5	\$ 1,500.00	\$ 7,500.00	\$ 4,500.00	\$ 22,500.00	\$ 1,000.00	\$ 5,000.00
157	1" Curb Stop	Each	30	\$ 190.00	\$ 5,700.00	\$ 125.00	\$ 3,750.00	\$ 500.00	\$ 15,000.00
158	2" Curb Stop	Each	10	\$ 550.00	\$ 5,500.00	\$ 500.00	\$ 5,000.00	\$ 700.00	\$ 7,000.00
159	Meter Box (Iron)	Each	20	\$ 400.00	\$ 8,000.00	\$ 400.00	\$ 8,000.00	\$ 225.00	\$ 4,500.00
160	Stone Foundation Material	CY	50	\$ 99.00	\$ 4,950.00	\$ 100.00	\$ 5,000.00	\$ 100.00	\$ 5,000.00
161	Class II Base Course	CY	100	\$ 92.00	\$ 9,200.00	\$ 250.00	\$ 25,000.00	\$ 125.00	\$ 12,500.00
162	Manhole Insert	Each	100	\$ 300.00	\$ 30,000.00	\$ 100.00	\$ 10,000.00	\$ 125.00	\$ 12,500.00
163	Topsoil (6" min.)	Square Yard	450	\$ 45.00	\$ 20,250.00	\$ 25.00	\$ 11,250.00	\$ 15.00	\$ 6,750.00
164	Police Detail for Traffic Control	Hour	8	\$ 95.00	\$ 760.00	\$ 100.00	\$ 800.00	\$ 55.00	\$ 440.00
165	Arrow/Message Boards for Traffic Control	Each/Day	10	\$ 500.00	\$ 5,000.00	\$ 500.00	\$ 5,000.00	\$ 500.00	\$ 5,000.00
								Subtotal	\$8,092,580.00
								10% Contingency	\$809,258.00
								TOTAL BASE BID	\$ 8,750,360.00
									\$ 12,240,170.00
								% Bid Within	-1.70%

* Apparent lowest responsive & responsible bidder

⁽¹⁾ Pages 00300-2 and 00300-3 containing bid items 1 through 24 were excluded from the Louisiana Uniform Public Work Bid Form in the bid submitted by Fleming Construction Company, LLC. Therefore, the total base bid in the amount of \$12,240,170.00 was unable to be verified, and the Fleming Construction Company, LLC bid deemed non-responsive.

Digital Engineering & Imaging Inc.
By: Buster Lyons, P.E.

Buster Lyons...

Date: October 14, 2024

SECTION 00300

LOUISIANA UNIFORM PUBLIC WORK BID FORM

TO: City of Mandeville
3101 E. Causeway Approach
Mandeville, LA 70448

BID FOR: 2024 Water & Sewer Maintenance Contract
City of Mandeville Project No.
211.21.003/212.21.003

The undersigned bidder hereby declares and represents that she/he; a) has carefully examined and understands the Bidding Documents, b) has not received, relied on, or based his bid on any verbal instructions contrary to the Bidding Documents or any addenda, c) has personally inspected and is familiar with the project site, and hereby proposes to provide all labor, materials, tools, appliances and facilities as required to perform, in a workmanlike manner, all work and services for the construction and completion of the referenced project, all in strict accordance with the Bidding Documents prepared by: Digital Engineering & Imaging, Inc. and dated: August 2024.

Bidders must acknowledge all addenda. The Bidder acknowledges receipt of the following ADDENDA: (Enter the number the Designer has assigned to each of the addenda that the Bidder is acknowledging) Addenda 1, dated 10/4/2024

TOTAL BASE BID: For all work required by the Bidding Documents (including any and all unit prices designated "Base Bid" * but not alternates) the sum of:

Eight Million Seven Hundred Fifty Thousand Three Hundred Sixty Dollars and no/100----- Dollars (\$ 8,750,360.00)

ALTERNATES: For any and all work required by the Bidding Documents for Alternates including any and all unit prices designated as alternates in the unit price description.

Alternate No. 1 (Owner to provide description of alternate and state whether add or deduct) for the lump sum of:

N/A Dollars (\$)

Alternate No. 2 (Owner to provide description of alternate and state whether add or deduct) for the lump sum of:

N/A Dollars (\$)

Alternate No. 3 (Owner to provide description of alternate and state whether add or deduct) for the lump sum of:

N/A Dollars (\$)

NAME OF BIDDER: Subterranean Construction, LLC

ADDRESS OF BIDDER: PO Box 588
Mandeville, LA 70470

LOUISIANA CONTRACTOR'S LICENSE NUMBER: 34191

NAME OF AUTHORIZED SIGNATORY OF BIDDER: Evan T. Conravey

TITLE OF AUTHORIZED SIGNATORY OF BIDDER: Member

SIGNATURE OF AUTHORIZED SIGNATORY OF BIDDER:**

DATE: October 9, 2024

Handwritten signature of Evan T. Conravey in blue ink.

* The Unit Price Form shall be used if the contract includes unit prices. Otherwise it is not required and need not be included with the form. The number of unit prices that may be included is not limited and additional sheets may be included if needed.

** A CORPORATE RESOLUTION OR WRITTEN EVIDENCE of the authority of the person signing the bid for the public work as prescribed by LA R.S. 38:2212(B)5.

BID SECURITY in the form of a bid bond, certified check or cashier's check as prescribed by LA R.S. 38:2218(A) is attached to and made a part of this bid.

LOUISIANA UNIFORM PUBLIC WORK BID FORM

UNIT PRICE FORM

TO: City of Mandeville
3101 E. Causeway Approach
Mandeville, LA 70448

BID FOR: 2024 Water & Sewer Maintenance Contract
City of Mandeville Project No.
211.21.003/212.21.003

(Owner to provide name and address of owner)

(Owner to provide name of project and other identifying information)

UNIT PRICES: This form shall be used for any and all work required by the Bidding Documents and described as unit prices. Amounts shall be stated in figures and only in figures.

DESCRIPTION: <input checked="" type="checkbox"/> Base Bid or <input type="checkbox"/> Alt.# Mobilization (Initial per Task Order)				
REF. NO.	QUANTITY:	UNIT OF MEASURE:	UNIT PRICE	UNIT PRICE EXTENSION <i>(Quantity times Unit Price)</i>
1	4	Each	40,000.00	160,000.00

DESCRIPTION: <input checked="" type="checkbox"/> Base Bid or <input type="checkbox"/> Alt.# Mobilization (site to site within Task Order)				
REF. NO.	QUANTITY:	UNIT OF MEASURE:	UNIT PRICE	UNIT PRICE EXTENSION <i>(Quantity times Unit Price)</i>
2	250	Each	600.00	150,000.00

DESCRIPTION: <input checked="" type="checkbox"/> Base Bid or <input type="checkbox"/> Alt.# Emergency Point Repair Mobilization				
REF. NO.	QUANTITY:	UNIT OF MEASURE:	UNIT PRICE	UNIT PRICE EXTENSION <i>(Quantity times Unit Price)</i>
3	10	Each	5,000.00	50,000.00

DESCRIPTION: <input checked="" type="checkbox"/> Base Bid or <input type="checkbox"/> Alt.# Exploratory Excavation (Depth less than 6')				
REF. NO.	QUANTITY:	UNIT OF MEASURE:	UNIT PRICE	UNIT PRICE EXTENSION <i>(Quantity times Unit Price)</i>
4	100	Each	685.00	68,500.00

DESCRIPTION: <input checked="" type="checkbox"/> Base Bid or <input type="checkbox"/> Alt.# Exploratory Excavation (Depth 6' to 10')				
REF. NO.	QUANTITY:	UNIT OF MEASURE:	UNIT PRICE	UNIT PRICE EXTENSION <i>(Quantity times Unit Price)</i>
5	25	Each	925.00	23,125.00

DESCRIPTION: <input checked="" type="checkbox"/> Base Bid or <input type="checkbox"/> Alt.# Removal of Asphalt Pavement				
REF. NO.	QUANTITY:	UNIT OF MEASURE:	UNIT PRICE	UNIT PRICE EXTENSION <i>(Quantity times Unit Price)</i>
6	1500	Square Yard	20.00	30,000.00

DESCRIPTION: <input checked="" type="checkbox"/> Base Bid or <input type="checkbox"/> Alt.# Removal of Concrete Pavement				
REF. NO.	QUANTITY:	UNIT OF MEASURE:	UNIT PRICE	UNIT PRICE EXTENSION <i>(Quantity times Unit Price)</i>
7	650	Square Yard	18.00	11,700.00

DESCRIPTION: <input checked="" type="checkbox"/> Base Bid or <input type="checkbox"/> Alt.# Removal of Structures				
REF. NO.	QUANTITY:	UNIT OF MEASURE:	UNIT PRICE	UNIT PRICE EXTENSION <i>(Quantity times Unit Price)</i>
8	20	Cubic Yard	65.00	1,300.00

DESCRIPTION: <input checked="" type="checkbox"/> Base Bid or <input type="checkbox"/> Alt.# Sawcut Pavement				
REF. NO.	QUANTITY:	UNIT OF MEASURE:	UNIT PRICE	UNIT PRICE EXTENSION <i>(Quantity times Unit Price)</i>
9	18,000	Linear Foot-Inch	2.00	36,000.00

DESCRIPTION: <input checked="" type="checkbox"/> Base Bid or <input type="checkbox"/> Alt.# Traffic Maintenance Roadway Aggregate (Net Section)				
REF. NO.	QUANTITY:	UNIT OF MEASURE:	UNIT PRICE	UNIT PRICE EXTENSION <i>(Quantity times Unit Price)</i>
10	200	Cubic Yard	65.00	13,000.00

DESCRIPTION: <input checked="" type="checkbox"/> Base Bid or <input type="checkbox"/> Alt.# Granular Material (Vehicular Measurement)				
REF. NO.	QUANTITY:	UNIT OF MEASURE:	UNIT PRICE	UNIT PRICE EXTENSION <i>(Quantity times Unit Price)</i>
11	350	Cubic Yard	35.00	12,250.00

TO: City of Mandeville
3101 E. Causeway Approach
Mandeville, LA 70448

(Owner to provide name and address of owner)

BID FOR: 2024 Water & Sewer Maintenance Contract
City of Mandeville Project No.
211.21.003/212.21.003

(Owner to provide name of project and other identifying information)

DESCRIPTION:	<input checked="" type="checkbox"/> Base Bid or <input type="checkbox"/> Alt.# ___ Asphalt Pavement			
REF. NO.	QUANTITY:	UNIT OF MEASURE:	UNIT PRICE	UNIT PRICE EXTENSION <i>(Quantity times Unit Price)</i>
12	100	Ton	180.00	18,000.00

DESCRIPTION:	<input checked="" type="checkbox"/> Base Bid or <input type="checkbox"/> Alt.# ___ Full Depth Asphalt Patch (12" Thick, Major Roads)			
REF. NO.	QUANTITY:	UNIT OF MEASURE:	UNIT PRICE	UNIT PRICE EXTENSION <i>(Quantity times Unit Price)</i>
13	400	Square Yard	280.00	112,000.00

DESCRIPTION:	<input checked="" type="checkbox"/> Base Bid or <input type="checkbox"/> Alt.# ___ Full Depth Asphalt Patch (8" Thick, Minor Roads)			
REF. NO.	QUANTITY:	UNIT OF MEASURE:	UNIT PRICE	UNIT PRICE EXTENSION <i>(Quantity times Unit Price)</i>
14	600	Square Yard	200.00	120,000.00

DESCRIPTION:	<input checked="" type="checkbox"/> Base Bid or <input type="checkbox"/> Alt.# ___ Concrete Pavement (6" Thick)			
REF. NO.	QUANTITY:	UNIT OF MEASURE:	UNIT PRICE	UNIT PRICE EXTENSION <i>(Quantity times Unit Price)</i>
15	400	Square Yard	125.00	50,000.00

DESCRIPTION:	<input checked="" type="checkbox"/> Base Bid or <input type="checkbox"/> Alt.# ___ Concrete Pavement (8" Thick)			
REF. NO.	QUANTITY:	UNIT OF MEASURE:	UNIT PRICE	UNIT PRICE EXTENSION <i>(Quantity times Unit Price)</i>
16	250	Square Yard	140.00	35,000.00

DESCRIPTION:	<input checked="" type="checkbox"/> Base Bid or <input type="checkbox"/> Alt.# ___ Concrete Walk (4" Thick)			
REF. NO.	QUANTITY:	UNIT OF MEASURE:	UNIT PRICE	UNIT PRICE EXTENSION <i>(Quantity times Unit Price)</i>
17	100	Square Yard	120.00	12,000.00

DESCRIPTION:	<input checked="" type="checkbox"/> Base Bid or <input type="checkbox"/> Alt.# ___ Sodding			
REF. NO.	QUANTITY:	UNIT OF MEASURE:	UNIT PRICE	UNIT PRICE EXTENSION <i>(Quantity times Unit Price)</i>
18	600	Square Yard	14.00	8,400.00

DESCRIPTION:	<input checked="" type="checkbox"/> Base Bid or <input type="checkbox"/> Alt.# ___ Well-Point Setup			
REF. NO.	QUANTITY:	UNIT OF MEASURE:	UNIT PRICE	UNIT PRICE EXTENSION <i>(Quantity times Unit Price)</i>
19	5	Each	6,000.00	30,000.00

DESCRIPTION:	<input checked="" type="checkbox"/> Base Bid or <input type="checkbox"/> Alt.# ___ Well Point Daily Operation			
REF. NO.	QUANTITY:	UNIT OF MEASURE:	UNIT PRICE	UNIT PRICE EXTENSION <i>(Quantity times Unit Price)</i>
20	5	Each	1,400.00	7,000.00

DESCRIPTION:	<input checked="" type="checkbox"/> Base Bid or <input type="checkbox"/> Alt.# ___ 6" Gravity Sewer (depth less than 6 feet)			
REF. NO.	QUANTITY:	UNIT OF MEASURE:	UNIT PRICE	UNIT PRICE EXTENSION <i>(Quantity times Unit Price)</i>
21	200	Linear Foot	120.00	24,000.00

DESCRIPTION:	<input checked="" type="checkbox"/> Base Bid or <input type="checkbox"/> Alt.# ___ 8" Gravity Sewer (depth less than 6 feet)			
REF. NO.	QUANTITY:	UNIT OF MEASURE:	UNIT PRICE	UNIT PRICE EXTENSION <i>(Quantity times Unit Price)</i>
22	200	Linear Foot	130.00	26,000.00

DESCRIPTION:	<input checked="" type="checkbox"/> Base Bid or <input type="checkbox"/> Alt.# ___ 8" Gravity Sewer (depth 6 feet-1 inch to 8 feet)			
REF. NO.	QUANTITY:	UNIT OF MEASURE:	UNIT PRICE	UNIT PRICE EXTENSION <i>(Quantity times Unit Price)</i>
23	200	Linear Foot	165.00	33,000.00

DESCRIPTION:	<input checked="" type="checkbox"/> Base Bid or <input type="checkbox"/> Alt.# ___ 8" Gravity Sewer (depth 8 feet-1 inch to 10 feet)			
REF. NO.	QUANTITY:	UNIT OF MEASURE:	UNIT PRICE	UNIT PRICE EXTENSION <i>(Quantity times Unit Price)</i>
24	200	Linear Foot	185.00	37,000.00

TO: City of Mandeville
3101 E. Causeway Approach
Mandeville, LA 70448

(Owner to provide name and address of owner)

BID FOR: 2024 Water & Sewer Maintenance Contract
City of Mandeville Project No.
211.21.003/212.21.003

(Owner to provide name of project and other identifying information)

DESCRIPTION:	<input checked="" type="checkbox"/> Base Bid or <input type="checkbox"/> Alt.# ___ 8" Gravity Sewer (depth greater than 10 feet)			
REF. NO.	QUANTITY:	UNIT OF MEASURE:	UNIT PRICE	UNIT PRICE EXTENSION (Quantity times Unit Price)
25	200	Linear Foot	230.00	46,000.00

DESCRIPTION:	<input checked="" type="checkbox"/> Base Bid or <input type="checkbox"/> Alt.# ___ 10" Gravity Sewer (depth less than 6 feet)			
REF. NO.	QUANTITY:	UNIT OF MEASURE:	UNIT PRICE	UNIT PRICE EXTENSION (Quantity times Unit Price)
26	200	Linear Foot	150.00	30,000.00

DESCRIPTION:	<input checked="" type="checkbox"/> Base Bid or <input type="checkbox"/> Alt.# ___ 10" Gravity Sewer (depth 6 feet-1 inch to 8 feet)			
REF. NO.	QUANTITY:	UNIT OF MEASURE:	UNIT PRICE	UNIT PRICE EXTENSION (Quantity times Unit Price)
27	200	Linear Foot	180.00	36,000.00

DESCRIPTION:	<input checked="" type="checkbox"/> Base Bid or <input type="checkbox"/> Alt.# ___ 10" Gravity Sewer (depth 8 feet-1 inch to 10 feet)			
REF. NO.	QUANTITY:	UNIT OF MEASURE:	UNIT PRICE	UNIT PRICE EXTENSION (Quantity times Unit Price)
28	200	Linear Foot	200.00	40,000.00

DESCRIPTION:	<input checked="" type="checkbox"/> Base Bid or <input type="checkbox"/> Alt.# ___ 10" Gravity Sewer (depth greater than 10 feet)			
REF. NO.	QUANTITY:	UNIT OF MEASURE:	UNIT PRICE	UNIT PRICE EXTENSION (Quantity times Unit Price)
29	200	Linear Foot	240.00	48,000.00

DESCRIPTION:	<input checked="" type="checkbox"/> Base Bid or <input type="checkbox"/> Alt.# ___ 12" Gravity Sewer (depth less than 6 feet)			
REF. NO.	QUANTITY:	UNIT OF MEASURE:	UNIT PRICE	UNIT PRICE EXTENSION (Quantity times Unit Price)
30	50	Linear Foot	199.00	9,950.00

DESCRIPTION:	<input checked="" type="checkbox"/> Base Bid or <input type="checkbox"/> Alt.# ___ 12" Gravity Sewer (depth 6 feet-1 inch to 8 feet)			
REF. NO.	QUANTITY:	UNIT OF MEASURE:	UNIT PRICE	UNIT PRICE EXTENSION (Quantity times Unit Price)
31	50	Linear Foot	210.00	10,500.00

DESCRIPTION:	<input checked="" type="checkbox"/> Base Bid or <input type="checkbox"/> Alt.# ___ 12" Gravity Sewer (depth 8 feet-1 inch to 10 feet)			
REF. NO.	QUANTITY:	UNIT OF MEASURE:	UNIT PRICE	UNIT PRICE EXTENSION (Quantity times Unit Price)
32	50	Linear Foot	220.00	11,000.00

DESCRIPTION:	<input checked="" type="checkbox"/> Base Bid or <input type="checkbox"/> Alt.# ___ 12" Gravity Sewer (depth greater than 10 feet)			
REF. NO.	QUANTITY:	UNIT OF MEASURE:	UNIT PRICE	UNIT PRICE EXTENSION (Quantity times Unit Price)
33	50	Linear Foot	260.00	13,000.00

DESCRIPTION:	<input checked="" type="checkbox"/> Base Bid or <input type="checkbox"/> Alt.# ___ 6" Ductile Iron Pipe			
REF. NO.	QUANTITY:	UNIT OF MEASURE:	UNIT PRICE	UNIT PRICE EXTENSION (Quantity times Unit Price)
34	50	Linear Foot	90.00	4,500.00

DESCRIPTION:	<input checked="" type="checkbox"/> Base Bid or <input type="checkbox"/> Alt.# ___ 8" Ductile Iron Pipe			
REF. NO.	QUANTITY:	UNIT OF MEASURE:	UNIT PRICE	UNIT PRICE EXTENSION (Quantity times Unit Price)
35	50	Linear Foot	120.00	6,000.00

DESCRIPTION:	<input checked="" type="checkbox"/> Base Bid or <input type="checkbox"/> Alt.# ___ 12" Ductile Iron Pipe			
REF. NO.	QUANTITY:	UNIT OF MEASURE:	UNIT PRICE	UNIT PRICE EXTENSION (Quantity times Unit Price)
36	50	Linear Foot	150.00	7,500.00

DESCRIPTION:	<input checked="" type="checkbox"/> Base Bid or <input type="checkbox"/> Alt.# ___ 14" Ductile Iron Pipe			
REF. NO.	QUANTITY:	UNIT OF MEASURE:	UNIT PRICE	UNIT PRICE EXTENSION (Quantity times Unit Price)
37	50	Linear Foot	170.00	8,500.00

TO: City of Mandeville
3101 E. Causeway Approach
Mandeville, LA 70448

BID FOR: 2024 Water & Sewer Maintenance Contract
City of Mandeville Project No.
211.21.003/212.21.003

(Owner to provide name and address of owner)

(Owner to provide name of project and other identifying information)

DESCRIPTION:	<input checked="" type="checkbox"/> Base Bid or <input type="checkbox"/> Alt.# ___ 16" Ductile Iron Pipe			
REF. NO.	QUANTITY:	UNIT OF MEASURE:	UNIT PRICE	UNIT PRICE EXTENSION (<i>Quantity times Unit Price</i>)
38	50	Linear Foot	200.00	10,000.00

DESCRIPTION:	<input checked="" type="checkbox"/> Base Bid or <input type="checkbox"/> Alt.# ___ 4" PVC C900 Pressure Pipe (Direct Bury)			
REF. NO.	QUANTITY:	UNIT OF MEASURE:	UNIT PRICE	UNIT PRICE EXTENSION (<i>Quantity times Unit Price</i>)
39	50	Linear Foot	68.00	3,400.00

DESCRIPTION:	<input checked="" type="checkbox"/> Base Bid or <input type="checkbox"/> Alt.# ___ 6" PVC C900 Pressure Pipe (Direct Bury)			
REF. NO.	QUANTITY:	UNIT OF MEASURE:	UNIT PRICE	UNIT PRICE EXTENSION (<i>Quantity times Unit Price</i>)
40	200	Linear Foot	90.00	18,000.00

DESCRIPTION:	<input checked="" type="checkbox"/> Base Bid or <input type="checkbox"/> Alt.# ___ 8" PVC C900 Pressure Pipe (Direct Bury)			
REF. NO.	QUANTITY:	UNIT OF MEASURE:	UNIT PRICE	UNIT PRICE EXTENSION (<i>Quantity times Unit Price</i>)
41	500	Linear Foot	110.00	55,000.00

DESCRIPTION:	<input checked="" type="checkbox"/> Base Bid or <input type="checkbox"/> Alt.# ___ 12" PVC C900 Pressure Pipe (Direct Bury)			
REF. NO.	QUANTITY:	UNIT OF MEASURE:	UNIT PRICE	UNIT PRICE EXTENSION (<i>Quantity times Unit Price</i>)
42	100	Linear Foot	130.00	13,000.00

DESCRIPTION:	<input checked="" type="checkbox"/> Base Bid or <input type="checkbox"/> Alt.# ___ 14" PVC C900 Pressure Pipe (Direct Bury)			
REF. NO.	QUANTITY:	UNIT OF MEASURE:	UNIT PRICE	UNIT PRICE EXTENSION (<i>Quantity times Unit Price</i>)
43	100	Linear Foot	145.00	14,500.00

DESCRIPTION:	<input checked="" type="checkbox"/> Base Bid or <input type="checkbox"/> Alt.# ___ 16" PVC C900 Pressure Pipe (Direct Bury)			
REF. NO.	QUANTITY:	UNIT OF MEASURE:	UNIT PRICE	UNIT PRICE EXTENSION (<i>Quantity times Unit Price</i>)
44	100	Linear Foot	160.00	16,000.00

DESCRIPTION:	<input checked="" type="checkbox"/> Base Bid or <input type="checkbox"/> Alt.# ___ 4" HDPE Pipe (HDD)			
REF. NO.	QUANTITY:	UNIT OF MEASURE:	UNIT PRICE	UNIT PRICE EXTENSION (<i>Quantity times Unit Price</i>)
45	50	Linear Foot	78.00	3,900.00

DESCRIPTION:	<input checked="" type="checkbox"/> Base Bid or <input type="checkbox"/> Alt.# ___ 6" HDPE Pipe (HDD)			
REF. NO.	QUANTITY:	UNIT OF MEASURE:	UNIT PRICE	UNIT PRICE EXTENSION (<i>Quantity times Unit Price</i>)
46	200	Linear Foot	96.00	19,200.00

DESCRIPTION:	<input checked="" type="checkbox"/> Base Bid or <input type="checkbox"/> Alt.# ___ 8" HDPE Pipe (HDD)			
REF. NO.	QUANTITY:	UNIT OF MEASURE:	UNIT PRICE	UNIT PRICE EXTENSION (<i>Quantity times Unit Price</i>)
47	100	Linear Foot	105.00	10,500.00

DESCRIPTION:	<input checked="" type="checkbox"/> Base Bid or <input type="checkbox"/> Alt.# ___ 12" HDPE Pipe (HDD)			
REF. NO.	QUANTITY:	UNIT OF MEASURE:	UNIT PRICE	UNIT PRICE EXTENSION (<i>Quantity times Unit Price</i>)
48	50	Linear Foot	120.00	6,000.00

DESCRIPTION:	<input checked="" type="checkbox"/> Base Bid or <input type="checkbox"/> Alt.# ___ 16" HDPE Pipe (HDD)			
REF. NO.	QUANTITY:	UNIT OF MEASURE:	UNIT PRICE	UNIT PRICE EXTENSION (<i>Quantity times Unit Price</i>)
49	350	Linear Foot	160.00	56,000.00

DESCRIPTION:	<input checked="" type="checkbox"/> Base Bid or <input type="checkbox"/> Alt.# ___ Ductile Iron Fittings (Water)			
REF. NO.	QUANTITY:	UNIT OF MEASURE:	UNIT PRICE	UNIT PRICE EXTENSION (<i>Quantity times Unit Price</i>)
50	8,000	Pound	7.00	56,000.00

TO: City of Mandeville
3101 E. Causeway Approach
Mandeville, LA 70448

(Owner to provide name and address of owner)

BID FOR: 2024 Water & Sewer Maintenance Contract
City of Mandeville Project No.
211.21.003/212.21.003

(Owner to provide name of project and other identifying information)

DESCRIPTION:	<input checked="" type="checkbox"/> Base Bid or <input type="checkbox"/> Alt.# ___ Ductile Iron Fittings (Sewer/Forcemain)			
REF. NO.	QUANTITY:	UNIT OF MEASURE:	UNIT PRICE	UNIT PRICE EXTENSION (<i>Quantity times Unit Price</i>)
51	1,000	Pound	10.00	10,000.00

DESCRIPTION:	<input checked="" type="checkbox"/> Base Bid or <input type="checkbox"/> Alt.# ___ Manhole (depth less than 6 feet)			
REF. NO.	QUANTITY:	UNIT OF MEASURE:	UNIT PRICE	UNIT PRICE EXTENSION (<i>Quantity times Unit Price</i>)
52	5	Each	4,000.00	20,000.00

DESCRIPTION:	<input checked="" type="checkbox"/> Base Bid or <input type="checkbox"/> Alt.# ___ Manhole (depth 6 feet to 10 feet)			
REF. NO.	QUANTITY:	UNIT OF MEASURE:	UNIT PRICE	UNIT PRICE EXTENSION (<i>Quantity times Unit Price</i>)
53	5	Each	5,400.00	27,000.00

DESCRIPTION:	<input checked="" type="checkbox"/> Base Bid or <input type="checkbox"/> Alt.# ___ Manhole (depth 10 feet and greater)			
REF. NO.	QUANTITY:	UNIT OF MEASURE:	UNIT PRICE	UNIT PRICE EXTENSION (<i>Quantity times Unit Price</i>)
54	5	Each	6,900.00	34,500.00

DESCRIPTION:	<input checked="" type="checkbox"/> Base Bid or <input type="checkbox"/> Alt.# ___ Remove & Replace Manhole Cone			
REF. NO.	QUANTITY:	UNIT OF MEASURE:	UNIT PRICE	UNIT PRICE EXTENSION (<i>Quantity times Unit Price</i>)
55	5	Each	1,900.00	9,500.00

DESCRIPTION:	<input checked="" type="checkbox"/> Base Bid or <input type="checkbox"/> Alt.# ___ Adjust Sewer Manhole			
REF. NO.	QUANTITY:	UNIT OF MEASURE:	UNIT PRICE	UNIT PRICE EXTENSION (<i>Quantity times Unit Price</i>)
56	10	Each	900.00	9,000.00

DESCRIPTION:	<input checked="" type="checkbox"/> Base Bid or <input type="checkbox"/> Alt.# ___ Resetting Existing Manhole Rings & Covers			
REF. NO.	QUANTITY:	UNIT OF MEASURE:	UNIT PRICE	UNIT PRICE EXTENSION (<i>Quantity times Unit Price</i>)
57	5	Each	400.00	2,000.00

DESCRIPTION:	<input checked="" type="checkbox"/> Base Bid or <input type="checkbox"/> Alt.# ___ Furnish & Install Manhole Rings & Covers			
REF. NO.	QUANTITY:	UNIT OF MEASURE:	UNIT PRICE	UNIT PRICE EXTENSION (<i>Quantity times Unit Price</i>)
58	5	Each	1,200.00	6,000.00

DESCRIPTION:	<input checked="" type="checkbox"/> Base Bid or <input type="checkbox"/> Alt.# ___ Furnish & Install Manhole Rings & Covers (Bolt Down)			
REF. NO.	QUANTITY:	UNIT OF MEASURE:	UNIT PRICE	UNIT PRICE EXTENSION (<i>Quantity times Unit Price</i>)
59	5	Each	1,800.00	9,000.00

DESCRIPTION:	<input checked="" type="checkbox"/> Base Bid or <input type="checkbox"/> Alt.# ___ Repair Manhole Bench/Trough			
REF. NO.	QUANTITY:	UNIT OF MEASURE:	UNIT PRICE	UNIT PRICE EXTENSION (<i>Quantity times Unit Price</i>)
60	5	Each	550.00	2,750.00

DESCRIPTION:	<input checked="" type="checkbox"/> Base Bid or <input type="checkbox"/> Alt.# ___ Repair Manhole Sewer Connection			
REF. NO.	QUANTITY:	UNIT OF MEASURE:	UNIT PRICE	UNIT PRICE EXTENSION (<i>Quantity times Unit Price</i>)
61	15	Each	1,200.00	18,000.00

DESCRIPTION:	<input checked="" type="checkbox"/> Base Bid or <input type="checkbox"/> Alt.# ___ Manhole Coating (Cementitious)			
REF. NO.	QUANTITY:	UNIT OF MEASURE:	UNIT PRICE	UNIT PRICE EXTENSION (<i>Quantity times Unit Price</i>)
62	3,600	Square Foot	30.00	108,000.00

DESCRIPTION:	<input checked="" type="checkbox"/> Base Bid or <input type="checkbox"/> Alt.# ___ Manhole Coating (100% Solids Epoxy Lining)			
REF. NO.	QUANTITY:	UNIT OF MEASURE:	UNIT PRICE	UNIT PRICE EXTENSION (<i>Quantity times Unit Price</i>)
63	100	Square Foot	45.00	4,500.00

TO: City of Mandeville
3101 E. Causeway Approach
Mandeville, LA 70448

(Owner to provide name and address of owner)

BID FOR: 2024 Water & Sewer Maintenance Contract
City of Mandeville Project No.
211.21.003/212.21.003

(Owner to provide name of project and other identifying information)

DESCRIPTION:	<input checked="" type="checkbox"/> Base Bid or <input type="checkbox"/> Alt.# ___ Sewer Service Connection			
REF. NO.	QUANTITY:	UNIT OF MEASURE:	UNIT PRICE	UNIT PRICE EXTENSION <i>(Quantity times Unit Price)</i>
64	25	Each	3,600.00	90,000.00

DESCRIPTION:	<input checked="" type="checkbox"/> Base Bid or <input type="checkbox"/> Alt.# ___ Sewer Cleanouts			
REF. NO.	QUANTITY:	UNIT OF MEASURE:	UNIT PRICE	UNIT PRICE EXTENSION <i>(Quantity times Unit Price)</i>
65	35	Each	565.00	19,775.00

DESCRIPTION:	<input checked="" type="checkbox"/> Base Bid or <input type="checkbox"/> Alt.# ___ Bypass Pumping			
REF. NO.	QUANTITY:	UNIT OF MEASURE:	UNIT PRICE	UNIT PRICE EXTENSION <i>(Quantity times Unit Price)</i>
66	5	Each	1,400.00	7,000.00

DESCRIPTION:	<input checked="" type="checkbox"/> Base Bid or <input type="checkbox"/> Alt.# ___ 6" Sewer Main Point Repair (depth less than 6 feet)			
REF. NO.	QUANTITY:	UNIT OF MEASURE:	UNIT PRICE	UNIT PRICE EXTENSION <i>(Quantity times Unit Price)</i>
67	10	Each	3,200.00	32,000.00

DESCRIPTION:	<input checked="" type="checkbox"/> Base Bid or <input type="checkbox"/> Alt.# ___ 6" Sewer Main Point Repair (depth 6 feet and greater)			
REF. NO.	QUANTITY:	UNIT OF MEASURE:	UNIT PRICE	UNIT PRICE EXTENSION <i>(Quantity times Unit Price)</i>
68	5	Each	3,900.00	19,500.00

DESCRIPTION:	<input checked="" type="checkbox"/> Base Bid or <input type="checkbox"/> Alt.# ___ 8" Sewer Main Point Repair (depth less than 6 feet)			
REF. NO.	QUANTITY:	UNIT OF MEASURE:	UNIT PRICE	UNIT PRICE EXTENSION <i>(Quantity times Unit Price)</i>
69	20	Each	4,200.00	84,000.00

DESCRIPTION:	<input checked="" type="checkbox"/> Base Bid or <input type="checkbox"/> Alt.# ___ 8" Sewer Main Point Repair (depth 6 feet to 8 feet)			
REF. NO.	QUANTITY:	UNIT OF MEASURE:	UNIT PRICE	UNIT PRICE EXTENSION <i>(Quantity times Unit Price)</i>
70	50	Each	4,400.00	220,000.00

DESCRIPTION:	<input checked="" type="checkbox"/> Base Bid or <input type="checkbox"/> Alt.# ___ 8" Sewer Main Point Repair (depth 8 feet-1 inch to 10 feet)			
REF. NO.	QUANTITY:	UNIT OF MEASURE:	UNIT PRICE	UNIT PRICE EXTENSION <i>(Quantity times Unit Price)</i>
71	10	Each	6,000.00	60,000.00

DESCRIPTION:	<input checked="" type="checkbox"/> Base Bid or <input type="checkbox"/> Alt.# ___ 8" Sewer Main Point Repair (depth 10 feet-1 inch to 12 feet)			
REF. NO.	QUANTITY:	UNIT OF MEASURE:	UNIT PRICE	UNIT PRICE EXTENSION <i>(Quantity times Unit Price)</i>
72	5	Each	6,400.00	32,000.00

DESCRIPTION:	<input checked="" type="checkbox"/> Base Bid or <input type="checkbox"/> Alt.# ___ 8" Sewer Main Point Repair (depth greater than 12 feet-1 inch)			
REF. NO.	QUANTITY:	UNIT OF MEASURE:	UNIT PRICE	UNIT PRICE EXTENSION <i>(Quantity times Unit Price)</i>
73	5	Each	6,800.00	34,000.00

DESCRIPTION:	<input checked="" type="checkbox"/> Base Bid or <input type="checkbox"/> Alt.# ___ 10" Sewer Main Point Repair (depth less than 6 feet)			
REF. NO.	QUANTITY:	UNIT OF MEASURE:	UNIT PRICE	UNIT PRICE EXTENSION <i>(Quantity times Unit Price)</i>
74	5	Each	4,400.00	22,000.00

DESCRIPTION:	<input checked="" type="checkbox"/> Base Bid or <input type="checkbox"/> Alt.# ___ 10" Sewer Main Point Repair (depth 6 feet to 8 feet)			
REF. NO.	QUANTITY:	UNIT OF MEASURE:	UNIT PRICE	UNIT PRICE EXTENSION <i>(Quantity times Unit Price)</i>
75	5	Each	4,680.00	23,400.00

DESCRIPTION:	<input checked="" type="checkbox"/> Base Bid or <input type="checkbox"/> Alt.# ___ 10" Sewer Main Point Repair (depth 8 feet-1 inch to 10 feet)			
REF. NO.	QUANTITY:	UNIT OF MEASURE:	UNIT PRICE	UNIT PRICE EXTENSION <i>(Quantity times Unit Price)</i>
76	5	Each	6,100.00	30,500.00

TO: City of Mandeville
3101 E. Causeway Approach
Mandeville, LA 70448

(Owner to provide name and address of owner)

BID FOR: 2024 Water & Sewer Maintenance Contract
City of Mandeville Project No.
211.21.003/212.21.003

(Owner to provide name of project and other identifying information)

DESCRIPTION:	<input checked="" type="checkbox"/> Base Bid or <input type="checkbox"/> Alt.# ___ 10" Sewer Main Point Repair (depth 10 feet-1 inch to 12 feet)			
REF. NO.	QUANTITY:	UNIT OF MEASURE:	UNIT PRICE	UNIT PRICE EXTENSION (<i>Quantity times Unit Price</i>)
77	5	Each	6,400.00	32,000.00

DESCRIPTION:	<input checked="" type="checkbox"/> Base Bid or <input type="checkbox"/> Alt.# ___ 10" Sewer Main Point Repair (depth greater than 12 feet-1 inch)			
REF. NO.	QUANTITY:	UNIT OF MEASURE:	UNIT PRICE	UNIT PRICE EXTENSION (<i>Quantity times Unit Price</i>)
78	5	Each	7,000.00	35,000.00

DESCRIPTION:	<input checked="" type="checkbox"/> Base Bid or <input type="checkbox"/> Alt.# ___ 12" Sewer Main Point Repair (depth greater than 10 feet)			
REF. NO.	QUANTITY:	UNIT OF MEASURE:	UNIT PRICE	UNIT PRICE EXTENSION (<i>Quantity times Unit Price</i>)
79	5	Each	6,400.00	32,000.00

DESCRIPTION:	<input checked="" type="checkbox"/> Base Bid or <input type="checkbox"/> Alt.# ___ Additional Point Repair for Existing Sewer Main – 6" Diameter (depth less than 6 feet)			
REF. NO.	QUANTITY:	UNIT OF MEASURE:	UNIT PRICE	UNIT PRICE EXTENSION (<i>Quantity times Unit Price</i>)
80	50	Linear Foot	190.00	9,500.00

DESCRIPTION:	<input checked="" type="checkbox"/> Base Bid or <input type="checkbox"/> Alt.# ___ Additional Point Repair for Existing Sewer Main – 8" Diameter (depth less than 6 feet)			
REF. NO.	QUANTITY:	UNIT OF MEASURE:	UNIT PRICE	UNIT PRICE EXTENSION (<i>Quantity times Unit Price</i>)
81	50	Linear Foot	210.00	10,500.00

DESCRIPTION:	<input checked="" type="checkbox"/> Base Bid or <input type="checkbox"/> Alt.# ___ Additional Point Repair for Existing Sewer Main – 8" Diameter (depth 6 feet to 8 feet)			
REF. NO.	QUANTITY:	UNIT OF MEASURE:	UNIT PRICE	UNIT PRICE EXTENSION (<i>Quantity times Unit Price</i>)
82	50	Linear Foot	240.00	12,000.00

DESCRIPTION:	<input checked="" type="checkbox"/> Base Bid or <input type="checkbox"/> Alt.# ___ Additional Point Repair for Existing Sewer Main – 8" Diameter (depth 8 feet-1 inch to 10 feet)			
REF. NO.	QUANTITY:	UNIT OF MEASURE:	UNIT PRICE	UNIT PRICE EXTENSION (<i>Quantity times Unit Price</i>)
83	50	Linear Foot	250.00	12,500.00

DESCRIPTION:	<input checked="" type="checkbox"/> Base Bid or <input type="checkbox"/> Alt.# ___ Additional Point Repair for Existing Sewer Main – 8" Diameter (depth greater than 10 feet)			
REF. NO.	QUANTITY:	UNIT OF MEASURE:	UNIT PRICE	UNIT PRICE EXTENSION (<i>Quantity times Unit Price</i>)
84	50	Linear Foot	300.00	15,000.00

DESCRIPTION:	<input checked="" type="checkbox"/> Base Bid or <input type="checkbox"/> Alt.# ___ Additional Point Repair for Existing Sewer Main – 10" Diameter (depth less than 6 feet)			
REF. NO.	QUANTITY:	UNIT OF MEASURE:	UNIT PRICE	UNIT PRICE EXTENSION (<i>Quantity times Unit Price</i>)
85	50	Linear Foot	220.00	11,000.00

DESCRIPTION:	<input checked="" type="checkbox"/> Base Bid or <input type="checkbox"/> Alt.# ___ Additional Point Repair for Existing Sewer Main – 10" Diameter (depth 6 feet to 8 feet)			
REF. NO.	QUANTITY:	UNIT OF MEASURE:	UNIT PRICE	UNIT PRICE EXTENSION (<i>Quantity times Unit Price</i>)
86	50	Linear Foot	240.00	12,000.00

DESCRIPTION:	<input checked="" type="checkbox"/> Base Bid or <input type="checkbox"/> Alt.# ___ Additional Point Repair for Existing Sewer Main – 10" Diameter (depth 8 feet-1 inch to 10 feet)			
REF. NO.	QUANTITY:	UNIT OF MEASURE:	UNIT PRICE	UNIT PRICE EXTENSION (<i>Quantity times Unit Price</i>)
87	50	Linear Foot	260.00	13,000.00

DESCRIPTION:	<input checked="" type="checkbox"/> Base Bid or <input type="checkbox"/> Alt.# ___ Additional Point Repair for Existing Sewer Main – 10" Diameter (depth greater than 10 feet)			
REF. NO.	QUANTITY:	UNIT OF MEASURE:	UNIT PRICE	UNIT PRICE EXTENSION (<i>Quantity times Unit Price</i>)
88	50	Linear Foot	310.00	15,500.00

DESCRIPTION:	<input checked="" type="checkbox"/> Base Bid or <input type="checkbox"/> Alt.# ___ Additional Point Repair for Existing Sewer Main – 12" Diameter (depth greater than 10 feet)			
REF. NO.	QUANTITY:	UNIT OF MEASURE:	UNIT PRICE	UNIT PRICE EXTENSION (<i>Quantity times Unit Price</i>)
89	50	Linear Foot	330.00	16,500.00

TO: City of Mandeville
3101 E. Causeway Approach
Mandeville, LA 70448

BID FOR: 2024 Water & Sewer Maintenance Contract
City of Mandeville Project No.
211.21.003/212.21.003

(Owner to provide name and address of owner)

(Owner to provide name of project and other identifying information)

DESCRIPTION:	<input checked="" type="checkbox"/> Base Bid or <input type="checkbox"/> Alt.# ___ Clean & Inspect Gravity Sewer for CIPP Liner (6" to 12")			
REF. NO.	QUANTITY:	UNIT OF MEASURE:	UNIT PRICE	UNIT PRICE EXTENSION (Quantity times Unit Price)
90	21,200	Linear Foot	5.00	106,000.00

DESCRIPTION:	<input checked="" type="checkbox"/> Base Bid or <input type="checkbox"/> Alt.# ___ Clean & Inspect Sewer Service Lateral for CIPP Liner (4" to 6")			
REF. NO.	QUANTITY:	UNIT OF MEASURE:	UNIT PRICE	UNIT PRICE EXTENSION (Quantity times Unit Price)
91	500	Each	800.00	400,000.00

DESCRIPTION:	<input checked="" type="checkbox"/> Base Bid or <input type="checkbox"/> Alt.# ___ Root Removal, Gravity Sewer Main			
REF. NO.	QUANTITY:	UNIT OF MEASURE:	UNIT PRICE	UNIT PRICE EXTENSION (Quantity times Unit Price)
92	10	Each	600.00	6,000.00

DESCRIPTION:	<input checked="" type="checkbox"/> Base Bid or <input type="checkbox"/> Alt.# ___ Trim Lateral/Service Connection – Gravity Sewer Main			
REF. NO.	QUANTITY:	UNIT OF MEASURE:	UNIT PRICE	UNIT PRICE EXTENSION (Quantity times Unit Price)
93	10	Each	450.00	4,500.00

DESCRIPTION:	<input checked="" type="checkbox"/> Base Bid or <input type="checkbox"/> Alt.# ___ Mobilization for CIPP in Gravity Sewer Main (Task Orders less than \$75,000.00)			
REF. NO.	QUANTITY:	UNIT OF MEASURE:	UNIT PRICE	UNIT PRICE EXTENSION (Quantity times Unit Price)
94	1	Each	28,000.00	28,000.00

DESCRIPTION:	<input checked="" type="checkbox"/> Base Bid or <input type="checkbox"/> Alt.# ___ Installation of 6.0mm CIPP in 8" Gravity Sewer Main			
REF. NO.	QUANTITY:	UNIT OF MEASURE:	UNIT PRICE	UNIT PRICE EXTENSION (Quantity times Unit Price)
95	20,000	Linear Foot	55.00	1,100,000.00

DESCRIPTION:	<input checked="" type="checkbox"/> Base Bid or <input type="checkbox"/> Alt.# ___ Installation of 6.0mm CIPP in 10" Gravity Sewer Main			
REF. NO.	QUANTITY:	UNIT OF MEASURE:	UNIT PRICE	UNIT PRICE EXTENSION (Quantity times Unit Price)
96	400	Linear Foot	60.00	24,000.00

DESCRIPTION:	<input checked="" type="checkbox"/> Base Bid or <input type="checkbox"/> Alt.# ___ Installation of 6.0mm CIPP in 12" Gravity Sewer Main			
REF. NO.	QUANTITY:	UNIT OF MEASURE:	UNIT PRICE	UNIT PRICE EXTENSION (Quantity times Unit Price)
97	400	Linear Foot	65.00	26,000.00

DESCRIPTION:	<input checked="" type="checkbox"/> Base Bid or <input type="checkbox"/> Alt.# ___ Root Removal, Lateral/Service Connection			
REF. NO.	QUANTITY:	UNIT OF MEASURE:	UNIT PRICE	UNIT PRICE EXTENSION (Quantity times Unit Price)
98	10	Each	600.00	6,000.00

DESCRIPTION:	<input checked="" type="checkbox"/> Base Bid or <input type="checkbox"/> Alt.# ___ Sewer Lateral Point Repair			
REF. NO.	QUANTITY:	UNIT OF MEASURE:	UNIT PRICE	UNIT PRICE EXTENSION (Quantity times Unit Price)
99	15	Each	3,990.00	59,850.00

DESCRIPTION:	<input checked="" type="checkbox"/> Base Bid or <input type="checkbox"/> Alt.# ___ Remove & Replace Sewer Lateral			
REF. NO.	QUANTITY:	UNIT OF MEASURE:	UNIT PRICE	UNIT PRICE EXTENSION (Quantity times Unit Price)
100	500	Linear Foot	165.00	82,500.00

DESCRIPTION:	<input checked="" type="checkbox"/> Base Bid or <input type="checkbox"/> Alt.# ___ Mobilization for CIPP Lateral Rehabilitation (Task Orders less than \$35,000.00)			
REF. NO.	QUANTITY:	UNIT OF MEASURE:	UNIT PRICE	UNIT PRICE EXTENSION (Quantity times Unit Price)
101	1	Each	12,000.00	12,000.00

DESCRIPTION:	<input checked="" type="checkbox"/> Base Bid or <input type="checkbox"/> Alt.# ___ CIPP Lateral Rehabilitation, 6"-8" Mainline Diameter (3' to 5')			
REF. NO.	QUANTITY:	UNIT OF MEASURE:	UNIT PRICE	UNIT PRICE EXTENSION (Quantity times Unit Price)
102	500	Each	3,800.00	1,900,000.00

TO: City of Mandeville
3101 E. Causeway Approach
Mandeville, LA 70448

(Owner to provide name and address of owner)

BID FOR: 2024 Water & Sewer Maintenance Contract
City of Mandeville Project No.
211.21.003/212.21.003

(Owner to provide name of project and other identifying information)

DESCRIPTION:	<input checked="" type="checkbox"/> Base Bid or <input type="checkbox"/> Alt.# ___ CIPP Lateral Rehabilitation, 10" Mainline Diameter (3' to 5')			
REF. NO.	QUANTITY:	UNIT OF MEASURE:	UNIT PRICE	UNIT PRICE EXTENSION (Quantity times Unit Price)
103	10	Each	4,900.00	49,000.00

DESCRIPTION:	<input checked="" type="checkbox"/> Base Bid or <input type="checkbox"/> Alt.# ___ CIPP Lateral Rehabilitation, 12" Mainline Diameter (3' to 5')			
REF. NO.	QUANTITY:	UNIT OF MEASURE:	UNIT PRICE	UNIT PRICE EXTENSION (Quantity times Unit Price)
104	10	Each	5,200.00	52,000.00

DESCRIPTION:	<input checked="" type="checkbox"/> Base Bid or <input type="checkbox"/> Alt.# ___ Additional CIPP Lateral Rehabilitation (beyond 5')			
REF. NO.	QUANTITY:	UNIT OF MEASURE:	UNIT PRICE	UNIT PRICE EXTENSION (Quantity times Unit Price)
105	10,400	Linear Foot	19.00	197,600.00

DESCRIPTION:	<input checked="" type="checkbox"/> Base Bid or <input type="checkbox"/> Alt.# ___ 3" Force Main Point Repair			
REF. NO.	QUANTITY:	UNIT OF MEASURE:	UNIT PRICE	UNIT PRICE EXTENSION (Quantity times Unit Price)
106	5	Each	3,200.00	16,000.00

DESCRIPTION:	<input checked="" type="checkbox"/> Base Bid or <input type="checkbox"/> Alt.# ___ 4" Force Main Point Repair			
REF. NO.	QUANTITY:	UNIT OF MEASURE:	UNIT PRICE	UNIT PRICE EXTENSION (Quantity times Unit Price)
107	5	Each	3,300.00	16,500.00

DESCRIPTION:	<input checked="" type="checkbox"/> Base Bid or <input type="checkbox"/> Alt.# ___ 6" Force Main Point Repair			
REF. NO.	QUANTITY:	UNIT OF MEASURE:	UNIT PRICE	UNIT PRICE EXTENSION (Quantity times Unit Price)
108	5	Each	3,600.00	18,000.00

DESCRIPTION:	<input checked="" type="checkbox"/> Base Bid or <input type="checkbox"/> Alt.# ___ 8" Force Main Point Repair			
REF. NO.	QUANTITY:	UNIT OF MEASURE:	UNIT PRICE	UNIT PRICE EXTENSION (Quantity times Unit Price)
109	5	Each	5,900.00	29,500.00

DESCRIPTION:	<input checked="" type="checkbox"/> Base Bid or <input type="checkbox"/> Alt.# ___ 12" Force Main Point Repair			
REF. NO.	QUANTITY:	UNIT OF MEASURE:	UNIT PRICE	UNIT PRICE EXTENSION (Quantity times Unit Price)
110	5	Each	7,200.00	36,000.00

DESCRIPTION:	<input checked="" type="checkbox"/> Base Bid or <input type="checkbox"/> Alt.# ___ 14" Force Main Point Repair			
REF. NO.	QUANTITY:	UNIT OF MEASURE:	UNIT PRICE	UNIT PRICE EXTENSION (Quantity times Unit Price)
111	5	Each	12,700.00	63,500.00

DESCRIPTION:	<input checked="" type="checkbox"/> Base Bid or <input type="checkbox"/> Alt.# ___ 16" Force Main Point Repair			
REF. NO.	QUANTITY:	UNIT OF MEASURE:	UNIT PRICE	UNIT PRICE EXTENSION (Quantity times Unit Price)
112	5	Each	12,900.00	64,500.00

DESCRIPTION:	<input checked="" type="checkbox"/> Base Bid or <input type="checkbox"/> Alt.# ___ 4" Gate Valve and Valve Box			
REF. NO.	QUANTITY:	UNIT OF MEASURE:	UNIT PRICE	UNIT PRICE EXTENSION (Quantity times Unit Price)
113	4	Each	1,700.00	6,800.00

DESCRIPTION:	<input checked="" type="checkbox"/> Base Bid or <input type="checkbox"/> Alt.# ___ 6" Gate Valve and Valve Box			
REF. NO.	QUANTITY:	UNIT OF MEASURE:	UNIT PRICE	UNIT PRICE EXTENSION (Quantity times Unit Price)
114	10	Each	2,500.00	25,000.00

DESCRIPTION:	<input checked="" type="checkbox"/> Base Bid or <input type="checkbox"/> Alt.# ___ 8" Gate Valve and Valve Box			
REF. NO.	QUANTITY:	UNIT OF MEASURE:	UNIT PRICE	UNIT PRICE EXTENSION (Quantity times Unit Price)
115	10	Each	3,280.00	32,800.00

TO: City of Mandeville
3101 E. Causeway Approach
Mandeville, LA 70448

(Owner to provide name and address of owner)

BID FOR: 2024 Water & Sewer Maintenance Contract
City of Mandeville Project No.
211.21.003/212.21.003

(Owner to provide name of project and other identifying information)

DESCRIPTION:	<input checked="" type="checkbox"/> Base Bid or <input type="checkbox"/> Alt.# ___ 12" Gate Valve and Valve Box			
REF. NO.	QUANTITY:	UNIT OF MEASURE:	UNIT PRICE	UNIT PRICE EXTENSION <i>(Quantity times Unit Price)</i>
116	5	Each	5,600.00	28,000.00

DESCRIPTION:	<input checked="" type="checkbox"/> Base Bid or <input type="checkbox"/> Alt.# ___ 14" Gate Valve and Valve Box			
REF. NO.	QUANTITY:	UNIT OF MEASURE:	UNIT PRICE	UNIT PRICE EXTENSION <i>(Quantity times Unit Price)</i>
117	5	Each	5,900.00	29,500.00

DESCRIPTION:	<input checked="" type="checkbox"/> Base Bid or <input type="checkbox"/> Alt.# ___ 16" Gate Valve and Valve Box			
REF. NO.	QUANTITY:	UNIT OF MEASURE:	UNIT PRICE	UNIT PRICE EXTENSION <i>(Quantity times Unit Price)</i>
118	5	Each	7,800.00	39,000.00

DESCRIPTION:	<input checked="" type="checkbox"/> Base Bid or <input type="checkbox"/> Alt.# ___ 4" Insertion Valve			
REF. NO.	QUANTITY:	UNIT OF MEASURE:	UNIT PRICE	UNIT PRICE EXTENSION <i>(Quantity times Unit Price)</i>
119	5	Each	9,000.00	45,000.00

DESCRIPTION:	<input checked="" type="checkbox"/> Base Bid or <input type="checkbox"/> Alt.# ___ 6" Insertion Valve			
REF. NO.	QUANTITY:	UNIT OF MEASURE:	UNIT PRICE	UNIT PRICE EXTENSION <i>(Quantity times Unit Price)</i>
120	5	Each	12,600.00	63,000.00

DESCRIPTION:	<input checked="" type="checkbox"/> Base Bid or <input type="checkbox"/> Alt.# ___ 8" Insertion Valve			
REF. NO.	QUANTITY:	UNIT OF MEASURE:	UNIT PRICE	UNIT PRICE EXTENSION <i>(Quantity times Unit Price)</i>
121	5	Each	14,000.00	70,000.00

DESCRIPTION:	<input checked="" type="checkbox"/> Base Bid or <input type="checkbox"/> Alt.# ___ 12" Insertion Valve			
REF. NO.	QUANTITY:	UNIT OF MEASURE:	UNIT PRICE	UNIT PRICE EXTENSION <i>(Quantity times Unit Price)</i>
122	5	Each	28,000.00	140,000.00

DESCRIPTION:	<input checked="" type="checkbox"/> Base Bid or <input type="checkbox"/> Alt.# ___ 14" Insertion Valve			
REF. NO.	QUANTITY:	UNIT OF MEASURE:	UNIT PRICE	UNIT PRICE EXTENSION <i>(Quantity times Unit Price)</i>
123	5	Each	48,000.00	240,000.00

DESCRIPTION:	<input checked="" type="checkbox"/> Base Bid or <input type="checkbox"/> Alt.# ___ 16" Insertion Valve			
REF. NO.	QUANTITY:	UNIT OF MEASURE:	UNIT PRICE	UNIT PRICE EXTENSION <i>(Quantity times Unit Price)</i>
124	5	Each	50,000.00	250,000.00

DESCRIPTION:	<input checked="" type="checkbox"/> Base Bid or <input type="checkbox"/> Alt.# ___ 6" Tapping Sleeve & Valve Assembly			
REF. NO.	QUANTITY:	UNIT OF MEASURE:	UNIT PRICE	UNIT PRICE EXTENSION <i>(Quantity times Unit Price)</i>
125	5	Each	5,900.00	29,500.00

DESCRIPTION:	<input checked="" type="checkbox"/> Base Bid or <input type="checkbox"/> Alt.# ___ 8" Tapping Sleeve & Valve Assembly			
REF. NO.	QUANTITY:	UNIT OF MEASURE:	UNIT PRICE	UNIT PRICE EXTENSION <i>(Quantity times Unit Price)</i>
126	5	Each	7,200.00	36,000.00

DESCRIPTION:	<input checked="" type="checkbox"/> Base Bid or <input type="checkbox"/> Alt.# ___ 4" Mechanical Joint Restraints			
REF. NO.	QUANTITY:	UNIT OF MEASURE:	UNIT PRICE	UNIT PRICE EXTENSION <i>(Quantity times Unit Price)</i>
127	5	Each	10.00	50.00

DESCRIPTION:	<input checked="" type="checkbox"/> Base Bid or <input type="checkbox"/> Alt.# ___ 6" Mechanical Joint Restraints			
REF. NO.	QUANTITY:	UNIT OF MEASURE:	UNIT PRICE	UNIT PRICE EXTENSION <i>(Quantity times Unit Price)</i>
128	5	Each	10.00	50.00

TO: City of Mandeville
3101 E. Causeway Approach
Mandeville, LA 70448

(Owner to provide name and address of owner)

BID FOR: 2024 Water & Sewer Maintenance Contract
City of Mandeville Project No.
211.21.003/212.21.003

(Owner to provide name of project and other identifying information)

DESCRIPTION:	<input checked="" type="checkbox"/> Base Bid or <input type="checkbox"/> Alt.# ___ 8" Mechanical Joint Restraints			
REF. NO.	QUANTITY:	UNIT OF MEASURE:	UNIT PRICE	UNIT PRICE EXTENSION (<i>Quantity times Unit Price</i>)
129	5	Each	10.00	50.00

DESCRIPTION:	<input checked="" type="checkbox"/> Base Bid or <input type="checkbox"/> Alt.# ___ 12" Mechanical Joint Restraints			
REF. NO.	QUANTITY:	UNIT OF MEASURE:	UNIT PRICE	UNIT PRICE EXTENSION (<i>Quantity times Unit Price</i>)
130	5	Each	10.00	50.00

DESCRIPTION:	<input checked="" type="checkbox"/> Base Bid or <input type="checkbox"/> Alt.# ___ 14" Mechanical Joint Restraints			
REF. NO.	QUANTITY:	UNIT OF MEASURE:	UNIT PRICE	UNIT PRICE EXTENSION (<i>Quantity times Unit Price</i>)
131	5	Each	10.00	50.00

DESCRIPTION:	<input checked="" type="checkbox"/> Base Bid or <input type="checkbox"/> Alt.# ___ 16" Mechanical Joint Restraints			
REF. NO.	QUANTITY:	UNIT OF MEASURE:	UNIT PRICE	UNIT PRICE EXTENSION (<i>Quantity times Unit Price</i>)
132	5	Each	10.00	50.00

DESCRIPTION:	<input checked="" type="checkbox"/> Base Bid or <input type="checkbox"/> Alt.# ___ 4" Bell Joint Restraints			
REF. NO.	QUANTITY:	UNIT OF MEASURE:	UNIT PRICE	UNIT PRICE EXTENSION (<i>Quantity times Unit Price</i>)
133	5	Each	250.00	1,250.00

DESCRIPTION:	<input checked="" type="checkbox"/> Base Bid or <input type="checkbox"/> Alt.# ___ 6" Bell Joint Restraints			
REF. NO.	QUANTITY:	UNIT OF MEASURE:	UNIT PRICE	UNIT PRICE EXTENSION (<i>Quantity times Unit Price</i>)
134	5	Each	340.00	1,700.00

DESCRIPTION:	<input checked="" type="checkbox"/> Base Bid or <input type="checkbox"/> Alt.# ___ 8" Bell Joint Restraints			
REF. NO.	QUANTITY:	UNIT OF MEASURE:	UNIT PRICE	UNIT PRICE EXTENSION (<i>Quantity times Unit Price</i>)
135	5	Each	440.00	2,200.00

DESCRIPTION:	<input checked="" type="checkbox"/> Base Bid or <input type="checkbox"/> Alt.# ___ 12" Bell Joint Restraints			
REF. NO.	QUANTITY:	UNIT OF MEASURE:	UNIT PRICE	UNIT PRICE EXTENSION (<i>Quantity times Unit Price</i>)
136	5	Each	520.00	2,600.00

DESCRIPTION:	<input checked="" type="checkbox"/> Base Bid or <input type="checkbox"/> Alt.# ___ 14" Bell Joint Restraints			
REF. NO.	QUANTITY:	UNIT OF MEASURE:	UNIT PRICE	UNIT PRICE EXTENSION (<i>Quantity times Unit Price</i>)
137	5	Each	1,050.00	5,250.00

DESCRIPTION:	<input checked="" type="checkbox"/> Base Bid or <input type="checkbox"/> Alt.# ___ 16" Bell Joint Restraints			
REF. NO.	QUANTITY:	UNIT OF MEASURE:	UNIT PRICE	UNIT PRICE EXTENSION (<i>Quantity times Unit Price</i>)
138	5	Each	1,160.00	5,800.00

DESCRIPTION:	<input checked="" type="checkbox"/> Base Bid or <input type="checkbox"/> Alt.# ___ 4" Transitional Couplings			
REF. NO.	QUANTITY:	UNIT OF MEASURE:	UNIT PRICE	UNIT PRICE EXTENSION (<i>Quantity times Unit Price</i>)
139	5	Each	500.00	2,500.00

DESCRIPTION:	<input checked="" type="checkbox"/> Base Bid or <input type="checkbox"/> Alt.# ___ 6" Transitional Couplings			
REF. NO.	QUANTITY:	UNIT OF MEASURE:	UNIT PRICE	UNIT PRICE EXTENSION (<i>Quantity times Unit Price</i>)
140	5	Each	670.00	3,350.00

DESCRIPTION:	<input checked="" type="checkbox"/> Base Bid or <input type="checkbox"/> Alt.# ___ 8" Transitional Couplings			
REF. NO.	QUANTITY:	UNIT OF MEASURE:	UNIT PRICE	UNIT PRICE EXTENSION (<i>Quantity times Unit Price</i>)
141	5	Each	800.00	4,000.00

TO: City of Mandeville
3101 E. Causeway Approach
Mandeville, LA 70448

(Owner to provide name and address of owner)

BID FOR: 2024 Water & Sewer Maintenance Contract
City of Mandeville Project No.
211.21.003/212.21.003

(Owner to provide name of project and other identifying information)

DESCRIPTION:	<input checked="" type="checkbox"/> Base Bid or <input type="checkbox"/> Alt.# ___ Fire Hydrant			
REF. NO.	QUANTITY:	UNIT OF MEASURE:	UNIT PRICE	UNIT PRICE EXTENSION (Quantity times Unit Price)
142	25	Each	6,900.00	172,500.00

DESCRIPTION:	<input checked="" type="checkbox"/> Base Bid or <input type="checkbox"/> Alt.# ___ Fire Hydrant Extension			
REF. NO.	QUANTITY:	UNIT OF MEASURE:	UNIT PRICE	UNIT PRICE EXTENSION (Quantity times Unit Price)
143	20	Vertical Foot	500.00	10,000.00

DESCRIPTION:	<input checked="" type="checkbox"/> Base Bid or <input type="checkbox"/> Alt.# ___ Water Service Line (Open Cut) (1")			
REF. NO.	QUANTITY:	UNIT OF MEASURE:	UNIT PRICE	UNIT PRICE EXTENSION (Quantity times Unit Price)
144	500	Linear Foot	14.00	7,000.00

DESCRIPTION:	<input checked="" type="checkbox"/> Base Bid or <input type="checkbox"/> Alt.# ___ Water Service Line (Open Cut) (2")			
REF. NO.	QUANTITY:	UNIT OF MEASURE:	UNIT PRICE	UNIT PRICE EXTENSION (Quantity times Unit Price)
145	150	Linear Foot	19.00	2,850.00

DESCRIPTION:	<input checked="" type="checkbox"/> Base Bid or <input type="checkbox"/> Alt.# ___ Water Service Line (Directional Drill) (1")			
REF. NO.	QUANTITY:	UNIT OF MEASURE:	UNIT PRICE	UNIT PRICE EXTENSION (Quantity times Unit Price)
146	2000	Linear Foot	18.00	36,000.00

DESCRIPTION:	<input checked="" type="checkbox"/> Base Bid or <input type="checkbox"/> Alt.# ___ Water Service Line (Directional Drill) (2")			
REF. NO.	QUANTITY:	UNIT OF MEASURE:	UNIT PRICE	UNIT PRICE EXTENSION (Quantity times Unit Price)
147	500	Linear Foot	22.00	11,000.00

DESCRIPTION:	<input checked="" type="checkbox"/> Base Bid or <input type="checkbox"/> Alt.# ___ 1" Water Service Connection			
REF. NO.	QUANTITY:	UNIT OF MEASURE:	UNIT PRICE	UNIT PRICE EXTENSION (Quantity times Unit Price)
148	50	Each	800.00	40,000.00

DESCRIPTION:	<input checked="" type="checkbox"/> Base Bid or <input type="checkbox"/> Alt.# ___ 2" Water Service Connection			
REF. NO.	QUANTITY:	UNIT OF MEASURE:	UNIT PRICE	UNIT PRICE EXTENSION (Quantity times Unit Price)
149	15	Each	1,200.00	18,000.00

DESCRIPTION:	<input checked="" type="checkbox"/> Base Bid or <input type="checkbox"/> Alt.# ___ Abandon Existing Pipelines			
REF. NO.	QUANTITY:	UNIT OF MEASURE:	UNIT PRICE	UNIT PRICE EXTENSION (Quantity times Unit Price)
150	5	Each	900.00	4,500.00

DESCRIPTION:	<input checked="" type="checkbox"/> Base Bid or <input type="checkbox"/> Alt.# ___ 4" and Smaller Waterline Point Repair			
REF. NO.	QUANTITY:	UNIT OF MEASURE:	UNIT PRICE	UNIT PRICE EXTENSION (Quantity times Unit Price)
151	5	Each	3,400.00	17,000.00

DESCRIPTION:	<input checked="" type="checkbox"/> Base Bid or <input type="checkbox"/> Alt.# ___ 6" Waterline Point Repair			
REF. NO.	QUANTITY:	UNIT OF MEASURE:	UNIT PRICE	UNIT PRICE EXTENSION (Quantity times Unit Price)
152	10	Each	3,900.00	39,000.00

DESCRIPTION:	<input checked="" type="checkbox"/> Base Bid or <input type="checkbox"/> Alt.# ___ 8" Waterline Point Repair			
REF. NO.	QUANTITY:	UNIT OF MEASURE:	UNIT PRICE	UNIT PRICE EXTENSION (Quantity times Unit Price)
153	15	Each	4,200.00	63,000.00

DESCRIPTION:	<input checked="" type="checkbox"/> Base Bid or <input type="checkbox"/> Alt.# ___ 12" Waterline Point Repair			
REF. NO.	QUANTITY:	UNIT OF MEASURE:	UNIT PRICE	UNIT PRICE EXTENSION (Quantity times Unit Price)
154	5	Each	6,200.00	31,000.00

TO: City of Mandeville
3101 E. Causeway Approach
Mandeville, LA 70448

BID FOR: 2024 Water & Sewer Maintenance Contract
City of Mandeville Project No.
211.21.003/212.21.003

(Owner to provide name and address of owner)

(Owner to provide name of project and other identifying information)

DESCRIPTION:	<input checked="" type="checkbox"/> Base Bid or <input type="checkbox"/> Alt.# ___ 16" Waterline Point Repair			
REF. NO.	QUANTITY:	UNIT OF MEASURE:	UNIT PRICE	UNIT PRICE EXTENSION (Quantity times Unit Price)
155	5	Each	11,800.00	59,000.00

DESCRIPTION:	<input checked="" type="checkbox"/> Base Bid or <input type="checkbox"/> Alt.# ___ Waterline Disinfection			
REF. NO.	QUANTITY:	UNIT OF MEASURE:	UNIT PRICE	UNIT PRICE EXTENSION (Quantity times Unit Price)
156	5	Each	1,500.00	7,500.00

DESCRIPTION:	<input checked="" type="checkbox"/> Base Bid or <input type="checkbox"/> Alt.# ___ 1" Curb Stop			
REF. NO.	QUANTITY:	UNIT OF MEASURE:	UNIT PRICE	UNIT PRICE EXTENSION (Quantity times Unit Price)
157	30	Each	190.00	5,700.00

DESCRIPTION:	<input checked="" type="checkbox"/> Base Bid or <input type="checkbox"/> Alt.# ___ 2" Curb Stop			
REF. NO.	QUANTITY:	UNIT OF MEASURE:	UNIT PRICE	UNIT PRICE EXTENSION (Quantity times Unit Price)
158	10	Each	550.00	5,500.00

DESCRIPTION:	<input checked="" type="checkbox"/> Base Bid or <input type="checkbox"/> Alt.# ___ Meter Box (Iron)			
REF. NO.	QUANTITY:	UNIT OF MEASURE:	UNIT PRICE	UNIT PRICE EXTENSION (Quantity times Unit Price)
159	20	Each	400.00	8,000.00

DESCRIPTION:	<input checked="" type="checkbox"/> Base Bid or <input type="checkbox"/> Alt.# ___ Stone Foundation Material			
REF. NO.	QUANTITY:	UNIT OF MEASURE:	UNIT PRICE	UNIT PRICE EXTENSION (Quantity times Unit Price)
160	50	Cubic Yard	99.00	4,950.00

DESCRIPTION:	<input checked="" type="checkbox"/> Base Bid or <input type="checkbox"/> Alt.# ___ Class II Base Course			
REF. NO.	QUANTITY:	UNIT OF MEASURE:	UNIT PRICE	UNIT PRICE EXTENSION (Quantity times Unit Price)
161	100	Cubic Yard	92.00	9,200.00

DESCRIPTION:	<input checked="" type="checkbox"/> Base Bid or <input type="checkbox"/> Alt.# ___ Manhole Inserts			
REF. NO.	QUANTITY:	UNIT OF MEASURE:	UNIT PRICE	UNIT PRICE EXTENSION (Quantity times Unit Price)
162	100	Each	300.00	30,000.00

DESCRIPTION:	<input checked="" type="checkbox"/> Base Bid or <input type="checkbox"/> Alt.# ___ Topsoil (6" Min.)			
REF. NO.	QUANTITY:	UNIT OF MEASURE:	UNIT PRICE	UNIT PRICE EXTENSION (Quantity times Unit Price)
163	450	Square Yard	45.00	20,250.00

DESCRIPTION:	<input checked="" type="checkbox"/> Base Bid or <input type="checkbox"/> Alt.# ___ Police Detail for Traffic Control			
REF. NO.	QUANTITY:	UNIT OF MEASURE:	UNIT PRICE	UNIT PRICE EXTENSION (Quantity times Unit Price)
164	8	Hour	95.00	760.00

DESCRIPTION:	<input checked="" type="checkbox"/> Base Bid or <input type="checkbox"/> Alt.# ___ Arrow/Message Boards for Traffic Control			
REF. NO.	QUANTITY:	UNIT OF MEASURE:	UNIT PRICE	UNIT PRICE EXTENSION (Quantity times Unit Price)
165	10	Each/Day	500.00	5,000.00

Wordings for "DESCRIPTION" is to be provided by the Owner.
 All quantities are estimated. The contractor will be paid based upon actual quantities as verified by the Owner.

SECTION 00410

BID BOND FORM
FOR

2024 Sewer & Water Maintenance Contract

Date: October 9, 2024

KNOW ALL MEN BY THESE PRESENTS:

That Subterranean Construction, LLC of Mandeville, Louisiana, as Principal, and Arch Insurance Company, as Surety, are held and firmly bound unto the City of Mandeville (Obligee), in the full and just sum of 5% of the price bid, lawful money of the United States, for payment of which sum, well and truly be made, we bind ourselves, our heirs, executors, administrators, successors and assigns, jointly and severally firmly by these presents.

Surety represents that it is listed on the current U. S. Department of the Treasury Financial Management Service list of approved bonding companies as approved for an amount equal to or greater than the amount for which it obligates itself in this instrument or that it is a Louisiana domiciled insurance company with at least an A - rating in the latest printing of the A. M. Best's Key Rating Guide. If surety qualifies by virtue of its Best's listing, the Bond amount may not exceed ten percent of policyholders' surplus as shown in the latest A. M. Best's Key Rating Guide.

Surety further represents that it is licensed to do business in the State of Louisiana and that this Bond is signed by surety's agent or attorney-in-fact. This Bid Bond is accompanied by appropriate power of attorney.

THE CONDITION OF THIS OBLIGATION IS SUCH that, whereas said Principal is herewith submitting its proposal to the Obligee on a Contract for:

2024 Sewer & Water Maintenance Contract
City of Mandeville Project No. 211.21.003/212.21.003

NOW, THEREFORE, if the said Contract be awarded to the Principal and the Principal shall, within such time as may be specified, enter into the Contract in writing and give a good and sufficient bond to secure the performance of the terms and conditions of the Contract with surety acceptable to the Obligee, then this obligation shall be void; otherwise this obligation shall become due and payable.

Subterranean Construction, LLC
PRINCIPAL (BIDDER)

Arch Insurance Company
SURETY

BY: [Signature]
AUTHORIZED OFFICER-OWNER-PARTNER
Evad T. Coltrane - MEMBER

BY: [Signature]
AGENT OR ATTORNEY-IN-FACT (SEAL)
Norma Toups, Attorney-in-Fact

Countersigned: LA Resident Agent
By: [Signature]
Norma Toups, LA Lic 336577

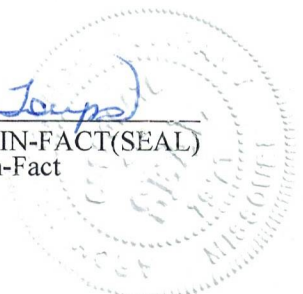

This Power of Attorney limits the acts of those named herein, and they have no authority to bind the Company except in the manner and to the extent herein stated. Not valid for Note, Loan, Letter of Credit, Currency Rate, Interest Rate or Residential Value Guarantees.

POWER OF ATTORNEY

Know All Persons By These Presents:

That the Arch Insurance Company, a corporation organized and existing under the laws of the State of Missouri, having its principal administrative office in Jersey City, New Jersey (hereinafter referred to as the "Company") does hereby appoint:

George Villars Baus, Jr., Greg R. Weston, Jared Viola, Kathleen L. Berni and Norma Toups of Metairie, LA (EACH)

its true and lawful Attorney(s) in-Fact, to make, execute, seal, and deliver from the date of issuance of this power for and on its behalf as surety, and as its act and deed: Any and all bonds, undertakings, recognizances and other surety obligations, in the penal sum not exceeding One Hundred Fifty Million Dollars (\$150,000,000.00). This authority does not permit the same obligation to be split into two or more bonds in order to bring each such bond within the dollar limit of authority as set forth herein.

The execution of such bonds, undertakings, recognizances and other surety obligations in pursuance of these presents shall be as binding upon the said Company as fully and amply to all intents and purposes, as if the same had been duly executed and acknowledged by its regularly elected officers at its principal administrative office in Jersey City, New Jersey.

This Power of Attorney is executed by authority of resolutions adopted by unanimous consent of the Board of Directors of the Company on August 31, 2022, true and accurate copies of which are hereinafter set forth and are hereby certified to by the undersigned Secretary as being in full force and effect:

"VOTED, That the Chairman of the Board, the President, or the Executive Vice President, or any Senior Vice President, of the Surety Business Division, or their appointees designated in writing and filed with the Secretary, or the Secretary shall have the power and authority to appoint agents and attorneys-in-fact, and to authorize them subject to the limitations set forth in their respective powers of attorney, to execute on behalf of the Company, and attach the seal of the Company thereto, bonds, undertakings, recognizances and other surety obligations obligatory in the nature thereof, and any such officers of the Company may appoint agents for acceptance of process."

This Power of Attorney is signed, sealed and certified by facsimile under and by authority of the following resolution adopted by the unanimous consent of the Board of Directors of the Company on August 31, 2022:

VOTED, That the signature of the Chairman of the Board, the President, or the Executive Vice President, or any Senior Vice President, of the Surety Business Division, or their appointees designated in writing and filed with the Secretary, and the signature of the Secretary, the seal of the Company, and certifications by the Secretary, may be affixed by facsimile on any power of attorney or bond executed pursuant to the resolution adopted by the Board of Directors on August 31, 2022, and any such power so executed, sealed and certified with respect to any bond or undertaking to which it is attached, shall continue to be valid and binding upon the Company. In Testimony Whereof, the Company has caused this instrument to be signed and its corporate seal to be affixed by their authorized officers, this 30th day of April, 2024.

Attested and Certified

Regan A. Shulman, Secretary



Arch Insurance Company
Stephen C. Ruschak, Executive Vice President

STATE OF PENNSYLVANIA SS
COUNTY OF PHILADELPHIA SS

I, Michele Tripodi, a Notary Public, do hereby certify that Regan A. Shulman and Stephen C. Ruschak personally known to me to be the same persons whose names are respectively as Secretary and Executive Vice President of the Arch Insurance Company, a Corporation organized and existing under the laws of the State of Missouri, subscribed to the foregoing instrument, appeared before me this day in person and severally acknowledged that they being thereto duly authorized signed, sealed with the corporate seal and delivered the said instrument as the free and voluntary act of said corporation and as their own free and voluntary acts for the uses and purposes therein set forth.

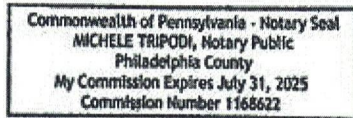

Michele Tripodi, Notary Public
My commission expires 07/31/2025

CERTIFICATION

I, Regan A. Shulman, Secretary of the Arch Insurance Company, do hereby certify that the attached Power of Attorney dated April 30, 2024 on behalf of the person(s) as listed above is a true and correct copy and that the same has been in full force and effect since the date thereof and is in full force and effect on the date of this certificate; and I do further certify that the said Stephen C. Ruschak, who executed the Power of Attorney as Executive Vice President, was on the date of execution of the attached Power of Attorney the duly elected Executive Vice President of the Arch Insurance Company.

IN TESTIMONY WHEREOF, I have hereunto subscribed my name and affixed the corporate seal of the Arch Insurance Company on this 9th day of October, 20 24.

Regan A. Shulman, Secretary

This Power of Attorney limits the acts of those named therein to the bonds and undertakings specifically named therein and they have no authority to bind the Company except in the manner and to the extent herein stated.

PLEASE SEND ALL CLAIM INQUIRIES RELATING TO THIS BOND TO THE FOLLOWING ADDRESS:

Arch Insurance - Surety Division
3 Parkway, Suite 1500
Philadelphia, PA 19102



To verify the authenticity of this Power of Attorney, please contact Arch Insurance Company at SuretyAuthentic@archinsurance.com
Please refer to the above named Attorney-in-Fact and the details of the bond to which the power is attached.

SECTION 00485

CORPORATE RESOLUTION

EXCERPT FROM MINUTES OF MEETING OF THE BOARD OF DIRECTORS OF
Subterranean Construction, LLC

INCORPORATED.

AT THE MEETING OF DIRECTORS OF Subterranean Construction, LLC
INCORPORATED, DULY NOTICED AND HELD ON 7/1/1998,
A QUORUM BEING THERE PRESENT, ON MOTION DULY MADE AND SECONDED. IT WAS:

RESOLVED. THAT Evan T. Conravey, BE AND IS HEREBY
APPOINTED, CONSTITUTED AND DESIGNATED AS AGENT AND ATTORNEY-IN-FACT OF
THE CORPORATION WITH FULL POWER AND AUTHORITY TO ACT ON BEHALF OF THIS
CORPORATION IN ALL NEGOTIATIONS, BIDDING, CONCERNS AND TRANSACTIONS WITH
THE CITY OF MANDEVILLE OR ANY OF ITS AGENCIES, DEPARTMENTS, EMPLOYEES OR
AGENTS, INCLUDING BUT NOT LIMITED TO, THE EXECUTION OF ALL BIDS, PAPERS,
DOCUMENTS, AFFIDAVITS, BONDS, SURETIES, CONTRACTS AND ACTS AND TO RECEIVE
AND RECEIPT THEREFOR ALL PURCHASE ORDERS AND NOTICES ISSUED PURSUANT TO
THE PROVISIONS OF ANY SUCH BID OR CONTRACT, THIS CORPORATION HEREBY
RATIFYING, APPROVING, CONFIRMING, AND ACCEPTING EACH AND EVERY SUCH ACT
PERFORMED BY SAID AGENT AND ATTORNEY-IN-FACT.

I HEREBY CERTIFY THE FOREGOING TO BE A TRUE
AND CORRECT COPY OF AN EXCERPT OF THE MINUTES
OF THE ABOVE DATED MEETING OF THE BOARD OF
DIRECTORS OF SAID CORPORATION, AND THE SAME
HAS NOT BEEN REVOKED OR RESCINDED.



SECRETARY-TREASURER Deanne D Conravey - Member

October 9, 2024

DATE